

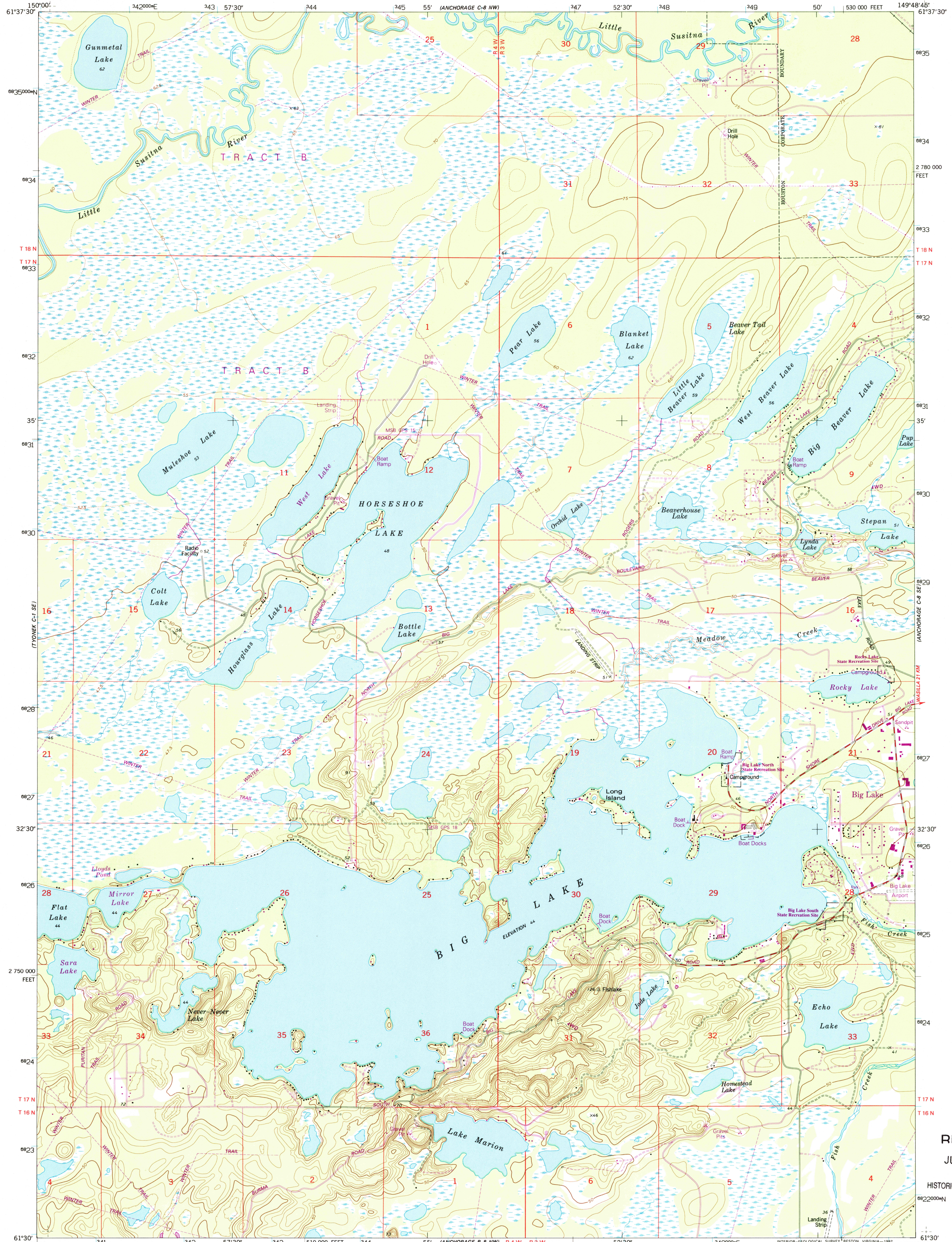

U.S. DEPARTMENT OF THE INTERIOR
U.S. GEOLOGICAL SURVEY

ANCHORAGE (C-8) SW QUADRANGLE
ALASKA-MATANUSKA-SUSITNA BOROUGH
1:25 000-SCALE SERIES (TOPOGRAPHIC)
SW/4 ANCHORAGE (C-8) 1:63 360 SCALE QUADRANGLE



Produced by the United States Geological Survey
Control by USGS and NOS/NOAA
Compiled from aerial photographs taken 1972. Revisions shown in purple and woodland compiled from aerial photographs taken 1988 and 1990 and other sources and have been field checked.
Map edited 1993. Conflicts may exist between some updated features and previously mapped contours.
North American Datum of 1927 (NAD 27). Projection and blue 1000-meter ticks: Universal Transverse Mercator, zone 6 100000-foot ticks: Alaska Coordinate System, zone 4
North American Datum of 1983 (NAD 83) is shown by dashed corner ticks. The values of the shift between NAD 27 and NAD 83 for 7.5-minute intersections are given in USGS Bulletin 1875.
There may be private inholdings within the boundaries of the National or State reservations shown on this map.
Land lines are omitted in areas of extensive tract surveys.
Swamps, as portrayed, indicate only wetter areas, usually of low relief, as interpreted from aerial photographs.

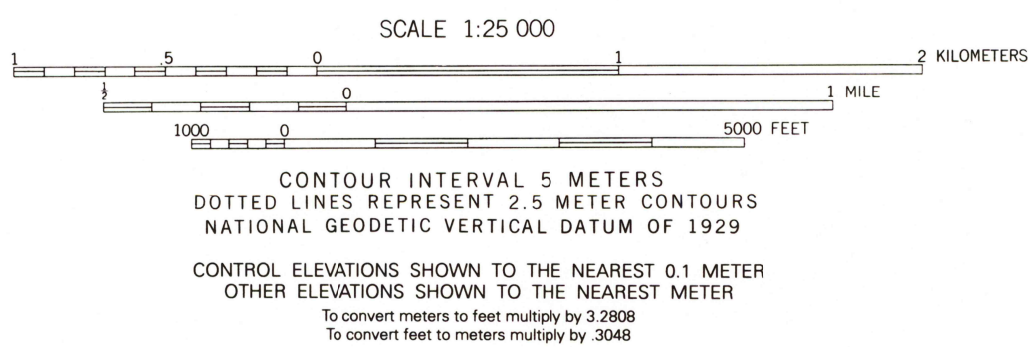
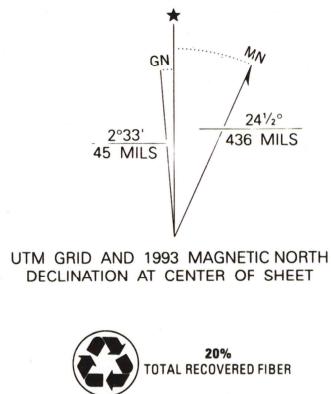

ROAD CLASSIFICATION	
Primary highway, hard surface	Light-duty road, hard or improved surface
Secondary highway, hard surface	Unimproved road
	State Route

ANCHORAGE (C-8) SW, ALASKA
SW/4 ANCHORAGE (C-8) 1:63 360 SCALE QUADRANGLE
61149-E7-TM-025

1979
REVISED 1993

RECEIVED
JUN 3 0 2002
USGS/NOAA
HISTORICAL MAP ARCHIVES

