

MAPPED, EDITED, AND PUBLISHED BY THE GEOLOGICAL SURVEY

CONTROL BY USGS, USACGS AND INTERNATIONAL BOUNDARY COMMISSION

COMPILED IN 1960 FROM U.S. GEOLOGICAL SURVEY 1:63,360 SERIES MAPS,
SURVEYED 1956, MAP NOT FIELD CHECKED

UNIVERSAL TRANSVERSE MERCATOR PROJECTION, 1927 NORTH AMERICAN DATUM
100,000-FOOT GRID BASED ON ALASKA COORDINATE SYSTEM, ZONE 2
10,000-METER UNIVERSAL TRANSVERSE MERCATOR GRID TICKS,
ZONE 7, SHOWN IN BLUE

LAND LINES REPRESENT UNSURVEYED AND UNMARKED LOCATIONS
PREDETERMINED BY THE BUREAU OF LAND MANAGEMENT
FOLIO F-8, FAIRBANKS MERIDIAN

SWAMPS AS PORTRAYED, INDICATE ONLY THE WETTER AREAS,
USUALLY OF LOW RELIEF, AS INTERPRETED FROM AERIAL PHOTOGRAPHS

SCALE 1:250,000

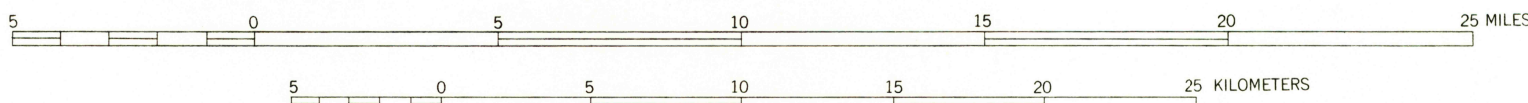

CONTOUR INTERVAL 200 FEET
DATUM IS MEAN SEA LEVEL

1956 MAGNETIC DECLINATION AT SOUTH EDGE OF SHEET VARIES FROM 30°30' TO 33° EAST
THIS MAP IS AVAILABLE IN BOTH SHADED RELIEF AND CONTOUR EDITIONS

FOR SALE BY U.S. GEOLOGICAL SURVEY
FAIRBANKS, ALASKA, 99701, DENVER, COLORADO, 80225, OR WASHINGTON, D.C. 20242
A FOLDER DESCRIBING TOPOGRAPHIC MAPS AND SYMBOLS IS AVAILABLE ON REQUEST

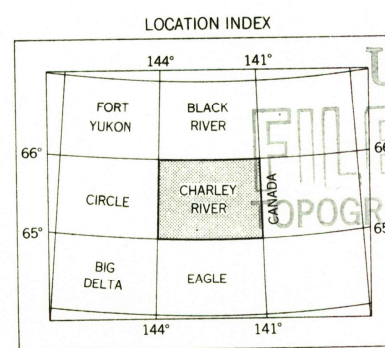

ROAD CLASSIFICATION

LIGHT DUTY UNIMPROVED DIRT

CHARLEY RIVER, ALASKA

N6500-W4100/60X180

1956

MINOR REVISIONS 1966

RETURN TO:
NND HISTORICAL MAP ARCHIVES
USGS NATIONAL CENTER, MS-522
RESTON, VA 22092