

CONTROLLED RECONNAISSANCE
690-S-1-E/2

CORPS OF ENGINEERS, U. S. ARMY
TACTICAL MAP

Foley
ALABAMA
BON SECOUR QUADRANGLE
GRID ZONE "C"



Field work and compilation under the direction of Colonel W. M. Black, Corps of Engineers, U. S. Army, Chief Engineer Officer, Eastern Department.
Base map compiled from U. S. C. & G. S. Chart No. 187 and other available data.
Field work by 2nd Lieut. S. S. Winslow, C. A. C., U. S. A., Nov. 1911-June 1912.
Soundings expressed in feet and referred to mean low water are from U. S. C. & G. S. Chart No. 187.
Mean range of tide 1.2 feet.

FILE COPY
Map Information Office

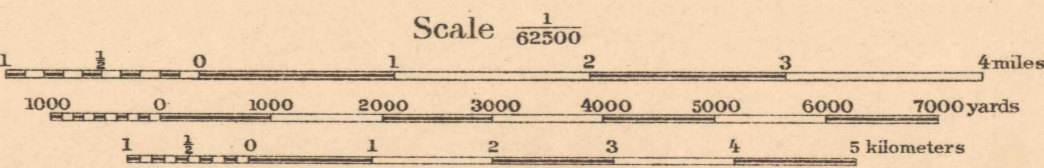

Contour Interval 10 feet
Datum is mean sea level

FIVE THOUSAND YARD GRID COMPUTED FROM "GRID SYSTEM FOR PROGRESSIVE MAPS IN THE U. S." ZONE C. U. S. C. & G. S. SPECIAL PUBLICATION NO. 59. (THE LAST THREE DIGITS OF THE GRID NUMBERS ARE OMITTED)

NOTE: OFFICERS USING THIS MAP WILL MARK HEREON CORRECTIONS AND ADDITIONS WHICH COME TO THEIR ATTENTION AND MAIL DIRECT TO THE CHIEF OF ENGINEERS, WASHINGTON, D. C.

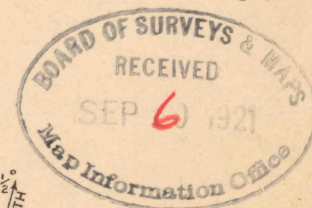
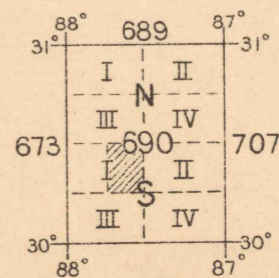

Board of Surveys & Maps
FILE COPY
Map Information Office

BON SECOUR
FOLEY, ALA.