

UNITED STATES
DEPARTMENT OF THE INTERIOR
GEOLOGICAL SURVEY

TRUMANN QUADRANGLE
ARKANSAS
7.5 MINUTE SERIES (TOPOGRAPHIC)

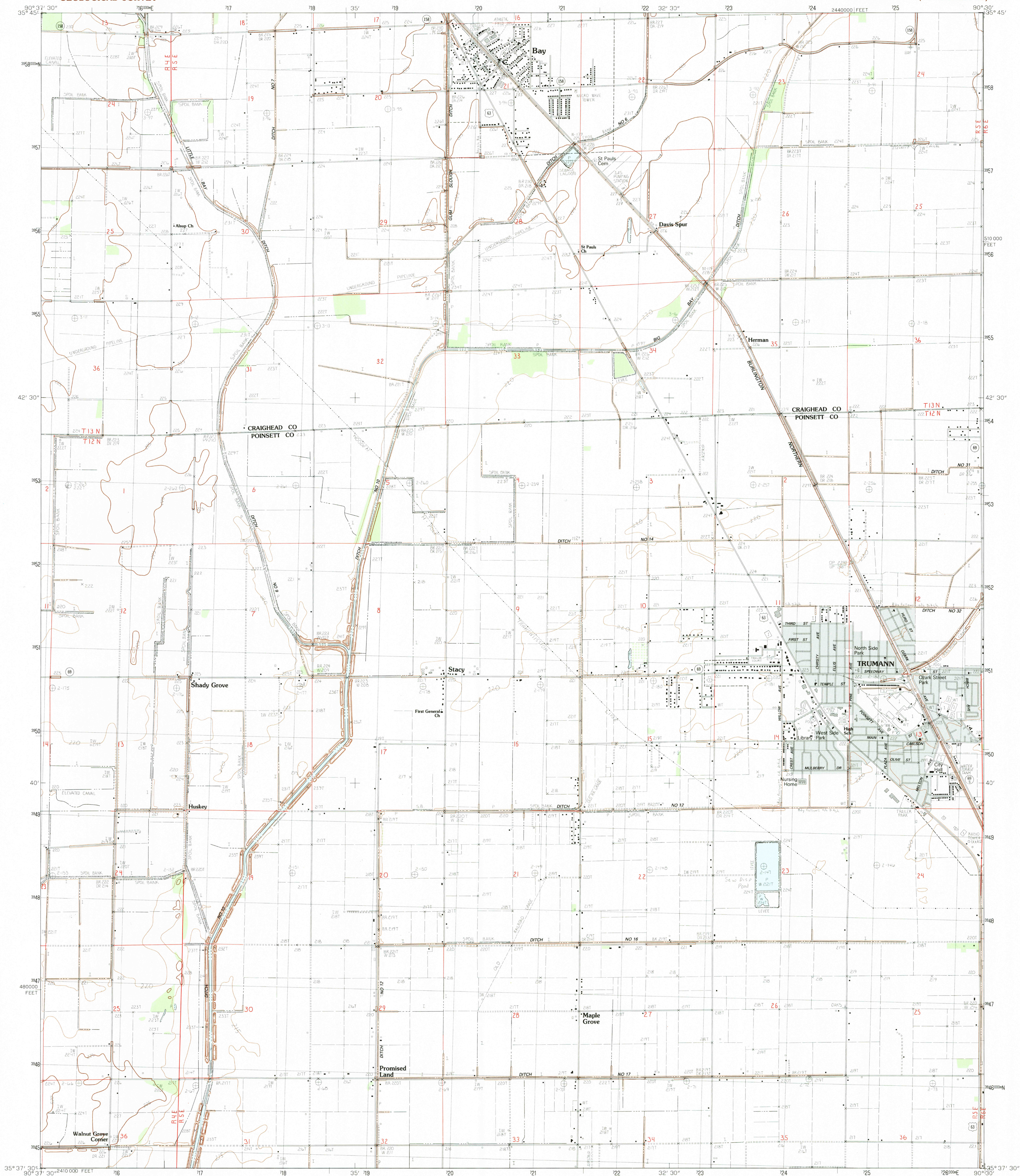

PRODUCED BY THE UNITED STATES GEOLOGICAL SURVEY
CONTROL BY USGS AND NOS/NOAA
COMPILED FROM AERIAL PHOTOGRAPHS TAKEN 1976
FIELD CHECKED 1979. MAP EDITED 1983
PROJECTION LAMBERT CONFORMAL CONIC
GRID: 1000-METER UNIVERSAL TRANSVERSE MERCATOR ZONE 15
1000-FOOT STATE GRID TICKS NORTH ZONE
UTM GRID DECLINATION 1°25' EAST
1983 MAGNETIC NORTH DECLINATION 3°36' EAST
VERTICAL DATUM NATIONAL GEODIC VERTICAL DATUM OF 1929
HORIZONTAL DATUM 1927 NORTH AMERICAN DATUM
To place on the predicted North American Datum of 1983
move the projection lines as shown by dashed corner ticks
(6 meters south and 10 meters east)
There may be private inholdings within the boundaries of any
Federal and State reservations shown on this map
Gray tint indicates area in which selected buildings are shown

PROVISIONAL MAP
Produced from original
manuscript drawings. Informa-
tion shown as of date of
field check.

3

SCALE 1:24 000

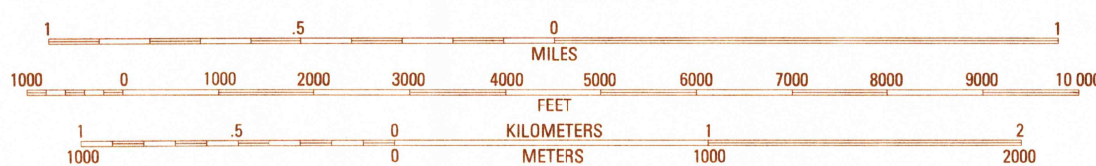

CONTOUR INTERVAL 5 FEET

To convert feet to meters multiply by .3048
To convert meters to feet multiply by 3.2808

RETURN TO:
MND HISTORICAL MAP ARCHIVES
USGS NATIONAL CENTER, MS-522
RESTON, VA 22092

THIS MAP COMPLIES WITH NATIONAL MAP ACCURACY STANDARDS
FOR SALE BY U. S. GEOLOGICAL SURVEY, DENVER, COLORADO 80225, OR RESTON, VIRGINIA 22092
AND ARKANSAS GEOLOGICAL COMMISSION, LITTLE ROCK, ARKANSAS 72204



QUADRANGLE LOCATION

1	2	3	1 Jonesboro
			2 Needham
			3 Lake City
4	5		4 Greenfield
			5 Hatchie Coon
			6 Harrisburg
6	7	8	7 McCormick
			8 Marked Tree

ADJOINING 7.5 QUADRANGLE NAMES

ROAD LEGEND

Improved Road
Unimproved Road
Trail
Interstate Route U. S. Route State Route

TRUMANN, ARKANSAS
PROVISIONAL EDITION 1983

35090-F5-TF-024