



Produced by the United States Geological Survey

Control by USGS and NOS/NOAA

Topography by photogrammetric methods from aerial photographs taken 1960. Field checked 1963. Revised from aerial photographs taken 1989-90. Field checked 1993. Map edited 1994

Universal Transverse Mercator projection
10,000-foot grid ticks: Arkansas coordinate system, north and south zones
1000-meter Universal Transverse Mercator grid ticks, zone 15, shown in blue
1927 North American Datum (NAD 27)

North American Datum of 1983 (NAD 83) is shown by dashed corner ticks
The values of the shift between NAD 27 and 83 for 7.5-minute
intersections are given in USGS Bulletin 1875

Fine red dashed lines indicate selected fence and field lines where
generally visible on aerial photographs. This information is unchecked

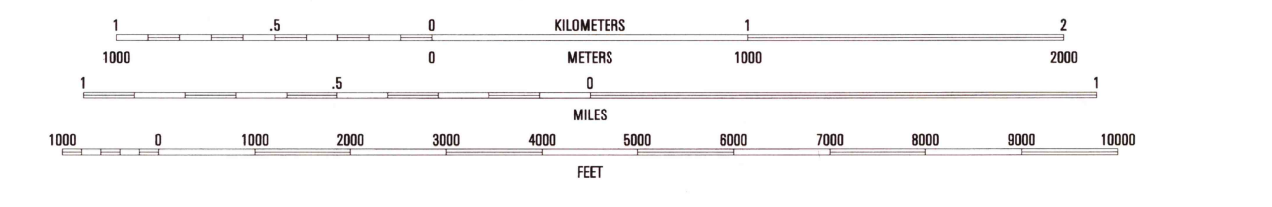
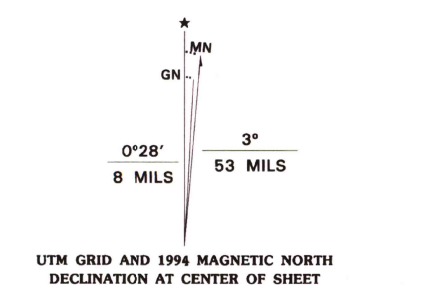

CONTOUR INTERVAL 20 FEET
SUPPLEMENTARY CONTOUR INTERVAL 10 FEET
NATIONAL GEODETIC VERTICAL DATUM OF 1929

THIS MAP COMPLIES WITH NATIONAL MAP ACCURACY STANDARDS
FOR SALE BY U.S. GEOLOGICAL SURVEY, DENVER, COLORADO 80225, OR RESTON, VIRGINIA 22092
AND ARKANSAS GEOLOGICAL COMMISSION, LITTLE ROCK, ARKANSAS 72204
A FOLDER DESCRIBING TOPOGRAPHIC MAPS AND SYMBOLS IS AVAILABLE ON REQUEST

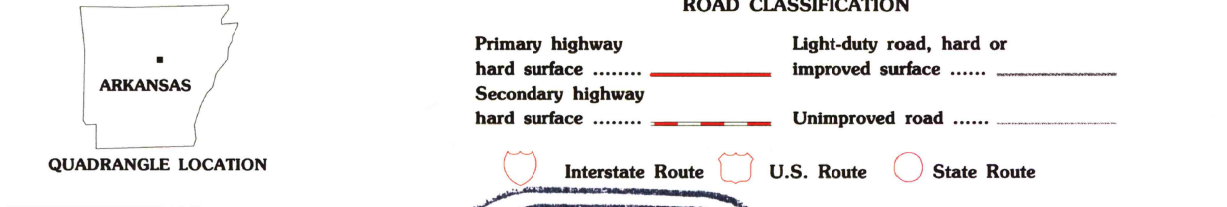

1	2	3	1 Holland
2	3	4	2 Enola
3	4	5	3 Mount Vernon
4	5	6	4 Hamlet
5	6	7	5 Mountata Springs
6	7	8	6 Cato
			7 Olmstead
			8 Cabot

ADJOINING 7.5' QUADRANGLE NAMES

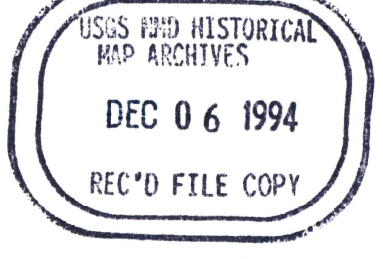

VILONIA, ARK.
35092-A2-TF-024
1994
DMA 7554 II SW - SERIES V884