

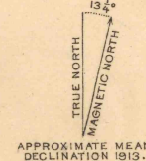

R.B. Marshall, Chief Geographer.
Geo. R. Davis, Geographer in charge.
Topography by H.H. Hodgson and L.H. Williams.
Southwest quarter reduced from Clifton sheet.
Control by R.H. Chapman, Chester Irvine, and R.R. Monbeck.
Surveyed in 1900-1901 and 1912-1913.

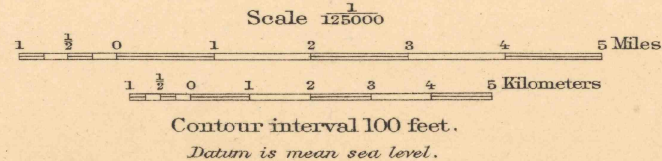
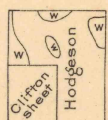

Edition of Mar. 1915.

MORENCI