

UNITED STATES
DEPARTMENT OF THE INTERIOR
GEOLOGICAL SURVEY

ANTELOPE PEAK NE QUADRANGLE
ARIZONA-PINAL CO.
7.5 MINUTE SERIES (TOPOGRAPHIC)
NE/4 ANTELOPE PEAK 15' QUADRANGLE

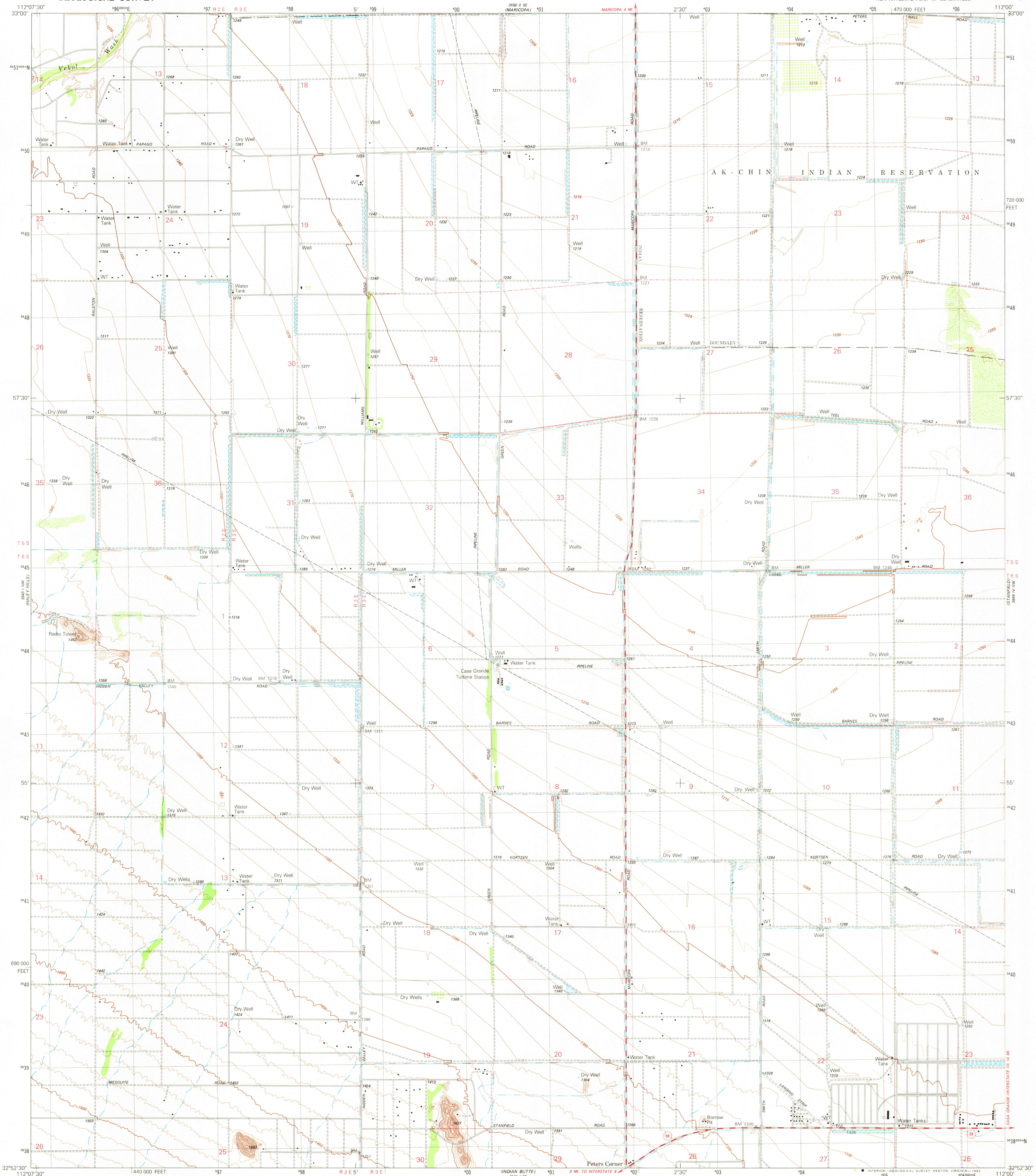

Mapped, edited, and published by the Geological Survey
Control by USGS and NOS/NOAA

Topography by photogrammetric methods from aerial
photographs taken 1976. Field checked 1977
Map edited 1981

Projection and 10,000-foot grid ticks: Arizona coordinate
system, central zone (transverse Mercator)
1000-meter Universal Transverse Mercator grid, zone 12
1927 North American Datum

To place on the predicted North American Datum 1983
move the projection lines 3 meters south and
64 meters east as shown by dashed corner ticks

This map lies within a subsidence area
Vertical control based on latest available adjustment

There may be private inholdings within the boundaries of
the National or State reservations shown on this map

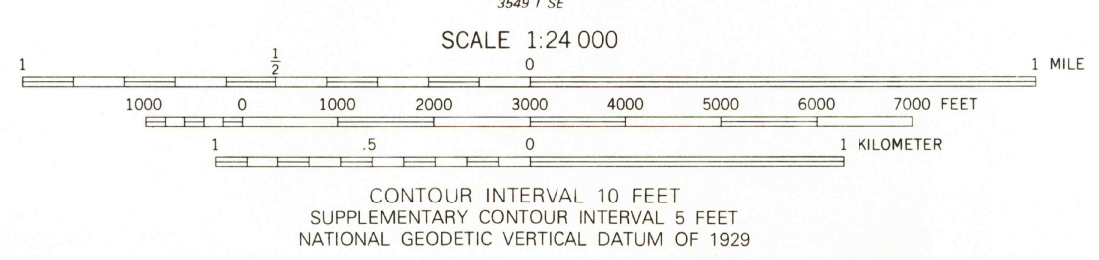
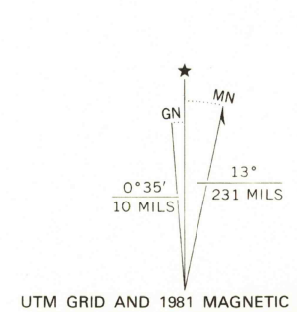

ROAD CLASSIFICATION
Primary highway, hard surface
Secondary highway, hard surface
Unimproved road
Interstate Route
U.S. Route
State Route

ANTELOPE PEAK NE, ARIZ.
NE/4 ANTELOPE PEAK 15' QUADRANGLE
N3252.5-W11200.7.5

1981

DMA 3549 I NE-SERIES V898