

UNITED STATES
DEPARTMENT OF THE INTERIOR
GEOLOGICAL SURVEY

ANTELOPE PEAK NE QUADRANGLE
ARIZONA-PINAL CO.
7.5 MINUTE SERIES (TOPOGRAPHIC)
NE/4 ANTELOPE PEAK 15' QUADRANGLE

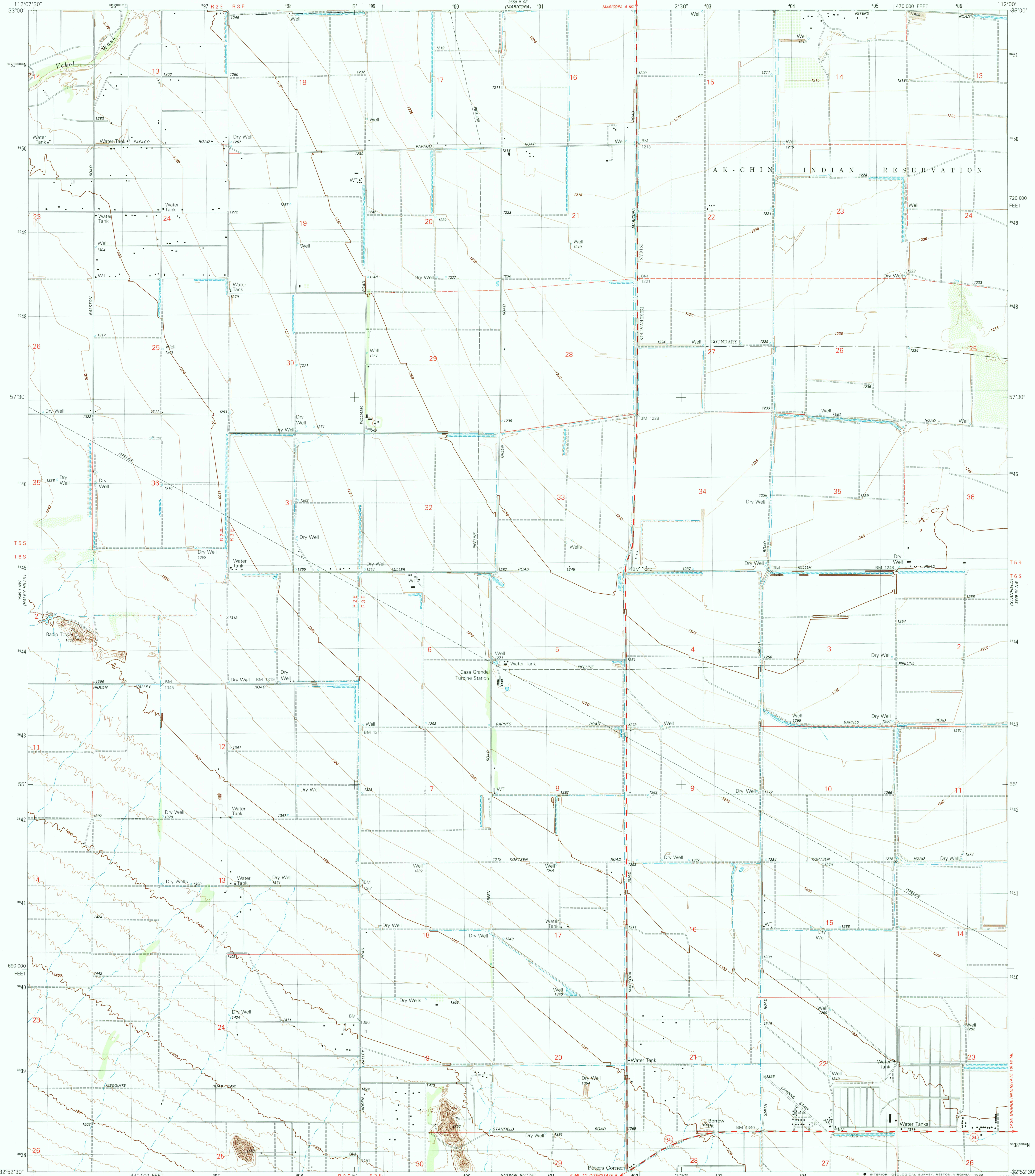

Mapped, edited, and published by the Geological Survey

Control by USGS and NOS/NOAA

Topography by photogrammetric methods from aerial photographs taken 1976. Field checked 1977. Map edited 1981

Projection and 10,000-foot grid ticks: Arizona coordinate system, central zone (transverse Mercator)

1000-meter Universal Transverse Mercator grid, zone 12

1927 North American Datum

The difference between 1927 North American Datum and North American Datum of 1983 (NAD 83) for 7.5 minute intersections is given in USGS Bulletin 1875. The NAD 83 is shown by dashed corner ticks

This map lies within a subsidence area

Vertical control based on latest available adjustment

There may be private inholdings within the boundaries of the National or State reservations shown on this map

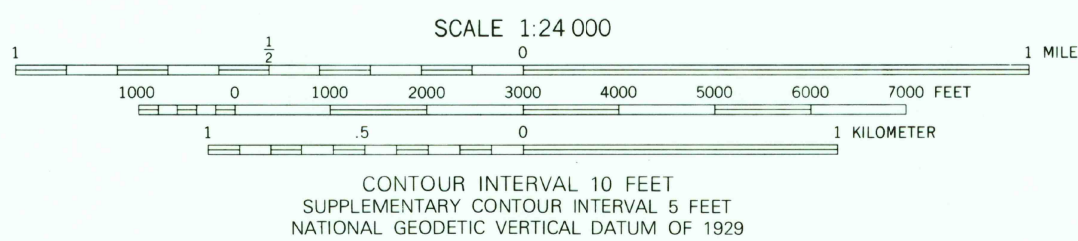
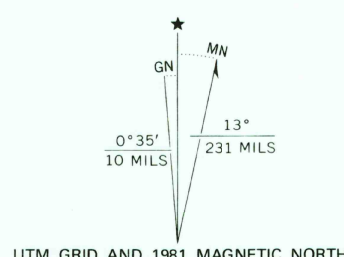

THIS MAP COMPLIES WITH NATIONAL MAP ACCURACY STANDARDS.
FOR SALE BY U. S. GEOLOGICAL SURVEY, DENVER, COLORADO 80225, OR RESTON, VIRGINIA 22092
A FOLDER DESCRIBING TOPOGRAPHIC MAPS AND SYMBOLS IS AVAILABLE ON REQUEST



ROAD CLASSIFICATION	
Primary highway, hard surface	Light-duty road, hard or improved surface
Secondary highway, hard surface	Unimproved road
Interstate Route	U. S. Route
	State Route

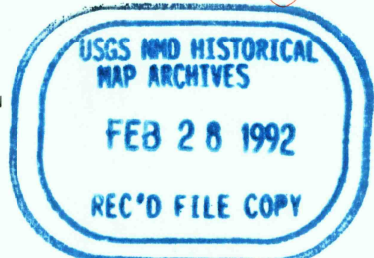

ANTELOPE PEAK NE, ARIZ.
NE/4 ANTELOPE PEAK 15' QUADRANGLE
32112H1-TF-024

1981

DMA 3549 1 NE--SERIES V898