

UNITED STATES
DEPARTMENT OF THE INTERIOR
GEOLOGICAL SURVEY

CONLEY WELL QUADRANGLE
ARIZONA-MARICOPA CO
7.5 MINUTE SERIES (TOPOGRAPHIC)
NE 1/4 ESTRELLA 15' QUADRANGLE

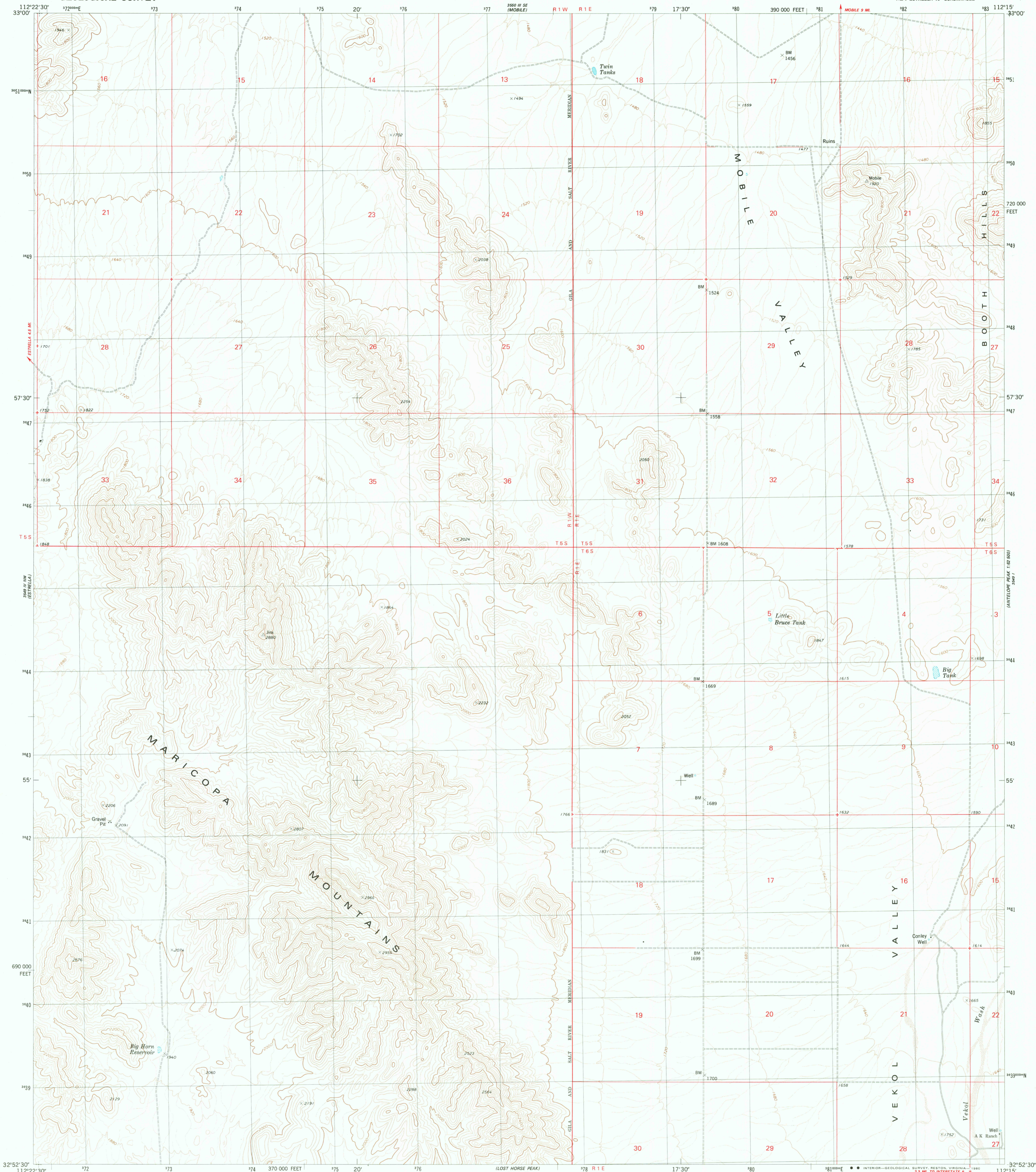

Mapped, edited, and published by the Geological Survey
Control by USGS and NOS/NOAA
Topography by photogrammetric methods from aerial photographs taken 1973. Field checked 1977. Map edited 1979
Projection and 10,000-foot grid ticks: Arizona coordinate system, central zone (transverse Mercator)
1000-meter Universal Transverse Mercator grid, zone 12 1927 North American Datum
To place on the predicted North American Datum 1983 move the projection lines 3 meters south and 65 meters east as shown by dashed corner ticks
Where omitted, land lines have not been established

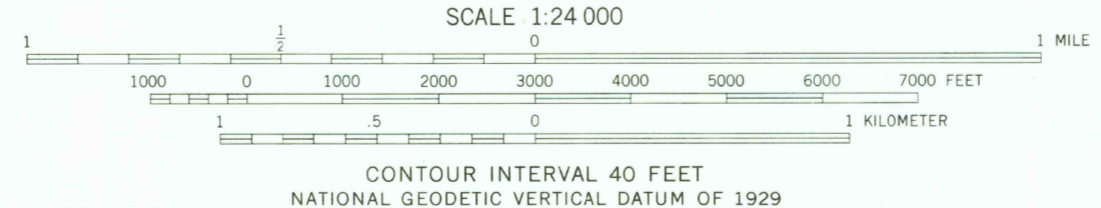
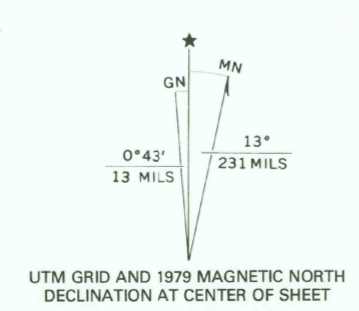

ROAD CLASSIFICATION
Primary highway, hard surface
Secondary highway, hard surface
Light-duty road, hard or improved surface
Unimproved road
Interstate Route
U. S. Route
State Route

THIS MAP COMPLIES WITH NATIONAL MAP ACCURACY STANDARDS
FOR SALE BY U. S. GEOLOGICAL SURVEY, DENVER, COLORADO 80225, OR RESTON, VIRGINIA 22092
A FOLDER DESCRIBING TOPOGRAPHIC MAPS AND SYMBOLS IS AVAILABLE ON REQUEST

USGS
Historical File
Topographic Division

JUN - 5 1980
CONLEY WELL, ARIZ.
NE 1/4 ESTRELLA 15' QUADRANGLE
N3252.5-W11215/7.5
1979
DMA 3549 IV NE-SERIES V898

2000