

UNITED STATES
DEPARTMENT OF THE INTERIOR
GEOLOGICAL SURVEY

DOUBLE ADOBE QUADRANGLE
ARIZONA-COCHISE CO.
7.5 MINUTE SERIES (TOPOGRAPHIC)
NW/4 DOUGLAS 15' QUADRANGLE

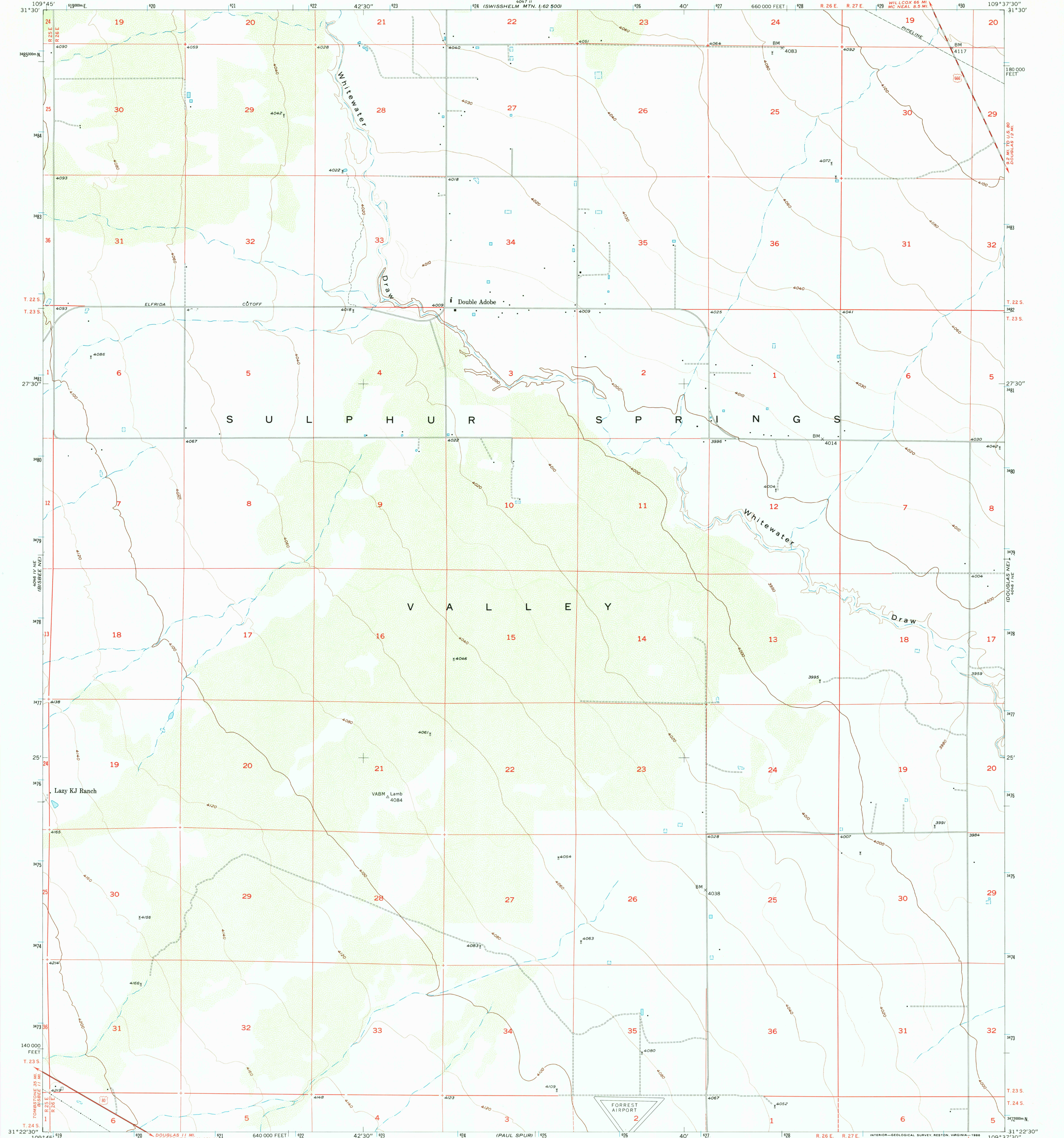

Mapped, edited, and published by the Geological Survey
Control by USGS and USC&GS
Topography from aerial photographs by ER-55 plotter
and by planetable surveys 1958
Aerial photographs taken 1956
Polyconic projection. 1927 North American datum
10,000-foot grid based on Arizona coordinate system,
east zone
1000-meter Universal Transverse Mercator grid ticks,
zone 12, shown in blue
To place on the predicted North American Datum 1983
move the projection lines 10 meters south and
59 meters east as shown by dashed corner ticks
Dashed land lines indicate approximate locations

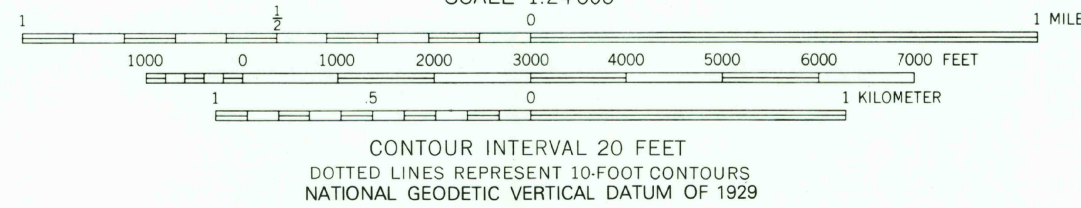
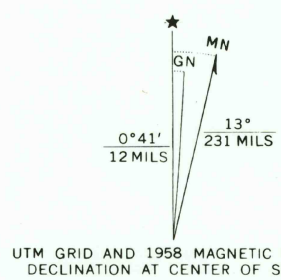

THIS MAP COMPLIES WITH NATIONAL MAP ACCURACY STANDARDS
FOR SALE BY U. S. GEOLOGICAL SURVEY, DENVER, COLORADO 80225, OR RESTON, VIRGINIA 22092
A FOLDER DESCRIBING TOPOGRAPHIC MAPS AND SYMBOLS IS AVAILABLE ON REQUEST

Map photoinspected 1976
No major culture or drainage changes observed



ROAD CLASSIFICATION
Heavy-duty ————— Light-duty —————
Medium-duty ————— Unimproved dirt —————
U. S. Route

DOUBLE ADOBE, ARIZ.
NW/4 DOUGLAS 15' QUADRANGLE
31109-D6-TF-024
1958
PHOTOINSPECTED 1976
DMA 4046 I NW-SERIES V898