

UNITED STATES
DEPARTMENT OF THE INTERIOR
GEOLOGICAL SURVEY

DOUBLE PEAK QUADRANGLE
ARIZONA-PINAL CO.
7.5 MINUTE SERIES (TOPOGRAPHIC)
SW/4 CASA GRANDE 15' QUADRANGLE

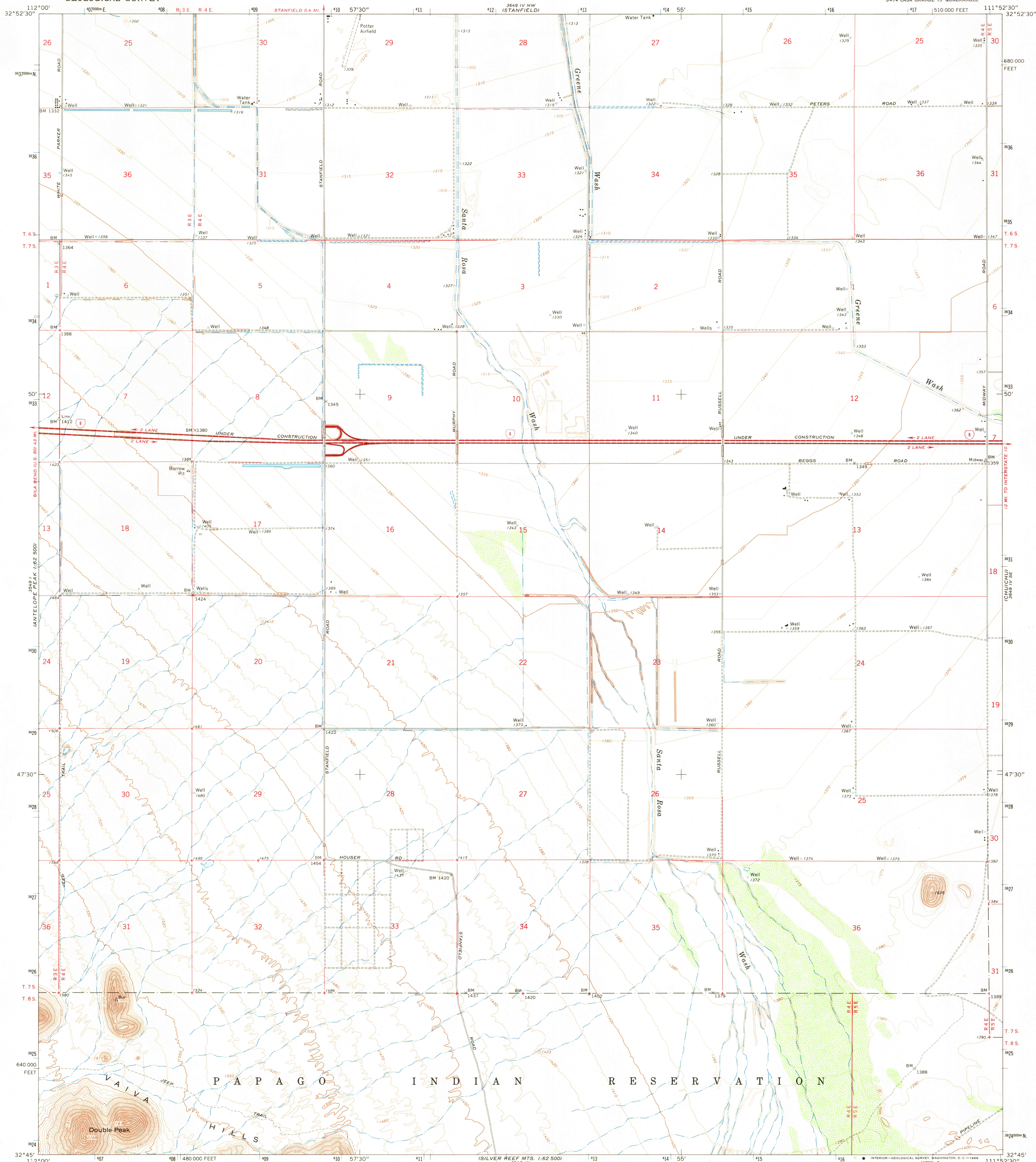

Mapped, edited, and published by the Geological Survey
Control by USGS and USC&GS
Topography by photogrammetric methods from aerial
photographs taken 1962 and planetable surveys 1965
Polyconic projection. 1927 North American datum
10,000-foot grid based on Arizona coordinate system, central zone
1000-meter Universal Transverse Mercator grid ticks,
zone 12, shown in blue
Where omitted, land lines have not been established
A portion of the north half of this map lies within a subsidence area
Vertical control based on latest available adjustment

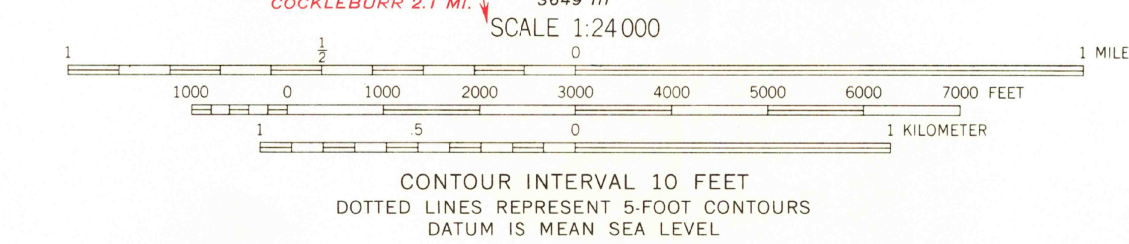

THIS MAP COMPLIES WITH NATIONAL MAP ACCURACY STANDARDS
FOR SALE BY U. S. GEOLOGICAL SURVEY, DENVER, COLORADO 80225, OR WASHINGTON, D. C. 20242
A FOLDER DESCRIBING TOPOGRAPHIC MAPS AND SYMBOLS IS AVAILABLE ON REQUEST

ROAD CLASSIFICATION
Heavy-duty ——— Light-duty ———
Unimproved dirt ——— Interstate Route ———



U.S.G.S.
TOPOGRAPHIC DIVISION

DOUBLE PEAK, ARIZ.
SW/4 CASA GRANDE 15' QUADRANGLE
N3245—W1152.5/7.5
1965

AMS 3649 IV SW—SERIES V988