

Produced by the United States Geological Survey
Topography compiled 1981. Planimetry derived from imagery taken 1978 and other sources. Public Land Survey System and survey control current as of 1983. Boundaries current as of 2001
North American Datum of 1983 (NAD 83). Projection and 1 000-meter grid: Universal Transverse Mercator, zone 12 2 500-meter ticks; Arizona Coordinate System of 1983 (east zone) and New Mexico Coordinate System of 1983 (west zone)
North American Datum of 1927 (NAD 27) is shown by dashed corner ticks. The values of the shift between NAD 83 and NAD 27 for 7.5-minute intersections are obtainable from National Geodetic Survey NADCON software
There may be private inholdings within the boundaries of the National or State reservations shown on this map

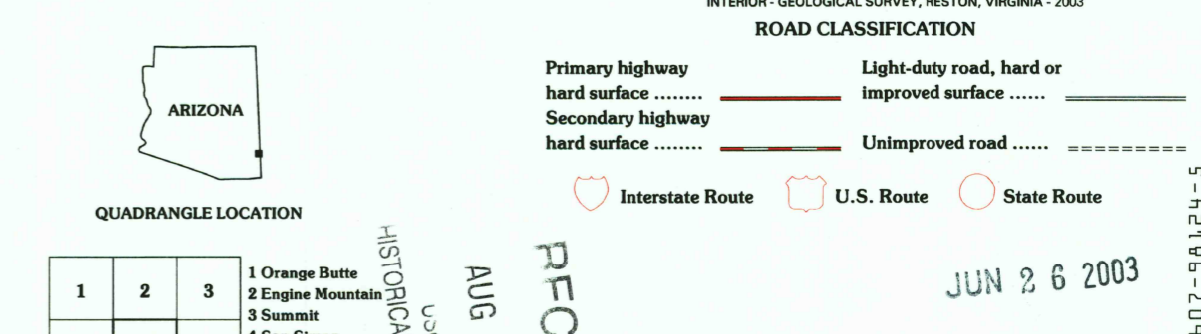
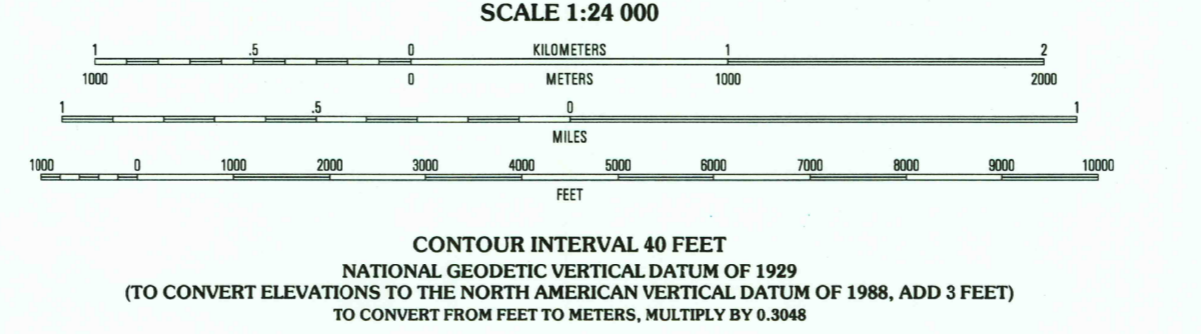
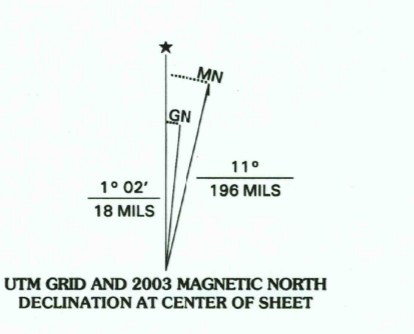

THIS MAP COMPLIES WITH NATIONAL MAP ACCURACY STANDARDS
FOR SALE BY U.S. GEOLOGICAL SURVEY, P.O. BOX 25286, DENVER, COLORADO 80225
A FOLDER DESCRIBING TOPOGRAPHIC MAPS AND SYMBOLS IS AVAILABLE ON REQUEST

RECEIVED
AUG 2 2003
JUN 26 2003
DOUBTFUL CANYON, AZ-NM
1998
NIMA 41481 SE-SERIES V898