

COBLE 1:62,500

UNITED STATES
DEPARTMENT OF THE INTERIOR
GEOLOGICAL SURVEY

UNITED STATES
DEPARTMENT OF THE ARMY
CORPS OF ENGINEERS

ENID QUADRANGLE
ARIZONA
7.5 MINUTE SERIES (TOPOGRAPHIC)
SW/4 MARICOPA 15' QUADRANGLE

PIMA BUTTE

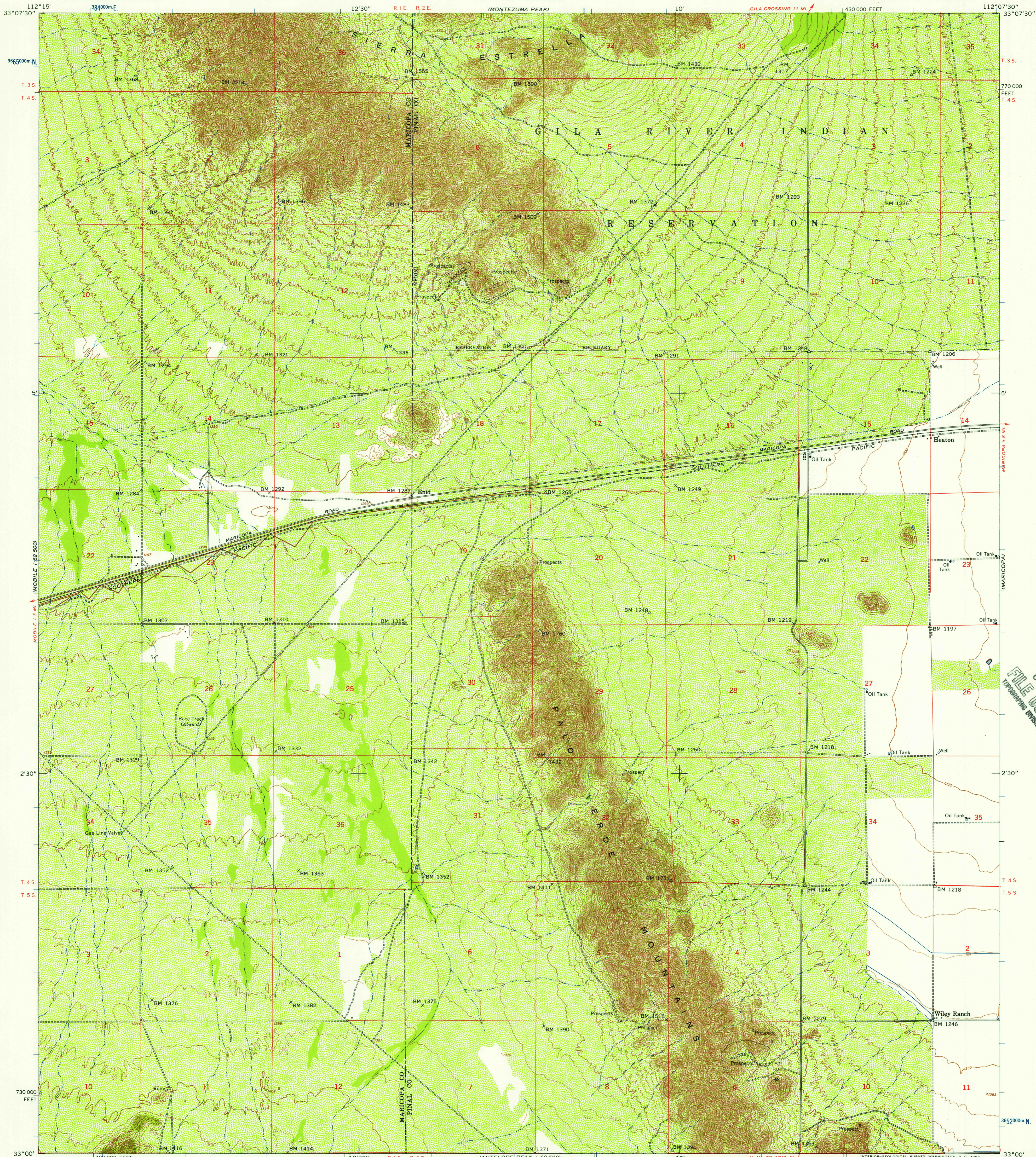

Mapped by the Army Map Service
Published for civil use by the Geological Survey
Control by USGS, USC&GS and USCE
Topography from aerial photographs by photogrammetric methods
Aerial photographs taken 1951. Field check 1951-1952
Polyconic projection. 1927 North American datum
10 000-foot grid based on Arizona coordinate system, central zone
1000-meter Universal Transverse Mercator grid ticks,
zone 12, shown in blue
Unchecked elevations are shown in brown

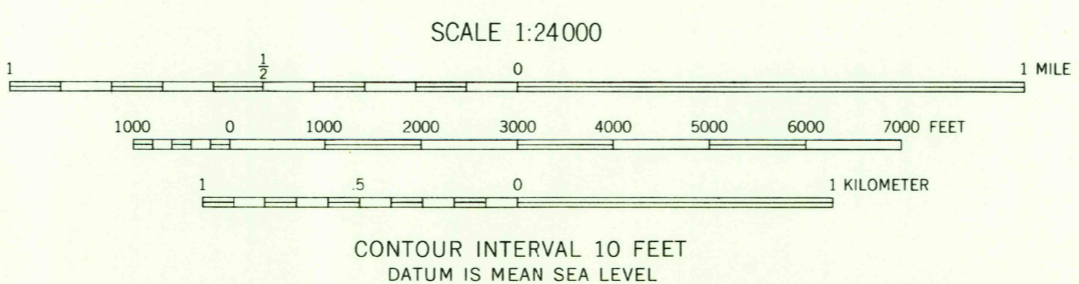
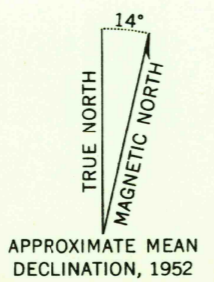

CONTOUR INTERVAL 10 FEET
DATUM IS MEAN SEA LEVEL

USGS
Historical File
Topographic Division



QUADRANGLE LOCATION

ROAD CLASSIFICATION
Light-duty ————— Unimproved dirt - - - - -

U.S.G.S.
FILE COPY
TOPOGRAPHIC DIVISION

ENID, ARIZ.
SW/4 MARICOPA 15' QUADRANGLE
N3300—W11207.5/7.5

1952

OCT - 2 1957

2145

U.S.G.S.
FILE COPY
TOPOGRAPHIC DIVISION