

Produced by the United States Geological Survey
Topography compiled 1946. Planimetry derived from imagery taken 1996 and other sources. Public Land Survey System and survey control current as of 1948. Boundaries current as of 2000
North American Datum of 1983 (NAD 83). Projection and 1 000-meter grid: Universal Transverse Mercator, zone 12
2 500-meter ticks: Arizona Coordinate System of 1983 (east zone)
North American Datum of 1927 (NAD 27) is shown by dashed corner ticks. The values of the shift between NAD 83 and NAD 27 for 7.5-minute intersections are obtainable from National Geodetic Survey NADCON software
There may be private holdings within the boundaries of the National or State reservations shown on this map

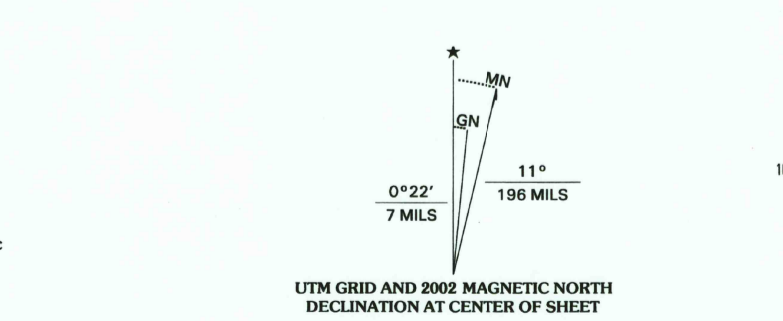

CONTOUR INTERVAL 25 FEET
NATIONAL GEODETIC VERTICAL DATUM OF 1929
(TO CONVERT ELEVATIONS TO THE NORTH AMERICAN VERTICAL DATUM OF 1988, ADD 3 FEET)
TO CONVERT FROM FEET TO METERS, MULTIPLY BY 0.3048

ROAD CLASSIFICATION

- Primary highway: hard surface
- Secondary highway: hard surface
- Light-duty road, hard or improved surface
- Unimproved road
- Interstate Route
- U.S. Route
- State Route

QUADRANGLE LOCATION

1	2	3
4	5	6
7	8	

1 Apache Peak
2 McGrew Spring
3 Land
4 Mustang Mountains
5 Fairbank
6 Payson Ranch
7 Fort Huachuca
8 Lewis Springs

ADJOINING 7.5 QUADRANGLE NAMES

THIS MAP COMPLIES WITH NATIONAL MAP ACCURACY STANDARDS
FOR SALE BY U.S. GEOLOGICAL SURVEY, P.O. BOX 25286, DENVER, COLORADO 80225
A FOLDER DESCRIBING TOPOGRAPHIC MAPS AND SYMBOLS IS AVAILABLE ON REQUEST

RECEIVED
APR 30 2002 HUACHUCA CITY, AZ
1996
HISTORICAL MAP ARCHIVES NIMA 3947 III NE-SERIES V898

