

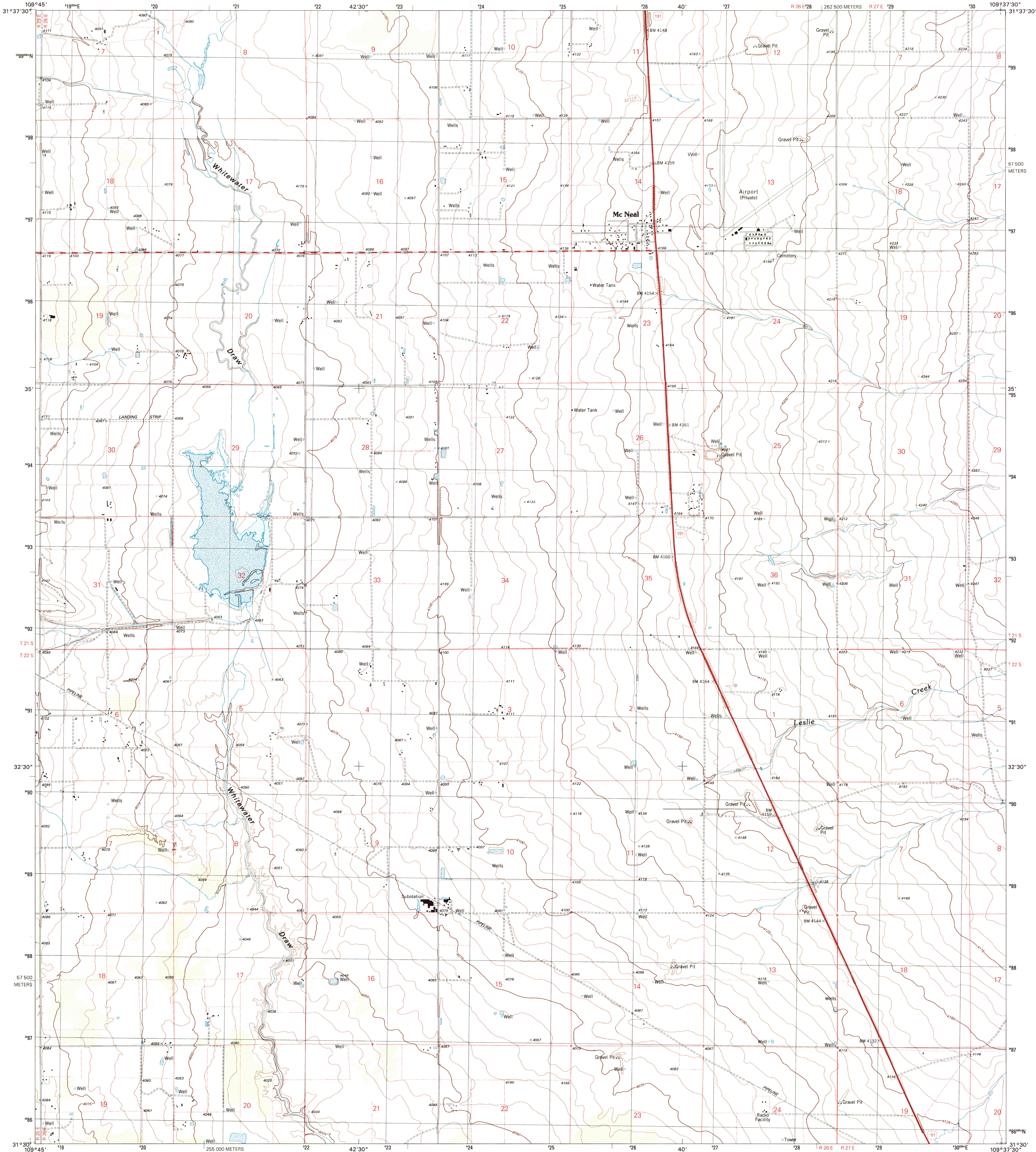

U.S. DEPARTMENT OF THE INTERIOR
U.S. GEOLOGICAL SURVEY

MC NEAL QUADRANGLE
ARIZONA-COCHISE CO.
7.5-MINUTE SERIES (TOPOGRAPHIC)



Produced by the United States Geological Survey
Topography compiled 1979. Planimetry derived from imagery taken 1996 and other sources. Public Land Survey System and survey control current as of 1980. Boundaries current as of 2001
North American Datum of 1983 (NAD 83). Projection and 1000-meter grid: Universal Transverse Mercator, zone 12
2 500-meter ticks: Arizona Coordinate System of 1983 (east zone)
North American Datum of 1927 (NAD 27) is shown by dashed corner ticks. The values of the shift between NAD 83 and NAD 27 for 7.5-minute intersections are obtainable from National Geodetic Survey NADCON software
Houses of worship, schools, and other labeled buildings verified 1980

UTM GRID AND 2002 MAGNETIC NORTH DECLINATION AT CENTER OF SHEET
11°
196 MILS
0° 41'
12 MILS

SCALE 1:24 000
KILOMETERS
METERS
MILES
FEET
CONTOUR INTERVAL 5 FEET
NATIONAL GEODETTIC VERTICAL DATUM OF 1929
(TO CONVERT ELEVATIONS TO THE NORTH AMERICAN VERTICAL DATUM OF 1988, ADD 3 FEET)
TO CONVERT FROM FEET TO METERS, MULTIPLY BY 0.3048

QUADRANGLE LOCATION
ARIZONA
1 Outlaw Mountain
2 Elfrida
3 Switchback Mountain
4 Glenview SE
5 Leslie Canyon
6 Blaine NE
7 Double Adobe
8 Douglas NE
ROAD CLASSIFICATION
Primary highway
hard surface
Secondary highway
hard surface
Light-duty road, hard or improved surface
Unimproved road
Interstate Route
U.S. Route
State Route
JUN 26 2003
MC NEAL, AZ
1996
NIMA 4047 II SW-SERIES V898

THIS MAP COMPLIES WITH NATIONAL MAP ACCURACY STANDARDS
FOR SALE BY U.S. GEOLOGICAL SURVEY, P.O. BOX 25286, DENVER, COLORADO 80225
A FOLDER DESCRIBING TOPOGRAPHIC MAPS AND SYMBOLS IS AVAILABLE ON REQUEST