

REPRODUCED COPY
This sheet must not be taken from
the files without an order from the
Chief Topographic Engineer.

178-N-IV-W/2-W/2
STATE OF ARIZONA
GEO. W. P. HUNT, GOVERNOR
FRANK P. TROTT, STATE WATER COMMISSIONER
(Aztec)

TOPOGRAPHIC FILES
ARIZONA
(YUMA COUNTY)
AGUILA MOUNTAINS QUADRANGLE
(WEST HALF)

20' Advance sheet
Subject to correction

DEPARTMENT OF THE INTERIOR
U. S. GEOLOGICAL SURVEY

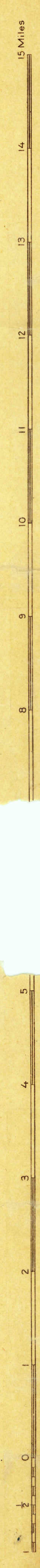

1030000 YARDS
T. 11 S.
T. 10 S.
T. 9 S.
T. 8 S.
R. 12 W.
T. G. Gardine, Division Engineer
Topography by Bishop Moorhead and C.N. Mortenson
Control by U. S. Geological Survey
Surveyed in 1927

TRUE NORTH
MAGNETIC NORTH
APPROXIMATE MEAN
DECLINATION, 1927

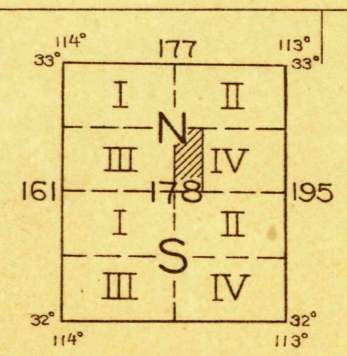
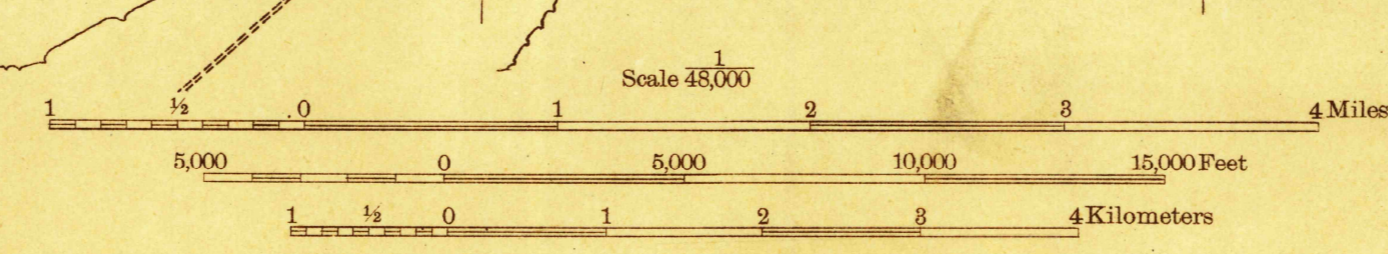

Polyconic projection. North American datum
5000 yard grid based upon U. S. zone system, F

AGUILA MOUNTAINS, ARIZ
(WEST HALF)

RETURN TO:
USGS AND HISTORICAL MAP ARCHIVES