

GRAND CANYON NO. 1, ARIZ.
(PARTIAL ADVANCE)

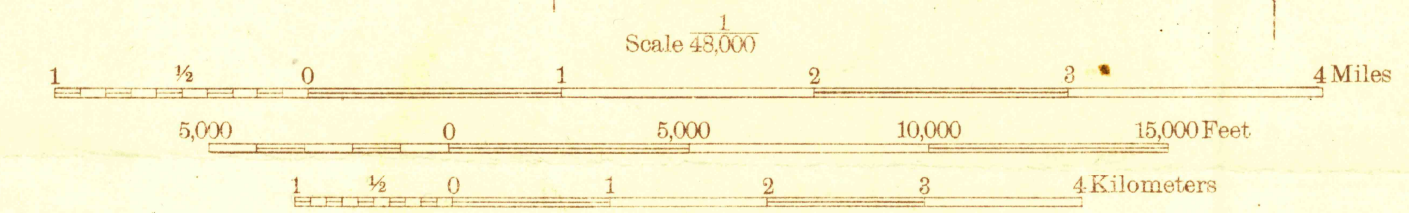

Topography by Richard T. Evans
Surveyed in 1905 and 1923.

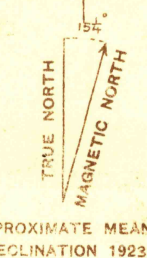

Contour interval 50 feet
Datum is mean sea level
Readjustment indicates that elevations on this map should be decreased by 4 feet.

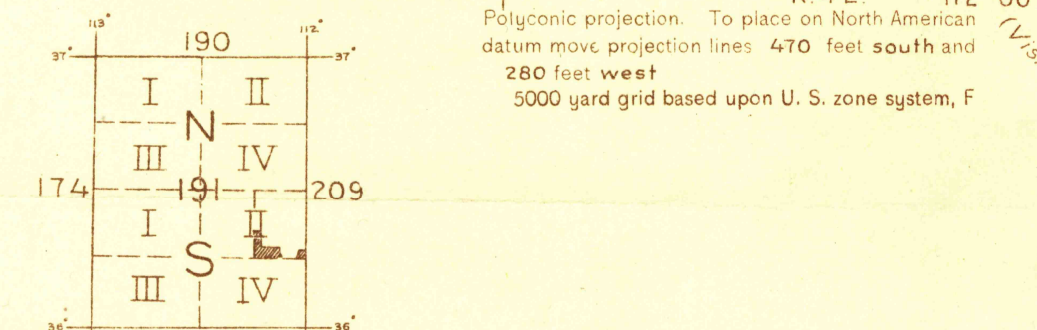

Polyconic projection. To place on North American datum move projection lines 470 feet south and 280 feet west
5000 yard grid based upon U. S. zone system, F