

U.S.G.S.
FILE COPY
Inspection and Editing.

UNITED STATES
DEPARTMENT OF THE INTERIOR
GEOLOGICAL SURVEY

STATE OF ARIZONA
STATE WATER COMMISSIONER
(Aztec)

ARIZONA
(YUMA COUNTY)
AGUILA MOUNTAINS QUADRANGLE

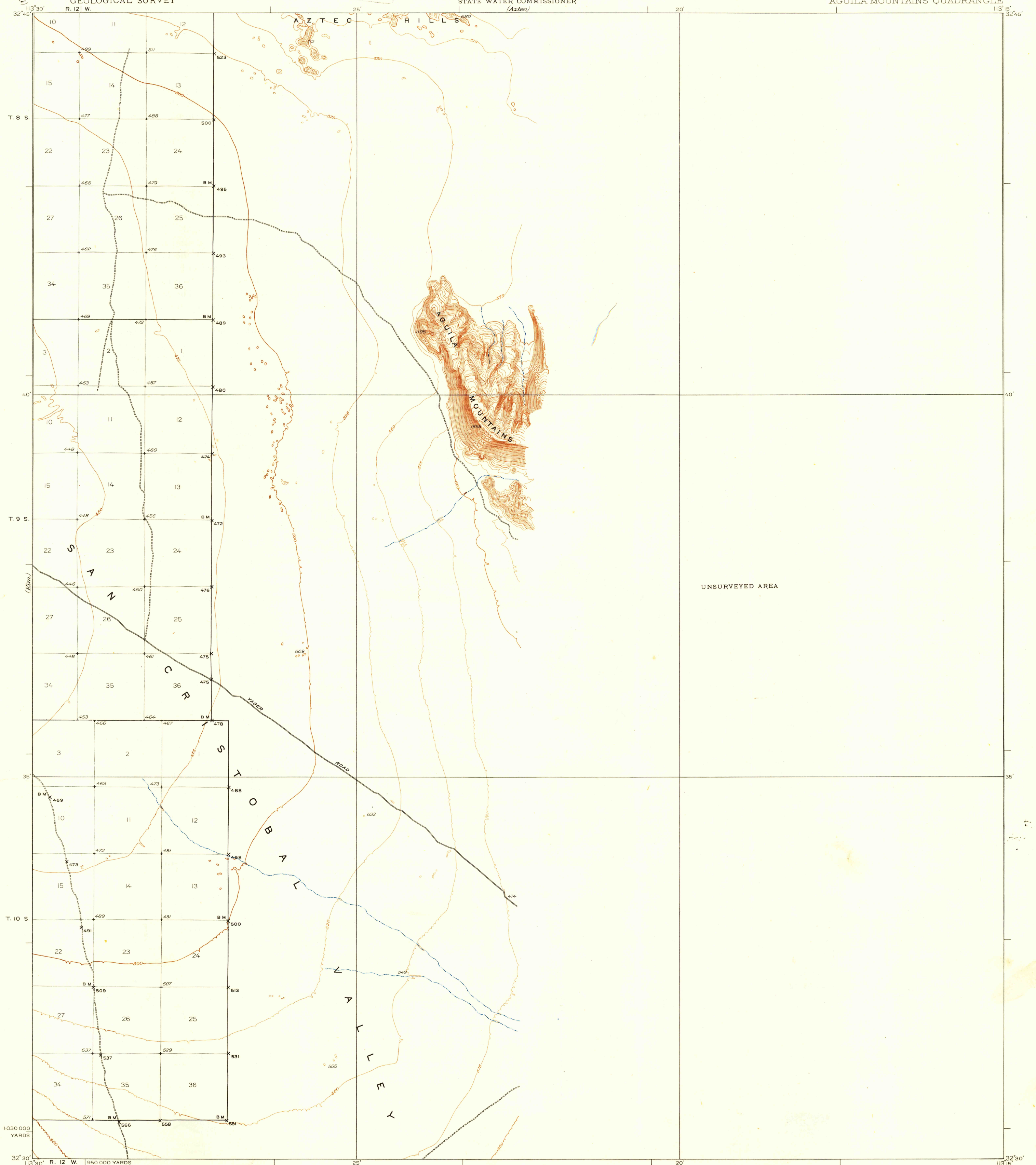

Topography by Bishop Moorhead and C.N. Mortenson
Surveyed in 1927

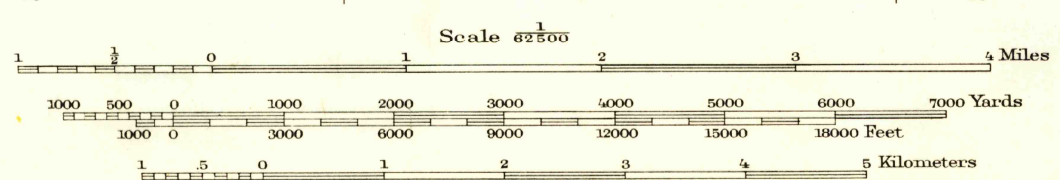
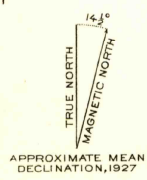

Contour interval 25 feet
Datum is mean sea level

USGS
Historical File
Topographic Division

Polyconic projection, North American datum
5000 yard grid based upon U.S. zone system, F

U.S.G.S.
FILE COPY
Inspection and Editing.

AGUILA MOUNTAINS, ARIZ.
Edition of 1930
reprinted 1947
N3230-W11315/15

JUN 26 1947

2140