

SPECIAL EDITION

CORPS OF ENGINEERS, U. S. ARMY  
TACTICAL MAP

ARIZONA  
BOWIE QUADRANGLE  
GRID ZONES E&E

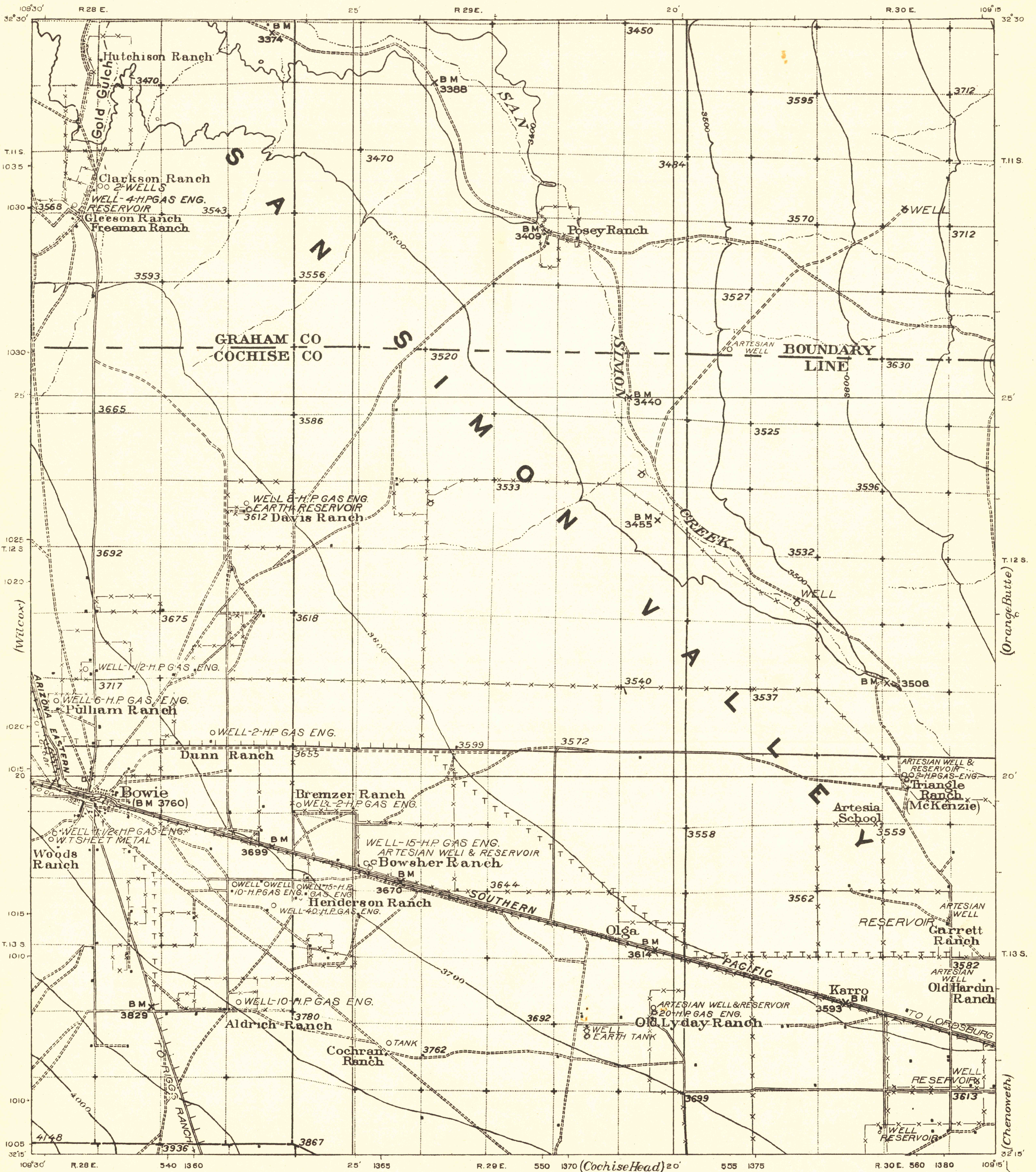

Base Map U.S. Geological Survey Engraving.  
 J.N. Hodges, Maj., Corps of Engineers, Engineer, 8th C.A.  
 Robert C. Hunter, Capt., Corps of Engrs, Deputy, Acting  
 Chief of Map Section.  
 A. Drouet, Surveyor, Chief Draftsman.  
 R.O. Baker, Pvt., Co. E, 2nd Engrs. Draftsman.  
 Area revised by reconnaissance methods under  
 direction of Engineer, Eighth Corps Area, by Capt.  
 P.E. Bermel, C of E., 1922.

Good Road ———  
 Poor Road =====  
 Trail - - - - -

FILE COPY  
 Map Information Office

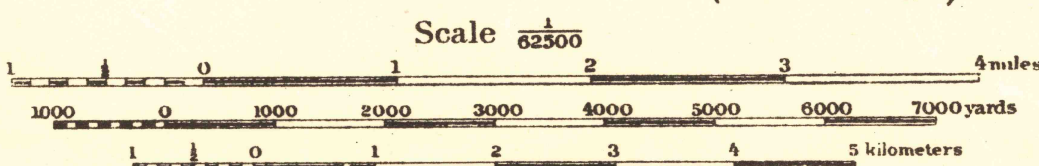

Contour Interval 100 feet

Datum is mean sea level.  
 FIVE THOUSAND YARD GRID COMPUTED FROM "GRID SYSTEM FOR PROGRESSIVE MAPS  
 IN THE U.S. ZONE 'E' & 'F' U.S.C. & G.S. SPECIAL PUBLICATION NO. 59  
 (THE LAST THREE DIGITS OF THE GRID NUMBERS ARE OMITTED.)

Grid ticks for zone 'E' indicated by dots.

Polyconic Projection North American Datum

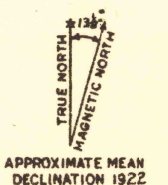

BOWIE-ARIZ.

Enlarged by photography from 30 minute quadrangle  
 on Polyconic Projection North American Datum  
 placing the medial meridian on the right edge of this sheet.