

33° 45' N
113° 00' W
AGUA FUELES
MOUNTAINS

UNITED STATES
DEPARTMENT OF THE INTERIOR
GEOLOGICAL SURVEY

LUKEVILLE QUADRANGLE
ARIZONA
15 MINUTE SERIES (TOPOGRAPHIC)

33° 45' N
112° 45' W
MOUNTAIN

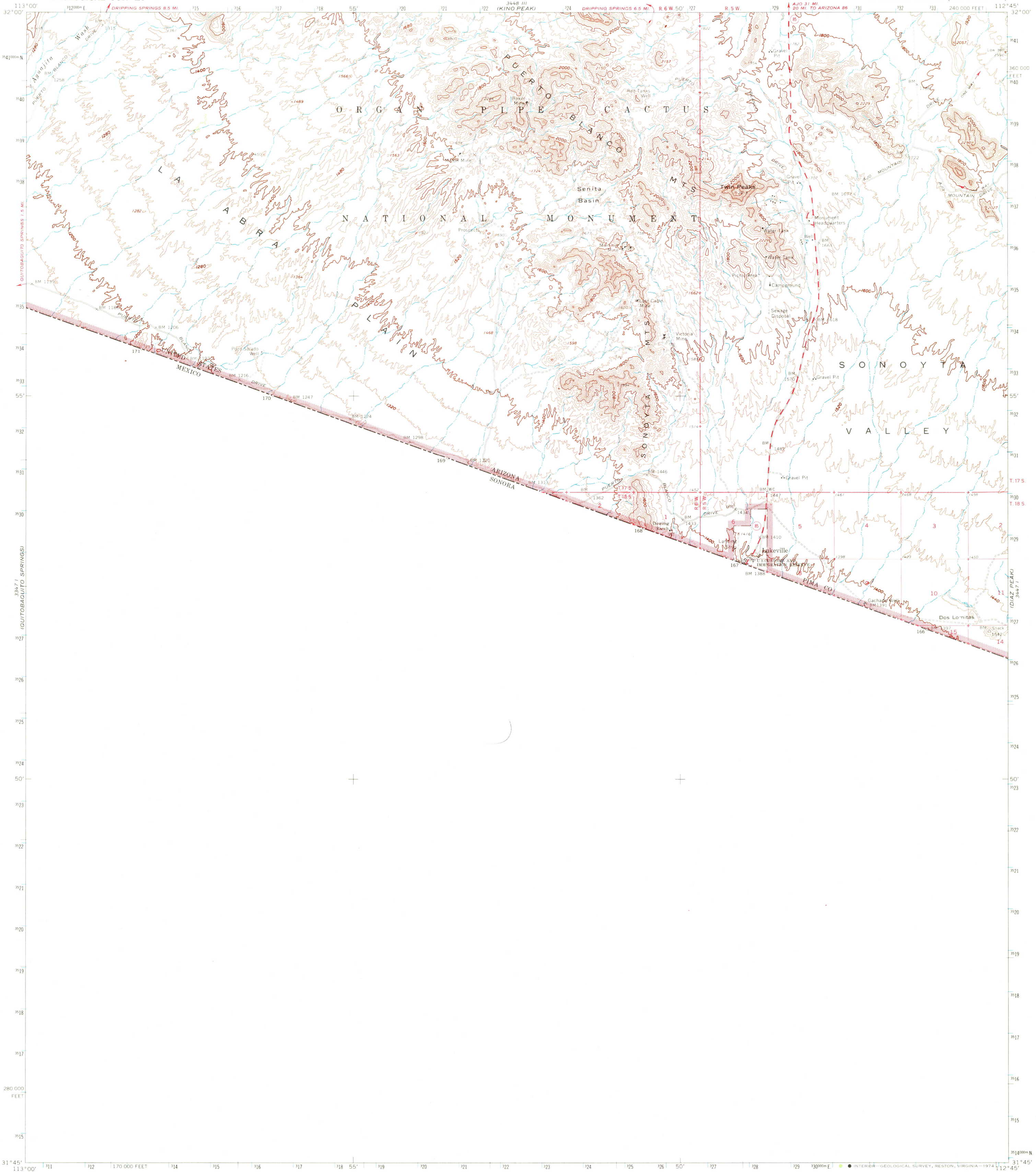

Mapped, edited, and published by the Geological Survey
Control by USGS and USC&GS
Topography by photogrammetric methods from aerial
photographs taken 1961. Field checked 1963
Polyconic projection. 1927 North American datum
10,000-foot grid based on Arizona coordinate system, central zone
1000-meter Universal Transverse Mercator grid ticks,
zone 12, shown in blue
Where omitted, land lines have not been established

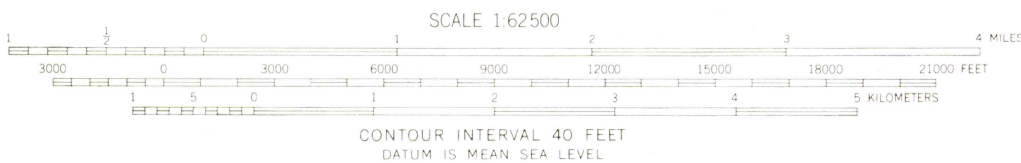
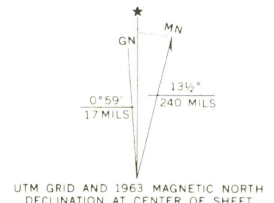

ROAD CLASSIFICATION
Medium duty ——— Light duty ———
Unimproved dirt
State Route (circle)

APR 08 1974
LUKEVILLE, ARIZ.
N3145—W11245/15

THIS MAP COMPLIES WITH NATIONAL MAP ACCURACY STANDARDS
FOR SALE BY U.S. GEOLOGICAL SURVEY, DENVER, COLORADO 80225, OR RESTON, VIRGINIA 22092
A FOLDER DESCRIBING TOPOGRAPHIC MAPS AND SYMBOLS IS AVAILABLE ON REQUEST

USGS
Historical File
Topographic Division

1963
AMS 3447 IV—SERIES V798

4095