

UNITED STATES
DEPARTMENT OF THE INTERIOR
GEOLOGICAL SURVEY

RED ROCK QUADRANGLE
ARIZONA
15 MINUTE SERIES (TOPOGRAPHIC)

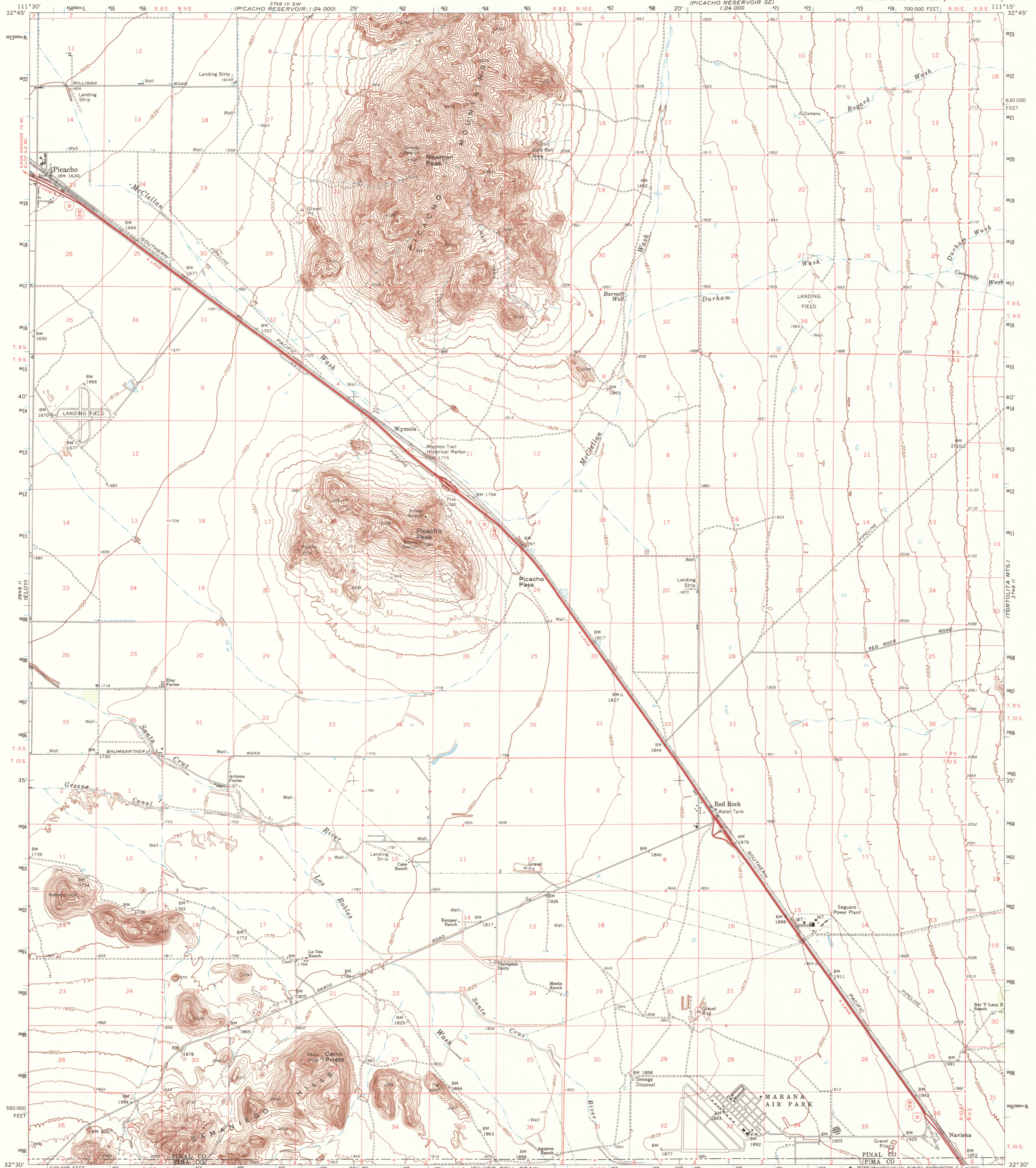

Mapped, edited and published by the Geological Survey in cooperation with the Army Map Service
Control by USGS and USC&GS
Topography by planetable surveys 1946. Revised 1963
Polyconic projection. 1927 North American datum
10,000-foot grid based on Arizona coordinate system, central zone
1000-meter Universal Transverse Mercator grid ticks, zone 12, shown in blue
Where omitted, land lines have not been established

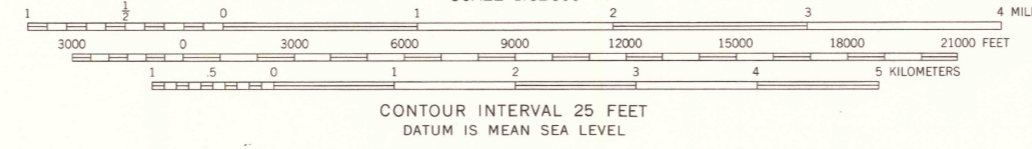
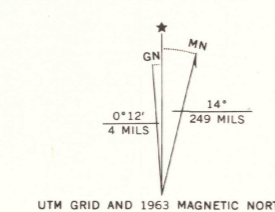

THIS MAP COMPLIES WITH NATIONAL MAP ACCURACY STANDARDS
FOR SALE BY U. S. GEOLOGICAL SURVEY, DENVER, COLORADO 80225, OR RESTON, VIRGINIA 22092
A FOLDER DESCRIBING TOPOGRAPHIC MAPS AND SYMBOLS IS AVAILABLE ON REQUEST

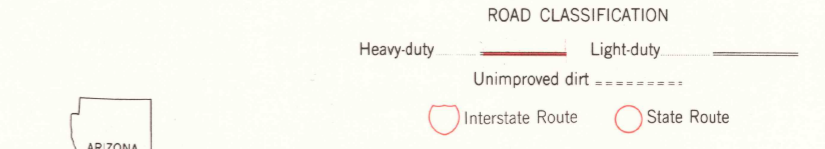

ARIZONA
QUADRANGLE LOCATION
USGS NMD HISTORICAL MAP
MAR 29 1989
REC'D FILE COPY
RED ROCK, ARIZ.
N3230-W1115/15
1963
AMS 3749 III-SERIES V798