

H Burgess, Colonel, C.E., Engineer, Eighth Corps Area.
Robt. C. Hunter, Captain, C.E., Deputy, Acting Chief of Map Section.
Jos. J. Twitty, 1st Lt. and Harry Meyer, 2nd Lt., C.E., Officers in Charge.
Topography by C. A. Bruner, W. J. Leonard, Sgts. and J. Janik, Corp., Co. E., 2nd Engineers.
Control by U.S. Coast and Geodetic Survey; U.S. Geological Survey; W. J. Leonard, Sgt.,
E. L. Mang, Corp. and P. Karg, Pvt. 1st, Co. E., 2nd Engineers.
Surveyed 1924.
Office drafting by J. L. Barr, St. Sgt., Enl. Det., Office, Engr. 8th C.A., under
supervision of A. Drouet, Surveyor, Chief Draftsman.



Contour Interval 20 feet
Datum is mean sea level

FIVE THOUSAND YARD GRID COMPUTED FROM "GRID SYSTEM FOR PROGRESSIVE MAPS
IN THE U.S. - ZONE 'T' U.S.C. & G.S. SPECIAL PUBLICATION NO 59
(THE LAST THREE DIGITS OF THE GRID NUMBERS ARE OMITTED)

NOTE. USERS OF THIS MAP ARE REQUESTED TO MARK HEREON CORRECTIONS AND ADDITIONS WHICH COME
TO THEIR ATTENTION AND MAIL DIRECT TO "ENGINEER EIGHTH CORPS AREA, FT. SAM HOUSTON TEX."

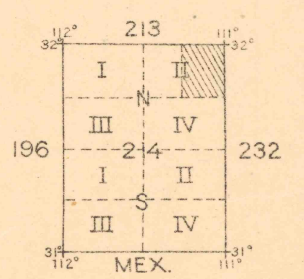

APPROXIMATE MEAN
DECLINATION 13 24'
ANNUAL MAGNETIC INCREASE 30'

SAMANIEGO PEAK, ARIZONA.
EIGHTH CORPS AREA ENGINEER REPRODUCTION PLANT.
1925

C.A.E.
J.L.
W.J.L.

*Now
Twin Buttes*