

(COCHISE)

(COCHISE HEAD)

UNITED STATES DEPARTMENT OF THE INTERIOR GEOLOGICAL SURVEY

SQUARETOP HILLS QUADRANGLE ARIZONA-COCHISE CO. 15 MINUTE SERIES (TOPOGRAPHIC)

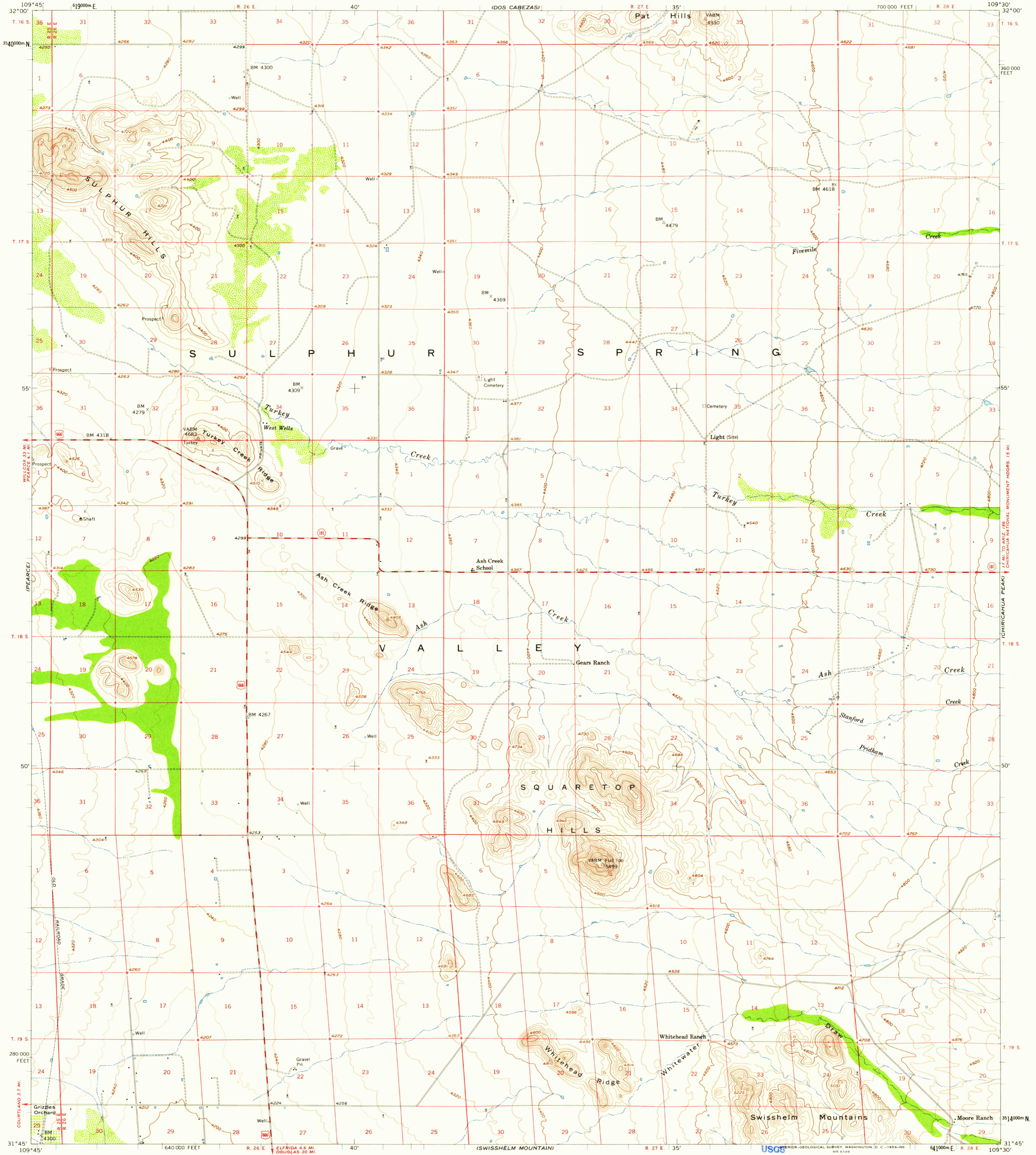

Mapped, edited, and published by the Geological Survey... Control by USGS and USC&GS... Topography from aerial photographs by ER-55 plotter... Aerial photographs taken 1956. Field check 1958... Polyconic projection. 1927 North American datum... 10,000-foot grid based on Arizona coordinate system, east zone... 1000-meter Universal Transverse Mercator grid ticks, zone 12, shown in blue... Unchecked elevations are shown in brown

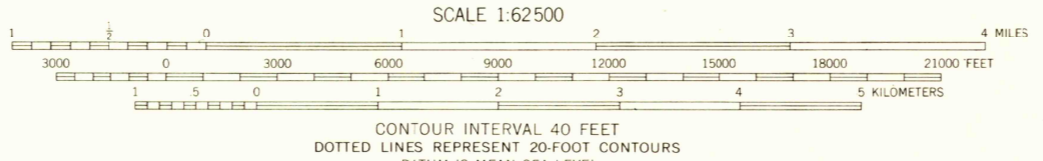
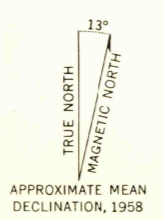

CONTOUR INTERVAL 40 FEET DOTTED LINES REPRESENT 20-FOOT CONTOURS DATUM IS MEAN SEA LEVEL

USGS Historical File Topographic Division. ROAD CLASSIFICATION: Medium-duty, Light-duty, Unimproved dirt. U.S. Route, State Route. Includes a small map of Arizona showing the quadrangle location.

THIS MAP COMPLIES WITH NATIONAL MAP ACCURACY STANDARDS FOR SALE BY U.S. GEOLOGICAL SURVEY, DENVER 2, COLORADO OR WASHINGTON 25, D. C. A FOLDER DESCRIBING TOPOGRAPHIC MAPS AND SYMBOLS IS AVAILABLE ON REQUEST

U.S.G.S. FILE COPY TOPOGRAPHIC DIVISION

SQUARETOP HILLS, ARIZ. N3145-W10930/15 1958

APR 23 1959 2440