

U.S.G.S.
FILE COPY
Inspection and Editing

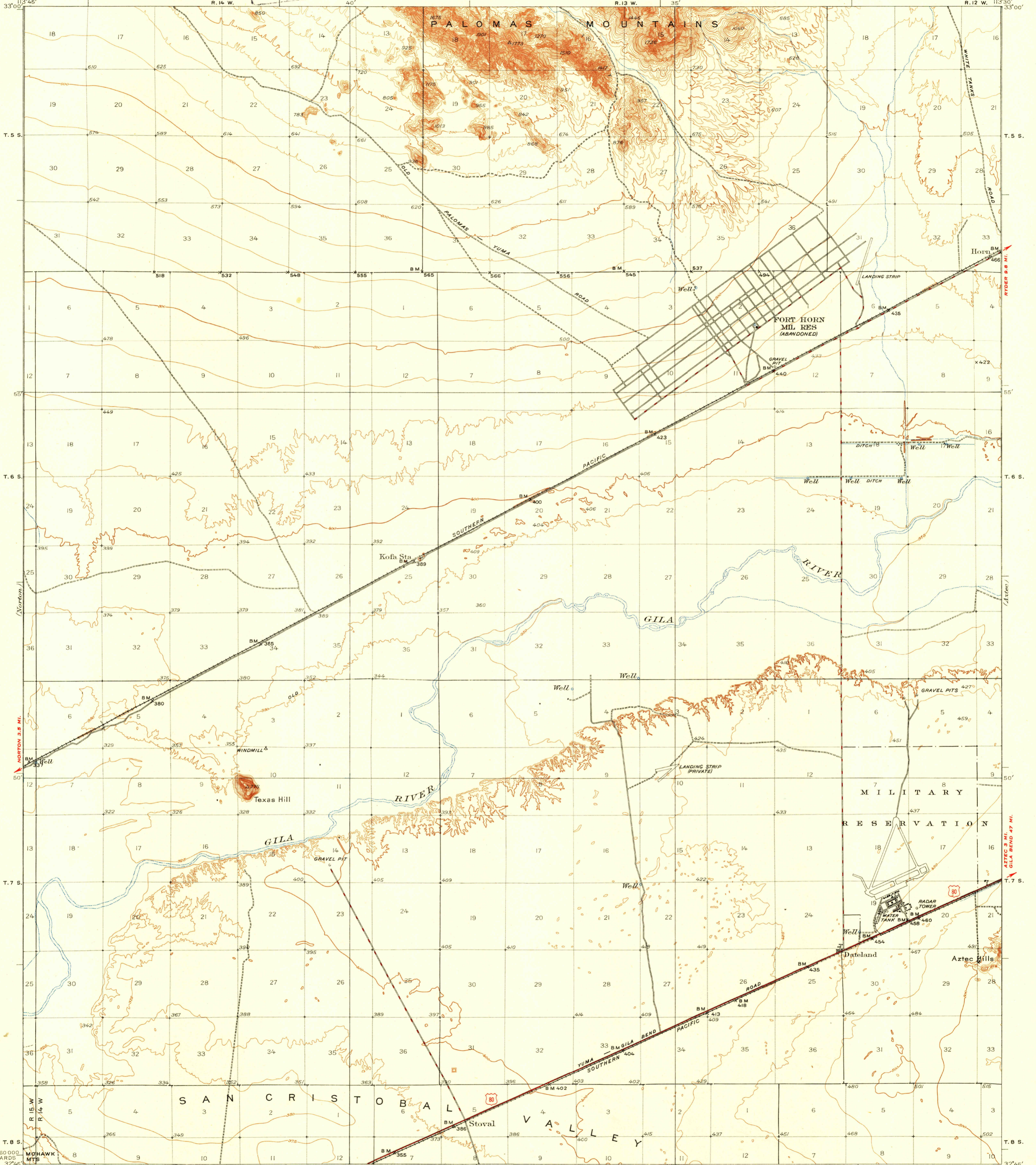

Topography by E.P. Davis and R.C. Stevenson
Surveyed in 1927
Partial revision, 1950

ROAD CLASSIFICATION
HARD-SURFACE ALL WEATHER ROADS DRY WEATHER ROADS
Heavy-duty ——— 2 LANE LANE Improved dirt ———
Medium-duty ——— 2 LANE LANE Unimproved dirt ———
Loose-surface, graded, or narrow hard-surface - - -
□ U. S. Route ○ State Route

TRUE NORTH
MAGNETIC NORTH
APPROXIMATE MEAN
DECLINATION, 1927

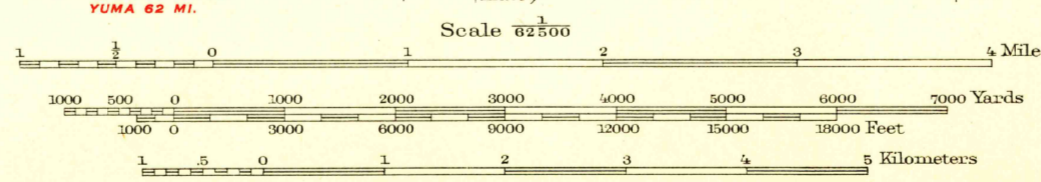

USGS
Historical File
Topographic Division

Polyconic projection, North American datum
5000 yard grid based upon U.S. zone system, F

STOVAL, ARIZ.
Edition of 1930
reprinted 1950
N3245-W11330/15

FOR SALE BY U.S. GEOLOGICAL SURVEY, FEDERAL CENTER, DENVER, COLORADO OR WASHINGTON 25, D.C.
A FOLDER DESCRIBING TOPOGRAPHIC MAPS AND SYMBOLS IS AVAILABLE ON REQUEST

U.S.G.S.
FILE COPY
Inspection and Editing