

(SIERRA BONITA RANCH)

UNITED STATES
DEPARTMENT OF THE INTERIOR
GEOLOGICAL SURVEY

WILLCOX QUADRANGLE
ARIZONA
15 MINUTE SERIES (TOPOGRAPHIC)

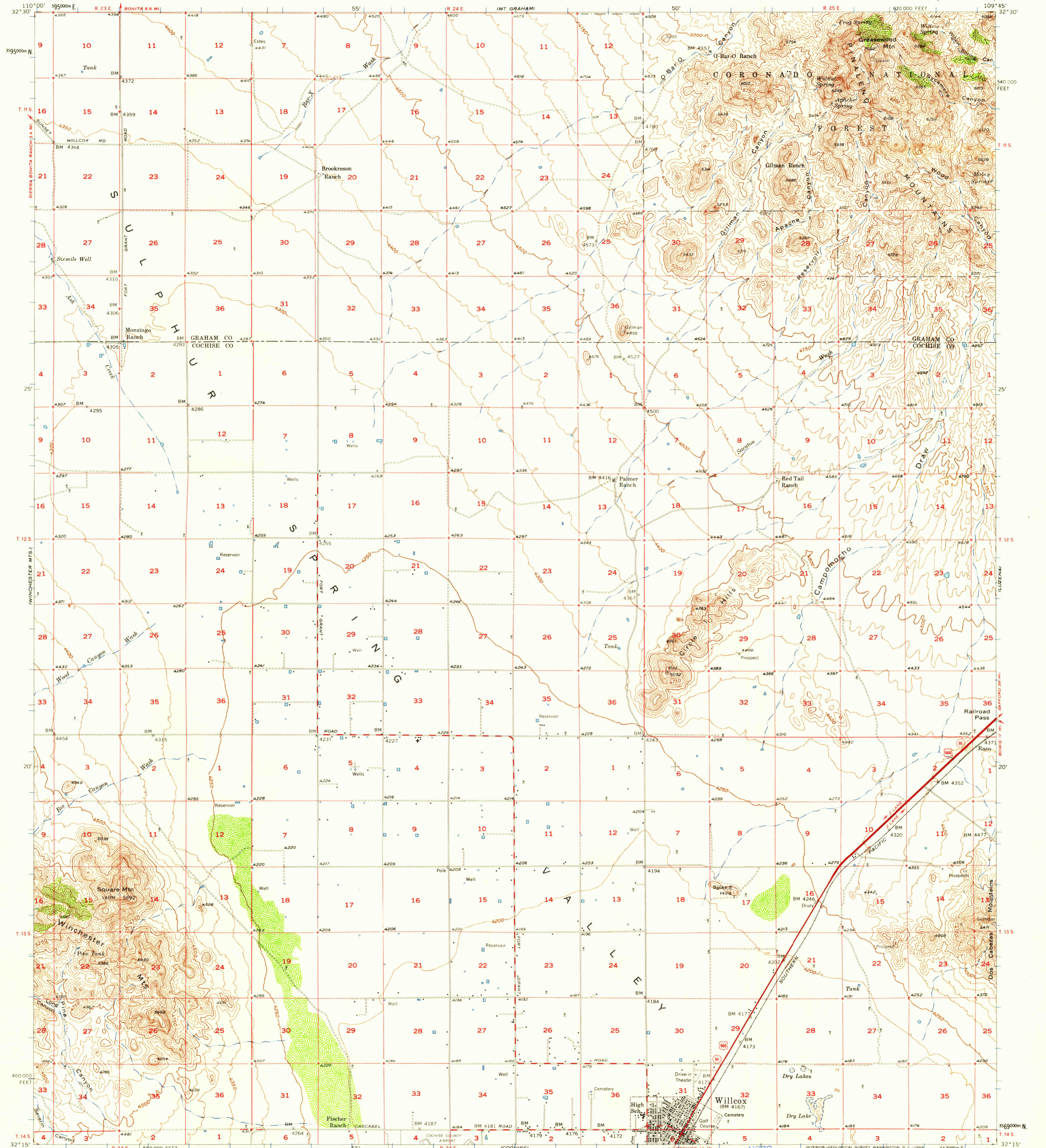

Mapped, edited, and published by the Geological Survey
Control by USGS and USC&GS
Topography by planetable surveys 1937 and 1941-42
Culture revision and field check 1958
Polyconic projection. 1927 North American datum
10,000-foot grid based on Arizona coordinate system,
east zone
1000-meter Universal Transverse Mercator grid ticks,
zone 12, shown in blue

TRUE NORTH
MAGNETIC NORTH
APPROXIMATE MEAN
DECLINATION, 1958

SCALE 1:62500
CONTOUR INTERVAL 50 FEET
DATUM IS MEAN SEA LEVEL

Historical File
Topographic Division



ROAD CLASSIFICATION
Heavy-duty ——— Light-duty ———
Medium-duty ——— Unimproved dirt ———
U.S. Route ——— State Route ———

U.S.G.S.
FILE COPY
TOPOGRAPHIC DIVISION

WILLCOX, ARIZ.
N3215-W10945/15
1958

FOR SALE BY U.S. GEOLOGICAL SURVEY, DENVER 2, COLORADO OR WASHINGTON 25, D. C.
A FOLDER DESCRIBING TOPOGRAPHIC MAPS AND SYMBOLS IS AVAILABLE ON REQUEST

MAR 6 1959

2395