

2553 III NE (SALMON MOUNTAINS)

UNITED STATES DEPARTMENT OF THE INTERIOR GEOLOGICAL SURVEY

ADELANTO QUADRANGLE CALIFORNIA—SAN BERNARDINO CO. 7.5 MINUTE SERIES (TOPOGRAPHIC) SW 1/4 VICTORVILLE 15' QUADRANGLE

2553 III NE (HELEDALE)

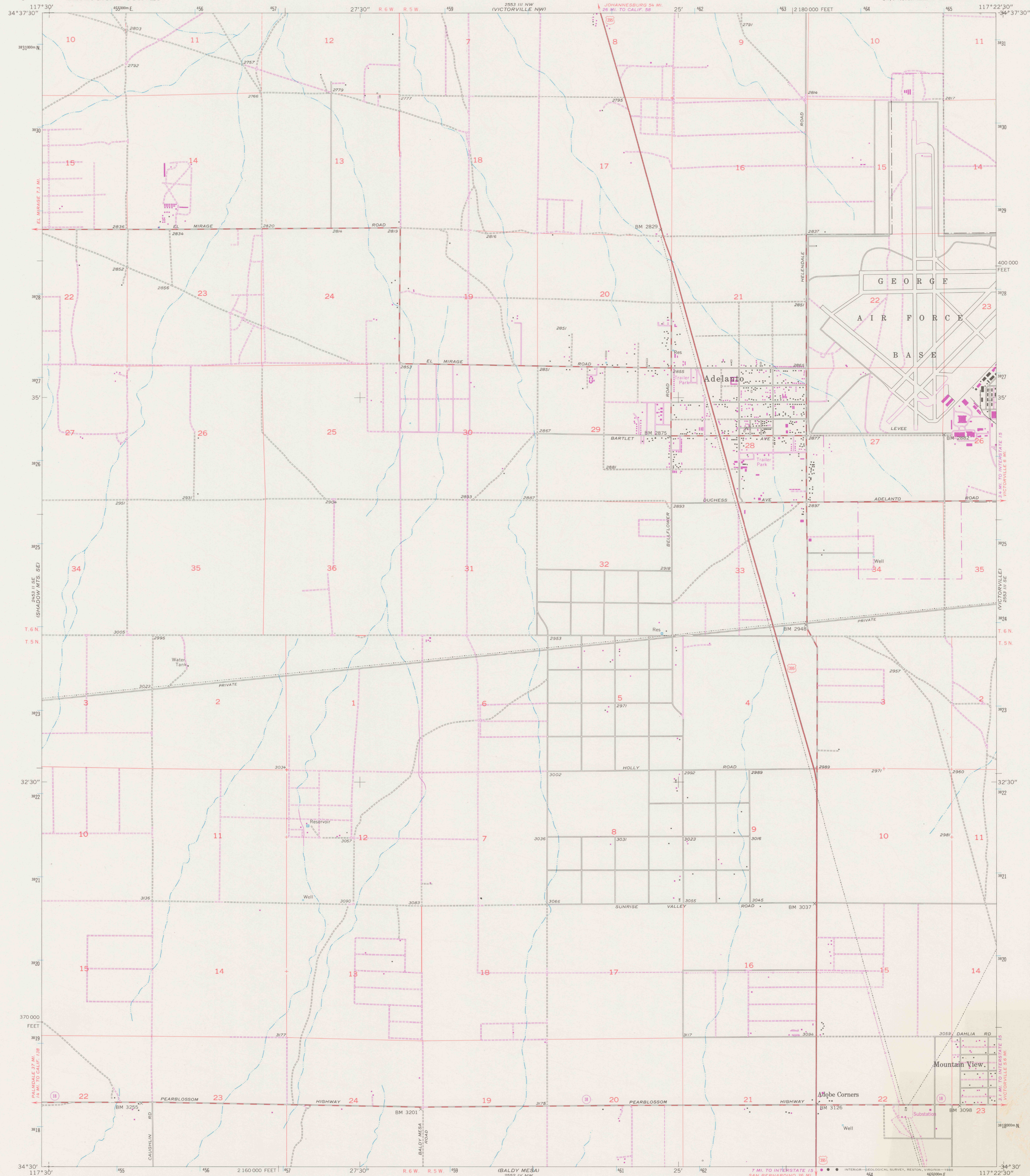

Mapped, edited, and published by the Geological Survey Control by USGS and USC&GS Topography from aerial photographs by Wild A-8 plotter and by planetable surveys 1956. Aerial photographs taken 1952. Polyconic projection, 10,000-foot grid based on California coordinate system, zone 5 1000-meter Universal Transverse Mercator grid ticks, zone 11, shown in blue. 1927 North American Datum To place on the predicted North American Datum 1983 move the projection lines 3 meters north and 83 meters east as shown by dashed corner ticks. Revisions shown in purple compiled from aerial photographs taken 1978 and other source data. This information not field checked. Map edited 1980.

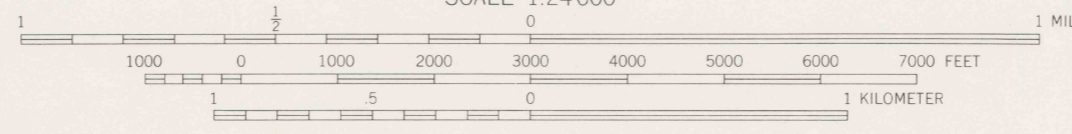
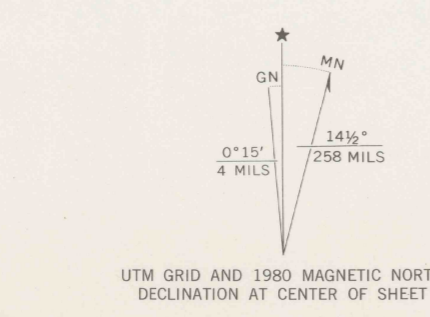

CONTOUR INTERVAL 10 FEET NATIONAL GEODETIC VERTICAL DATUM OF 1929

THIS MAP COMPLIES WITH NATIONAL MAP ACCURACY STANDARDS FOR SALE BY U.S. GEOLOGICAL SURVEY, DENVER, COLORADO 80225, OR RESTON, VIRGINIA 22092 A FOLDER DESCRIBING TOPOGRAPHIC MAPS AND SYMBOLS IS AVAILABLE ON REQUEST



ROAD CLASSIFICATION table with categories: Heavy-duty, Medium-duty, Light-duty, Unimproved dirt, Interstate Route, U.S. Route, State Route.

ADELANTO, CALIF. SW 1/4 VICTORVILLE 15' QUADRANGLE N3430—W11722.5/7.5

1956 PHOTOREVISED 1980 DMA 2553 III SW—SERIES V895

REFERENCE REF 3700s Van U5 7.5 ed. 1080 99

DO NOT CIRCULATE