

Produced by the United States Geological Survey 1990
Revision by USDA Forest Service 2004
Topography compiled 1984. Planimetry derived from imagery taken 1998 and other sources. Public Land Survey System and survey control current as of 2005. Boundaries current as of 2005.
North American Datum of 1983 (NAD 83). Projection and 1 000-meter grid: Universal Transverse Mercator, zone 11
10 000-foot ticks: California Coordinate System (zone III)
North American Datum of 1927 (NAD 27) is shown by dashed corner ticks
The values of the shift between NAD 83 and NAD 27 for 7.5-minute intersections are obtainable from National Geodetic Survey NADCON software
Non-National Forest System lands within the National Forest
Inholdings may exist in other National or State reservations
This map is not a legal document. Public lands are subject to change and leasing, and may have access restrictions; check with appropriate offices
Obtain permission before entering private lands

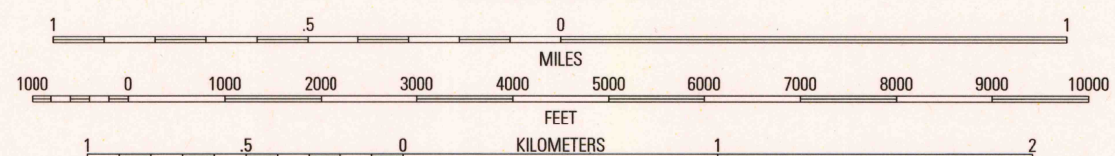

CONTOUR INTERVAL 40 FEET
NATIONAL GEODETIC VERTICAL DATUM OF 1929
TO CONVERT FROM FEET TO METERS, MULTIPLY BY 0.3048

THIS MAP COMPLIES WITH NATIONAL MAP ACCURACY STANDARDS
FOR SALE BY U.S. GEOLOGICAL SURVEY, P.O. BOX 25286, DENVER, COLORADO 80225
A FOLDER DESCRIBING TOPOGRAPHIC MAPS AND SYMBOLS IS AVAILABLE ON REQUEST

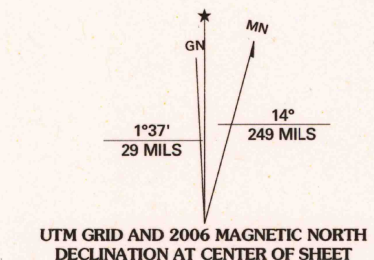

QUADRANGLE LOCATION

1	2	3
4	5	6
7	8	

ADJOINING 7.5' QUADRANGLES

HIGHWAYS AND ROADS

Interstate.....	(Red shield with black border)	Primary highway.....	(Red line)
U.S.	(Red shield with black border)	Secondary highway.....	(Red dashed line)
State.....	(Red shield with black border)	Light-duty road.....	(Red dashed line with cross-ticks)
County.....	(Red shield with black border)	Composition: Unspecified.....	(Black line)
National Forest, suitable for passenger cars.....	(Red shield with black border)	Paved.....	(Black line with cross-ticks)
National Forest, suitable for high clearance vehicles.....	(Red shield with black border)	Gravel.....	(Black line with cross-ticks)
National Forest Trail.....	(Red shield with black border)	Dirt.....	(Black line with cross-ticks)
		Unimproved; 4 wheel drive.....	(Black line with cross-ticks)
		Trail.....	(Black line with cross-ticks)
		Gate; Barrier.....	(Black line with cross-ticks)

AHWAHNEE, CA
2004
37119-C6-TF-024
NGA 2058 | SW-SERIES V895

