

Advance sheet
Subject to correction

(Wilson)

DEPARTMENT OF THE INTERIOR
U. S. GEOLOGICAL SURVEY

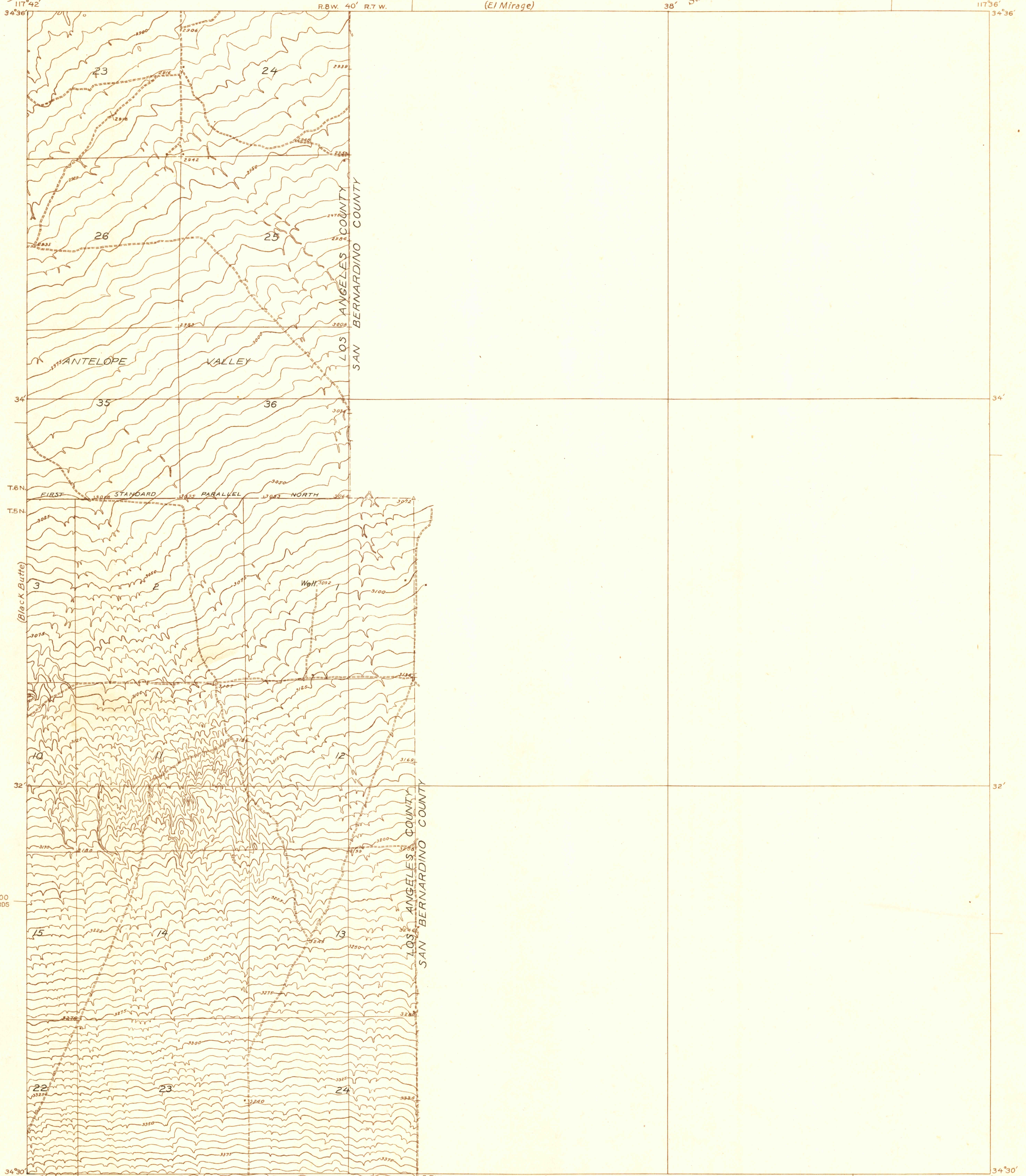

1,280,000
YARDS

H. H. Hodgeson, Division Engineer
Topography by F. K. Van Zandt
Control by U. S. Geological Survey
Surveyed in 1930

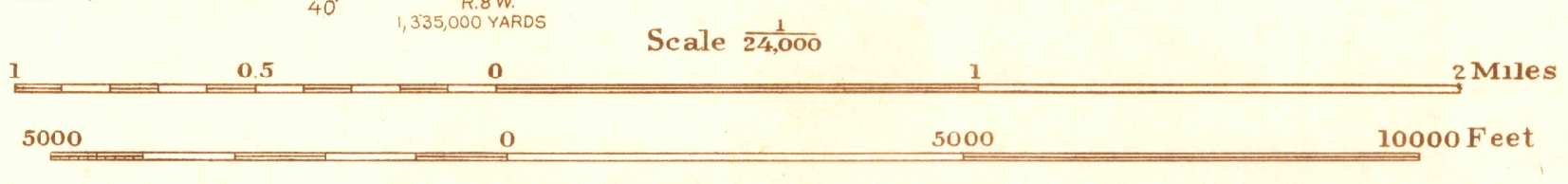
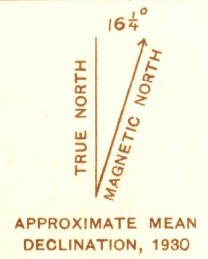

Contour interval 5 feet
Datum is mean sea level

Polygonic projection. North American datum
5000 yard grid based upon U. S. zone system, G

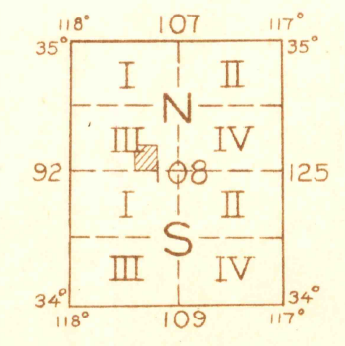

ANGLE, CALIF.

USGS
Historical File
Topographic Division