

RETAINED COPY
This sheet must not be taken from
the files without an order from the
Chief Topographic Engineer.

93-N-11
LOS ANGELES COUNTY, CALIFORNIA
BOARD OF SUPERVISORS
R. F. MC CLELLAN, CHAIRMAN
J. E. ROCKHOLD, COUNTY SURVEYOR

U. S. GEOLOGICAL SURVEY
TOPOGRAPHIC FILES

CALIFORNIA
ARTESIA QUADRANGLE

44 82 1924

DEPARTMENT OF THE INTERIOR
U. S. GEOLOGICAL SURVEY

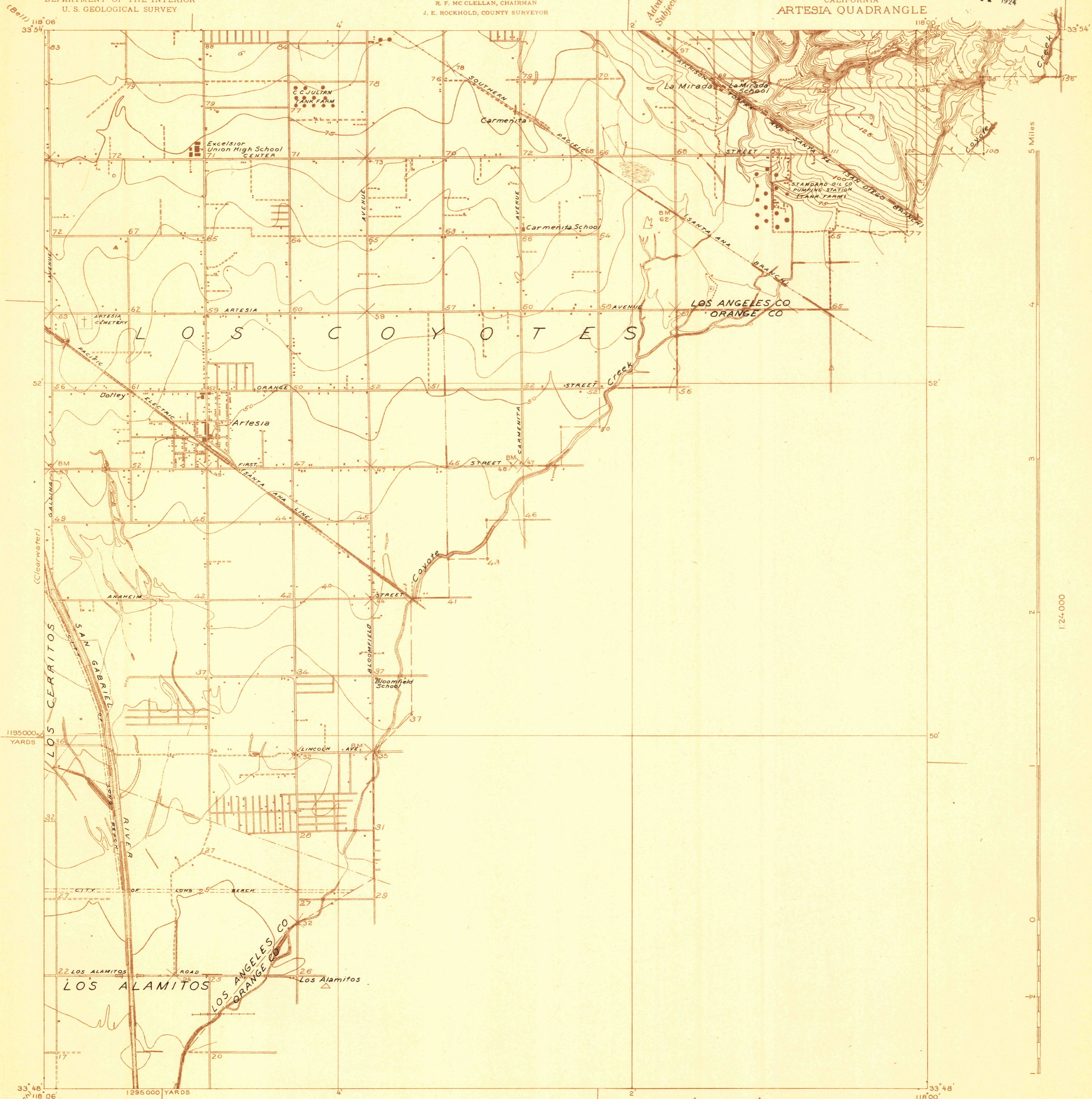

5 Miles
4
3
2
1
0
1:24,000

Topography by H. L. McDonald
Control in part by U. S. Coast and Geodetic Survey
Surveyed in 1923

TRUE NORTH
MAGNETIC NORTH

APPROXIMATE MEAN
DECLINATION, 1923

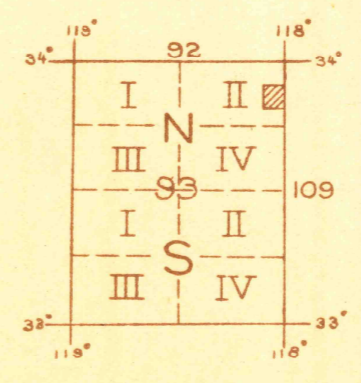
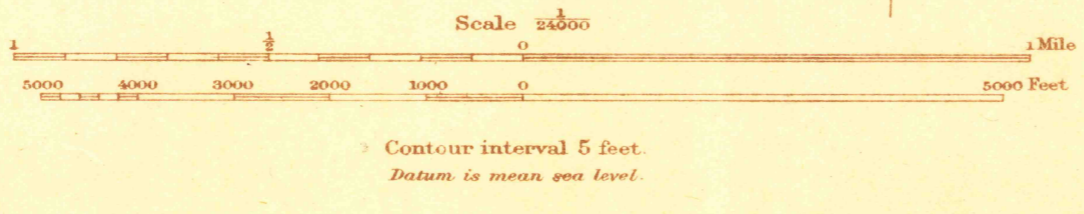

Polyconic projection. North American datum
5000 yard grid based upon U. S. zone system, G

ARTESIA, CALIF.