

Mapped, edited, and published by the Geological Survey

Control by USGS and NOS/NOAA
Topography from aerial photography by multiplex methods
Aerial photographs taken 1945. Field check, 1947
Polyconic projection. 1927 North American datum
10,000-foot grid based on California coordinate system,
Third zone
1000-meter Universal Transverse Mercator grid ticks,
zone 11, shown in blue
To place on the predicted North American Datum 1983
move the projection lines 10 meters north and
88 meters east as shown by dashed corner ticks
There may be private inholdings within the boundaries of
the National or State reservations shown on this map

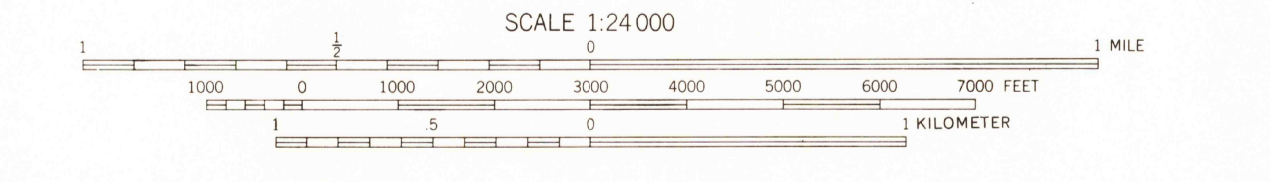
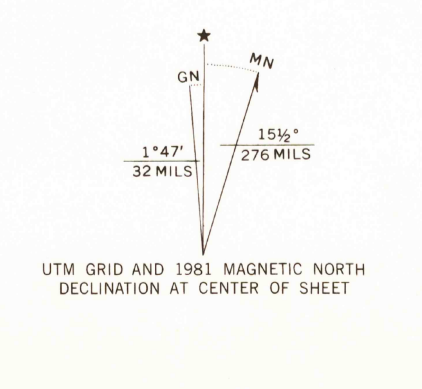

CONTOUR INTERVAL 50 FEET
NATIONAL GEODETIC VERTICAL DATUM OF 1929

THIS MAP COMPLIES WITH NATIONAL MAP ACCURACY STANDARDS
FOR SALE BY U. S. GEOLOGICAL SURVEY, DENVER, COLORADO 80225, OR RESTON, VIRGINIA 22092
A FOLDER DESCRIBING TOPOGRAPHIC MAPS AND SYMBOLS IS AVAILABLE ON REQUEST

ROAD CLASSIFICATION
Light-duty ——— Unimproved dirt - - - - -

USGS
HISTORICAL FILE
NATIONAL MAPPING DIVISION

QUADRANGLE LOCATION
Revisions shown in purple compiled from aerial photographs
taken 1978 and other source data. This information not
field checked. Map edited 1981

BEN HUR, CALIF.
SW 1/4 MARIPOSA 15' QUADRANGLE
N3715-W11952.5/7.5
PHOTOREVISED 1981
1947

JUL 23 1981
2250

DMA 2058 IV SW—SERIES V685