

U.S.G.S.  
FILE COPY  
TOPOGRAPHIC DIVISION

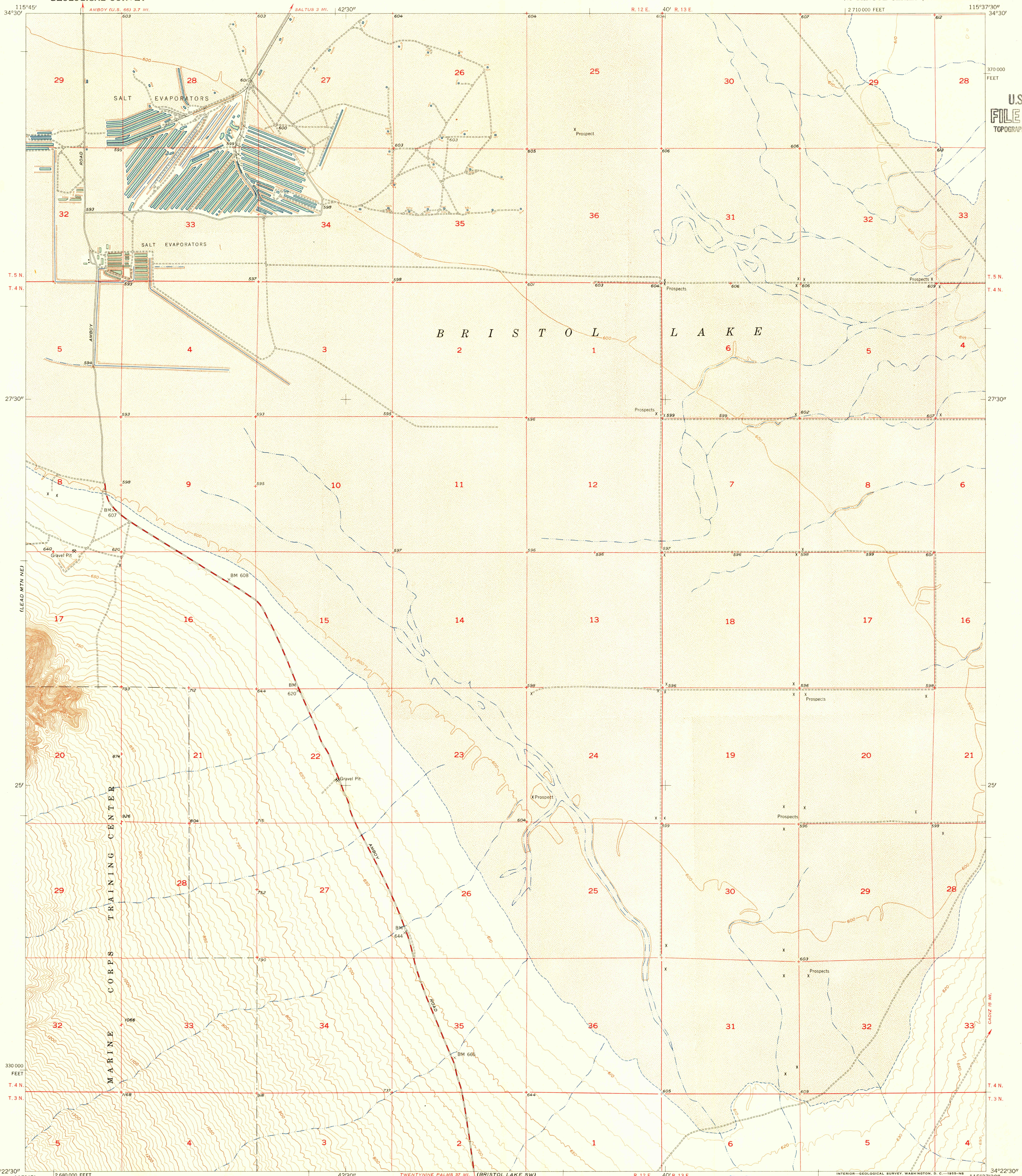

Mapped, edited, and published by the Geological Survey  
Control by USGS and USC&GS  
Topography from aerial photographs by multiplex methods  
and by plane-table surveys 1954. Aerial photographs taken 1952  
Polyconic projection. 1927 North American datum  
10,000-foot grid based on California coordinate system, zone 5

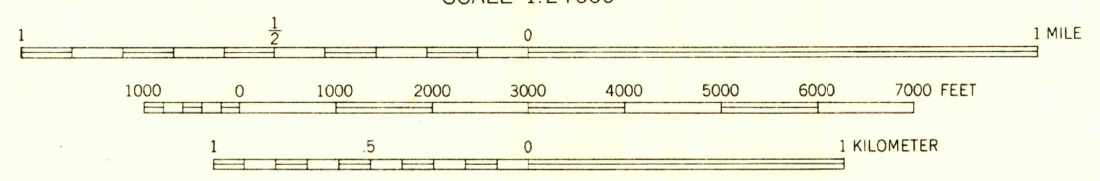
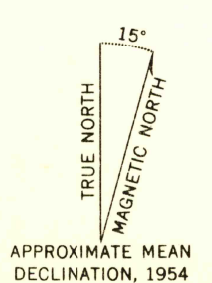

SCALE 1:24000

USCS  
Historical File  
Topographic Division

ROAD CLASSIFICATION  
Heavy-duty ——— Light-duty ———  
Medium-duty ——— Unimproved dirt ———  
U. S. Route      State Route



BRISTOL LAKE NW, CALIF.  
N 3422.5—W 11537.5/7.5

U.S.G.S.  
FILE COPY  
TOPOGRAPHIC DIVISION