

Produced by the United States Geological Survey in cooperation with California Department of Water Resources
Control by USGS, NOS/NOAA and Los Angeles City and County
Compiled from aerial photographs taken 1964. Field checked 1966
North American Datum of 1927 (NAD 27). Projection and 10000-foot ticks: California Coordinate System, zone 7 (Lambert Conformal Conic)
Blue 1000-meter Universal Transverse Mercator ticks, zone 11
North American Datum of 1983 (NAD 83) is shown by dashed corner ticks. The values of the shift between NAD 27 and NAD 83 for 7.5-minute intersections are obtainable from National Geodetic Survey NADCON software
There may be private inholdings within the boundaries of the National or State reservations shown on this map
Red tint indicates areas in which only landmark buildings are shown

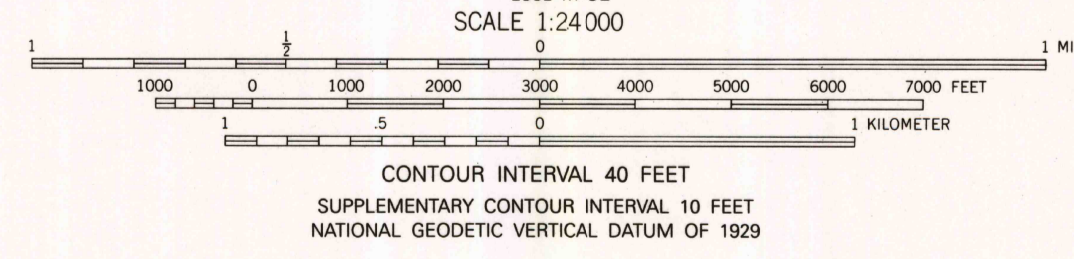
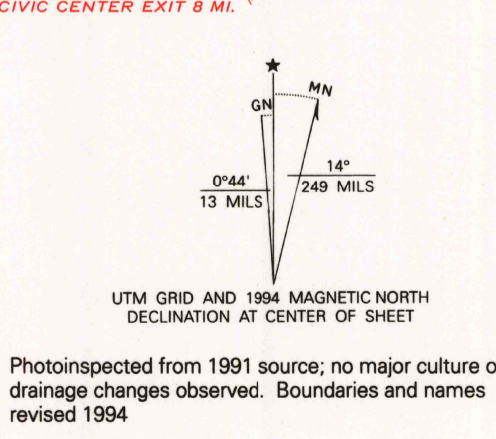

THIS MAP COMPLIES WITH NATIONAL MAP ACCURACY STANDARDS
FOR SALE BY U.S. GEOLOGICAL SURVEY
DENVER, COLORADO 80225, OR RESTON, VIRGINIA 22092
A FOLDER DESCRIBING TOPOGRAPHIC MAPS AND SYMBOLS IS AVAILABLE ON REQUEST

ROAD CLASSIFICATION

Heavy-duty	Light-duty
Medium-duty	Unimproved dirt
Interstate Route	U.S. Route
	State Route

Revisions shown in purple compiled from aerial photographs taken 1972. This information not field checked
Purple tint indicates extension of urban areas

QUADRANGLE LOCATION

BURBANK, CA
34118-B3-TF-024
1966
PHOTOREVISED 1972
MINOR REVISION 1994
DMA 2352 III NE-SERIES V895