

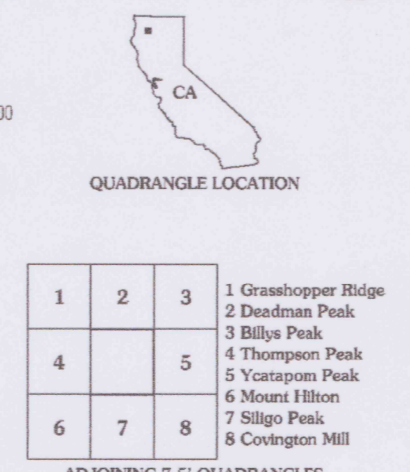

Produced by the United States Geological Survey 1986
Revision by USDA Forest Service 2001
Topography compiled 1974. Planimetry derived from imagery taken 1998 and other sources. Public Land Survey System and survey control current as of 2003. Boundaries current as of 2003
North American Datum of 1927 (NAD 27). Projection and 10 000-foot ticks: California coordinate system, zone 1 (Lambert conformal conic)
Blue 1000-meter Universal Transverse Mercator ticks, zone 10
North American Datum of 1983 (NAD 83) is shown by dashed corner ticks
The values of the shift between NAD 27 and NAD 83 for 7.5-minute intersections are obtainable from National Geodetic Survey NADCON software
Non-National Forest System lands within the National Forest Inholdings may exist in other National or State reservations
This map is not a legal land title or ownership document. Public lands are subject to change and leasing, and may have access restrictions; check with local offices. Obtain permission before entering private lands
Protracted Blocks (PB) are unsurveyed land of uncertain acreage

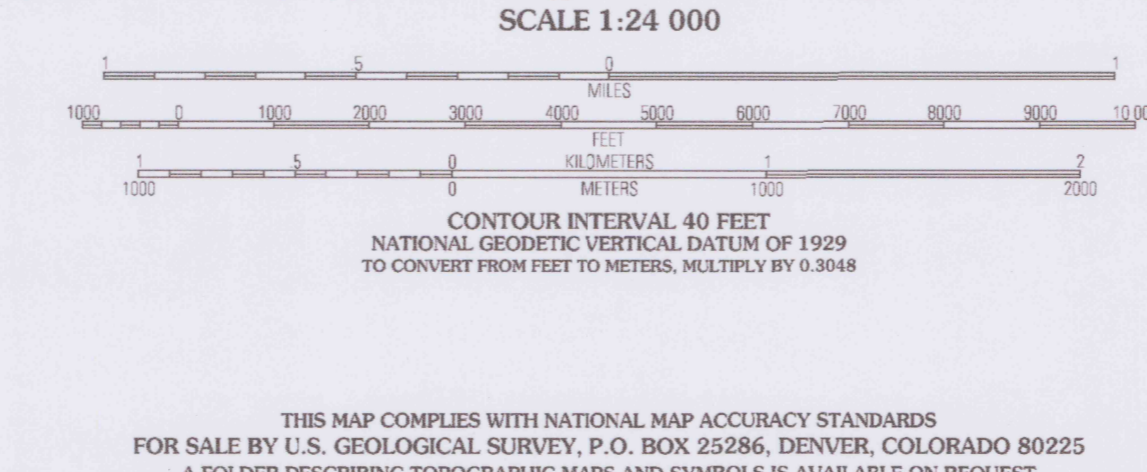
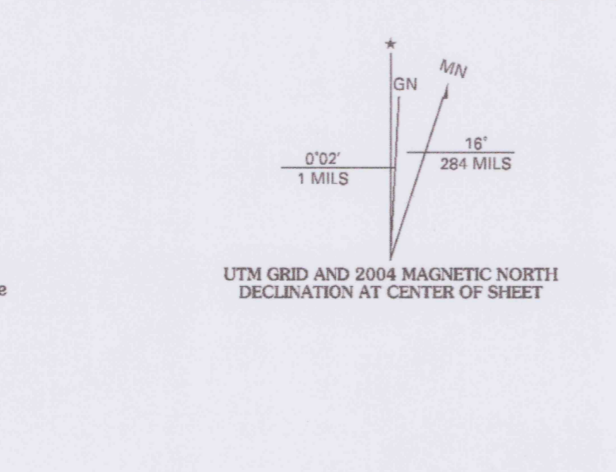

HIGHWAYS AND ROADS

Interstate	Primary highway
U. S.	Secondary highway
State	Light-duty road
County	Composition: Unspecified
National Forest, suitable for passenger cars	Paved
National Forest, suitable for high clearance vehicles	Gravel
National Forest Trail	Dirt
			Unimproved; 4 wheel drive
			Trail
			Gate; Barrier

ADJOINING 7.5' QUADRANGLES

1	2	3	1 Grasshopper Ridge
			2 Deadman Peak
			3 Billy Peak
4	5	4 Thompson Peak	
			5 Ycarapans Peak
			6 Mount Ribbon
			7 Sillgo Peak
6	7	8	8 Covington Mill

CARIBOU LAKE, CA
2001
41122-A8-TF-024
NIMA 1466 III SW-SERIES V895

REFERENCE
REF 3700s
VAR 105
7.5
ed. 2001
rep. 2004