

Advance sheet  
Subject to correction

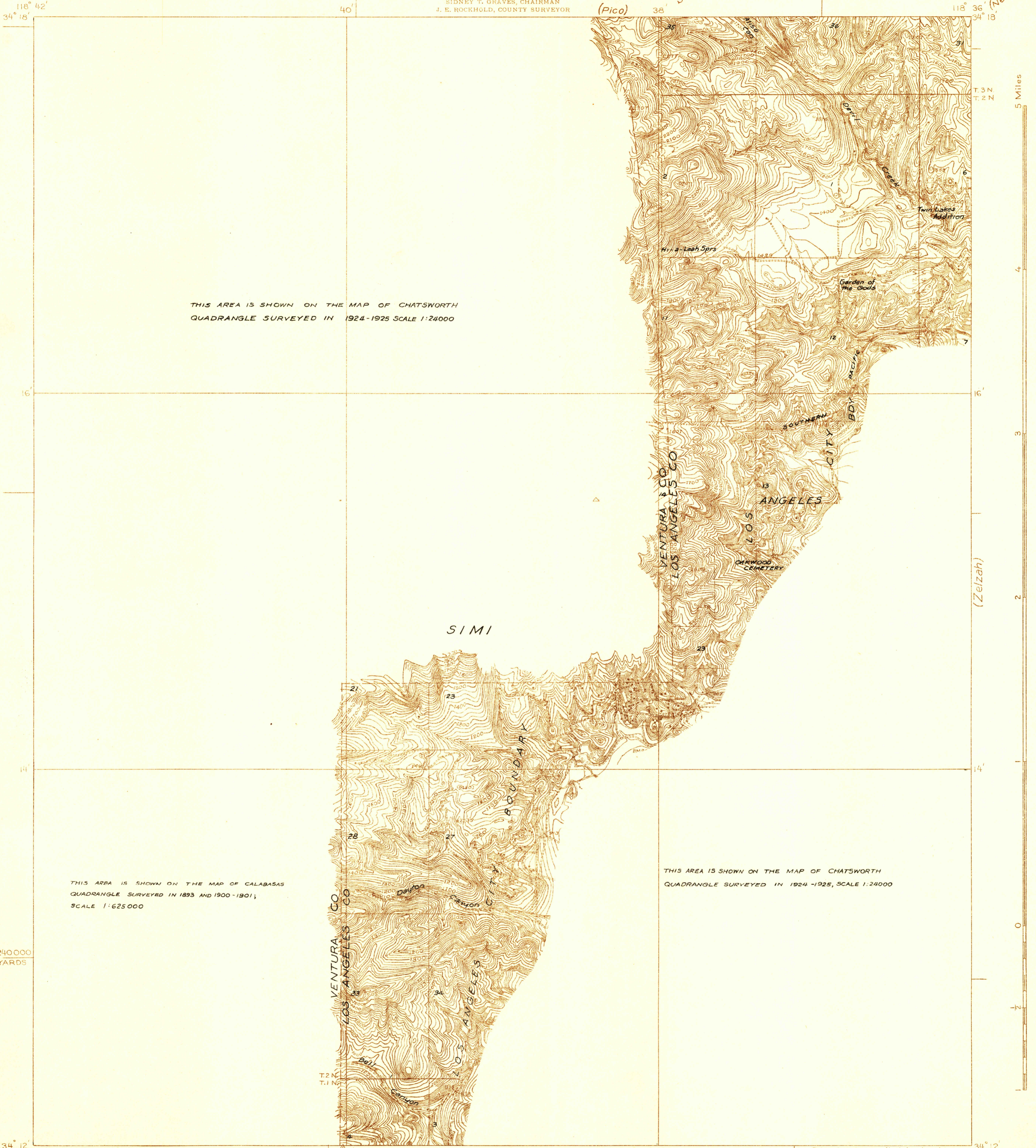

THIS AREA IS SHOWN ON THE MAP OF CHATSWORTH  
QUADRANGLE SURVEYED IN 1924-1925 SCALE 1:24000

THIS AREA IS SHOWN ON THE MAP OF CALABASAS  
QUADRANGLE SURVEYED IN 1893 AND 1900-1901;  
SCALE 1:625000

THIS AREA IS SHOWN ON THE MAP OF CHATSWORTH  
QUADRANGLE SURVEYED IN 1924-1925, SCALE 1:24000

1240000  
YARDS

1235000  
YARDS

(Dry Canyon)  
Scale 1/24,000

Polyconic projection. North American datum  
5000 yard grid based upon U. S. zone system, G 118° 36' (Reseda)

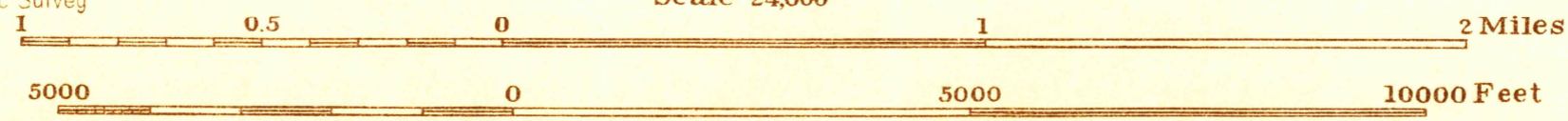

Contour interval 5 feet and 25 feet, (see diagram)  
Datum is mean sea level

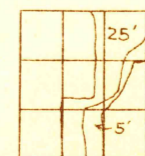

CHATSWORTH, CALIF.

TRUE NORTH  
MAGNETIC NORTH  
APPROXIMATE MEAN  
DECLINATION, 1929

118° 42' H.H. Hodgeson, Division Engineer  
Topography by L.O. Newsome  
Control by U. S. Geological Survey and U. S. Coast and Geodetic Survey  
Surveyed in 1929