

UNITED STATES  
DEPARTMENT OF THE INTERIOR  
GEOLOGICAL SURVEY

CHIDAGO CANYON QUADRANGLE  
CALIFORNIA—MONO. CO.  
7.5 MINUTE SERIES (TOPOGRAPHIC)

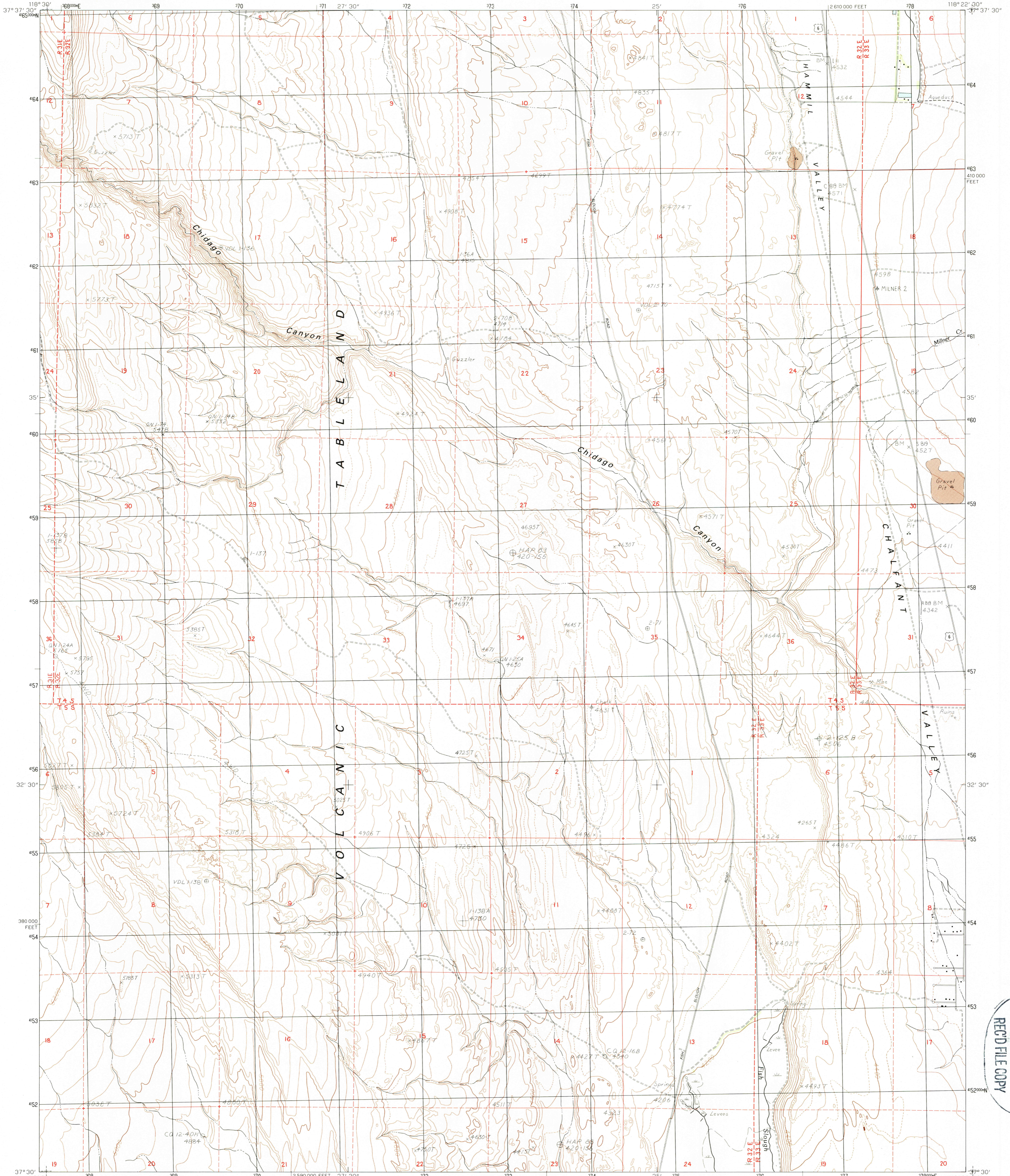

USGS NHD HISTORICAL MAP  
FEB - 1988  
REC'D FILE COPY

PRODUCED BY THE UNITED STATES GEOLOGICAL SURVEY  
CONTROL BY USGS, NGS, NOAA  
COMPILED FROM AERIAL PHOTOGRAPHS TAKEN 1954  
FIELD CHECKED 1962  
LIMITED REVISION FROM AERIAL PHOTOGRAPHS TAKEN 1987  
FIELD CHECKED 1987  
PROJECTION LAMBERT CONFORMAL CONIC  
GRID: 1000-METER UNIVERSAL TRANSVERSE MERCATOR, ZONE 11  
10,000-FOOT STATE GRID TICKS CALIFORNIA, ZONE 3  
UTM GRID DECLINATION 1957 WEST  
1980 MAGNETIC NORTH DECLINATION 15'30" EAST  
VERTICAL DATUM NATIONAL GEODETIC VERTICAL DATUM OF 1929  
HORIZONTAL DATUM 1927 NORTH AMERICAN DATUM  
To place on the predicted North American Datum of 1983,  
move the projection lines as shown by dashed corner ticks  
(10 meters north and 83 meters east)  
There may be private inholdings within the boundaries of any  
Federal and State Reservations shown on this map  
Public Land Survey System is shown as published in 1962 and  
verified or supplemented in 1985

**PROVISIONAL MAP**  
Produced from original  
manuscript drawings. Information  
shown as of date of  
field check.

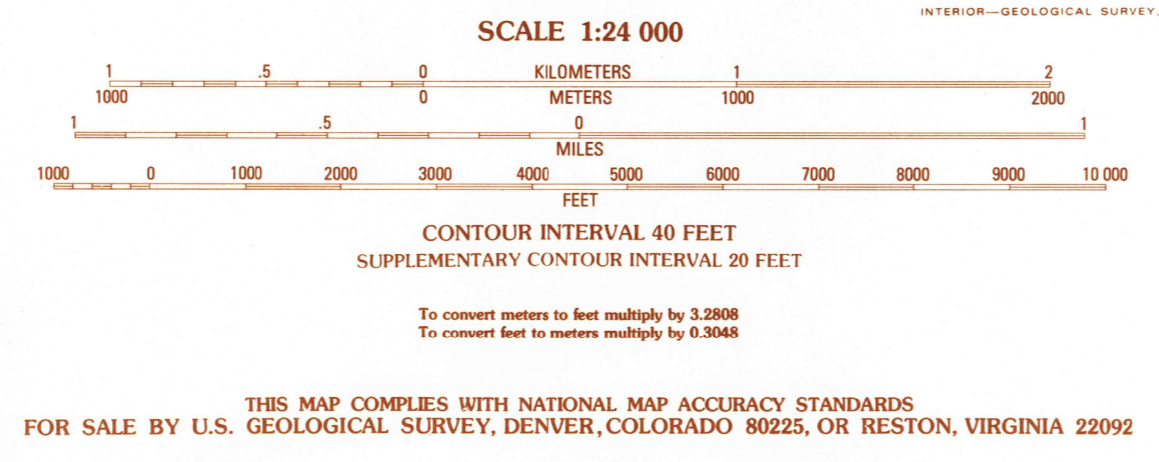

ROAD LEGEND

Improved Road  
Unimproved Road  
Trail

Interstate Route U.S. Route State Route

QUADRANGLE LOCATION

|   |   |   |
|---|---|---|
| 1 | 2 | 3 |
| 4 | 5 | 6 |
| 7 | 8 | 9 |

1 Banner Ridge  
2 Hammil Valley  
3 White Min. Peak  
4 Casa Diablo Min.  
5 Chalfant Valley  
6 Rovana  
7 Fish Slough  
8 Laws

CHIDAGO CANYON, CALIF.  
PROVISIONAL EDITION 1987  
87118-E4-TF-024