

Produced by the United States Geological Survey in cooperation with California Department of Water Resources
Control by USGS and NOS/NOAA
Compiled from aerial photographs taken 1959. Field checked 1958
Hydrography compiled from NOS/NOAA data
North American Datum of 1927 (NAD 27). Projection and 10,000-foot ticks: California Coordinate System, zone 2 (Lambert Conformal Conic)
Blue 1000-meter Universal Transverse Mercator ticks, zone 10
North American Datum of 1983 (NAD 83) is shown by dashed corner ticks. The values of the shift between NAD 27 and NAD 83 for 7.5-minute intersections are obtainable from National Geodetic Survey NADCON software
There may be private inholdings within the boundaries of the National or State reservations shown on this map

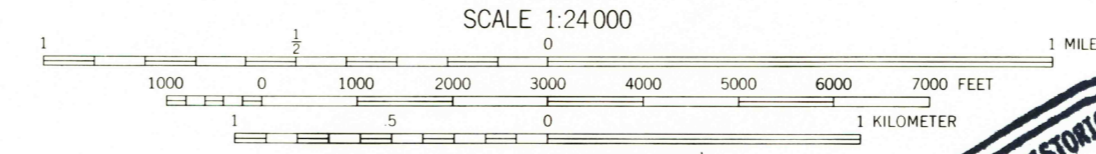

CONTOUR INTERVAL 40 FEET
SUPPLEMENTARY CONTOUR INTERVAL 20 FEET
NATIONAL GEODETIC VERTICAL DATUM OF 1929
DEPTH CURVES IN FEET BASED ON LAKE ELEVATION 1319 FEET
THIS MAP COMPLIES WITH NATIONAL MAP ACCURACY STANDARDS
FOR SALE BY U.S. GEOLOGICAL SURVEY
DENVER, COLORADO 80225, OR RESTON, VIRGINIA 22092
A FOLDER DESCRIBING TOPOGRAPHIC MAPS AND SYMBOLS IS AVAILABLE ON REQUEST

USGS AND HISTORICAL
MAP ARCHIVES
JAN 03 1995
REC'D FILE COPY

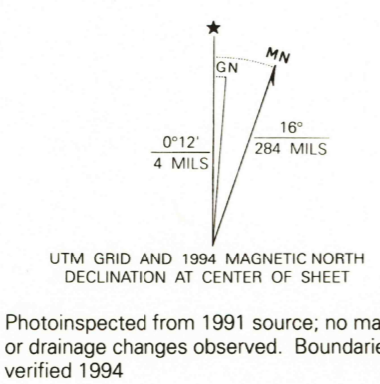

ROAD CLASSIFICATION

Primary highway, hard surface	Light-duty road, hard or improved surface
Secondary highway, hard surface	Unimproved road
Interstate Route	U. S. Route
	State Route

CLEARLAKE OAKS, CA
39122-A6-TF-024
1958
PHOTOREVISED 1975
MINOR REVISION 1994
DMA 1462 II SW-SERIES V895