

UNITED STATES
DEPARTMENT OF THE INTERIOR
GEOLOGICAL SURVEY

COIT RANCH QUADRANGLE
CALIFORNIA—FRESNO CO.
7.5 MINUTE SERIES (TOPOGRAPHIC)
NW/4 TRANQUILITY 15' QUADRANGLE

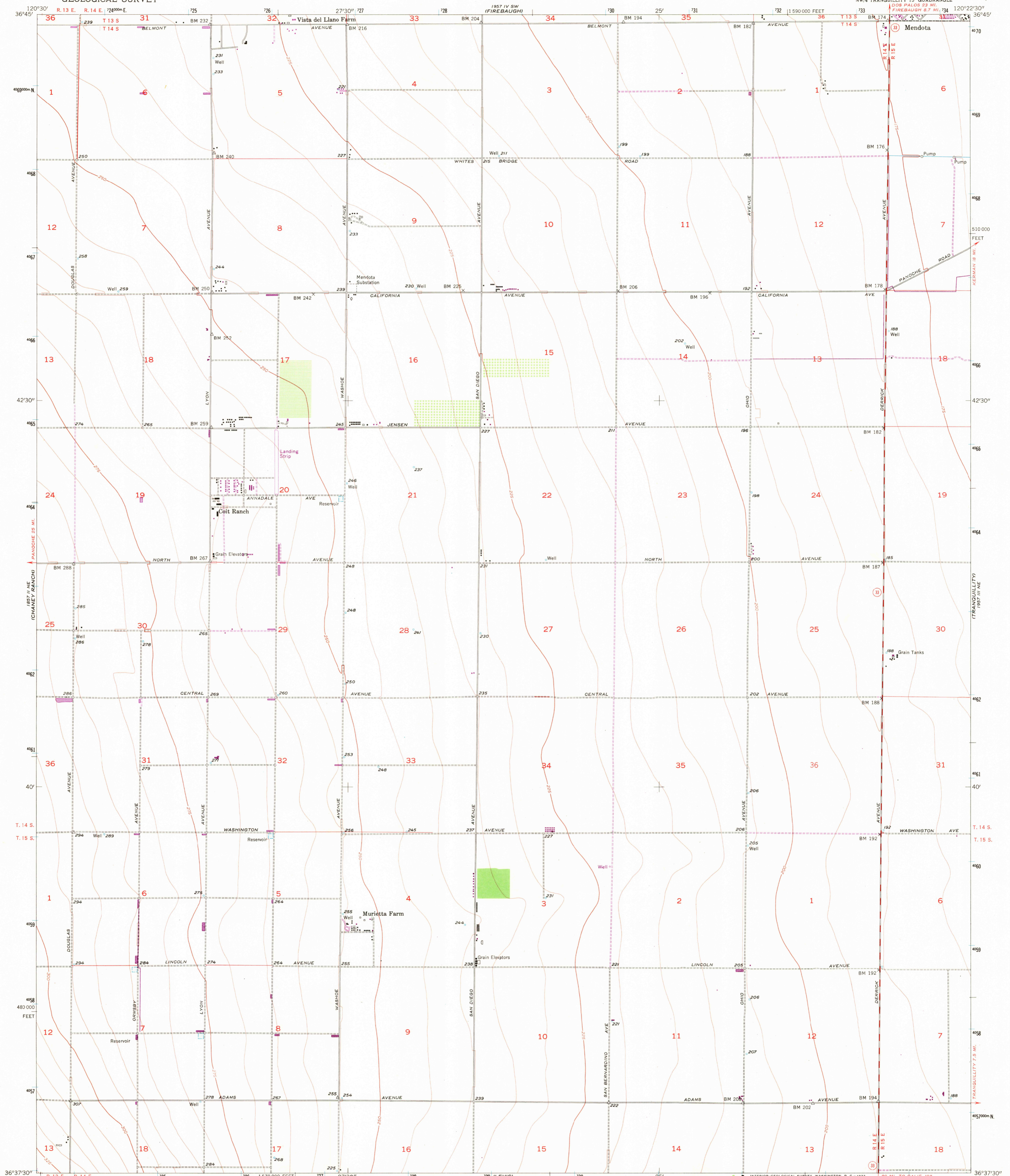

Mapped, edited, and published by the Geological Survey
Control by USGS and USC&GS
Culture and drainage compiled from aerial photographs
taken 1955. Topography by planetable surveys 1956
Polyconic projection, 1927 North American datum
10,000-foot grid based on California coordinate system, zone 4
1000-meter Universal Transverse Mercator
grid ticks, zone 10, shown in blue
This map lies within a subsidence area
Contouring based on 1955 adjustment of vertical control
Revisions shown in purple compiled from aerial photographs
taken 1971. This information not field checked

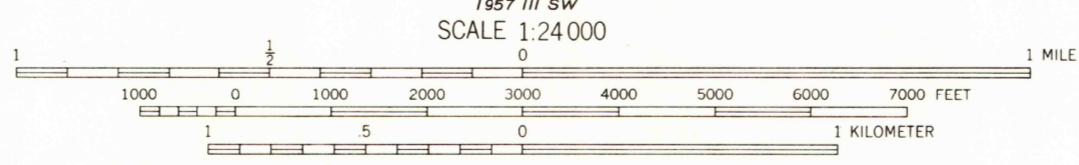
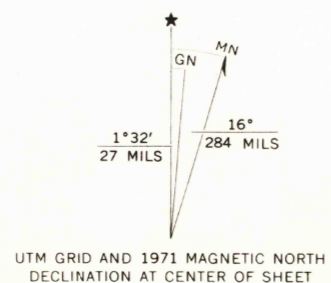

CONTOUR INTERVAL 5 FEET
DATUM IS MEAN SEA LEVEL

THIS MAP COMPLIES WITH NATIONAL MAP ACCURACY STANDARDS
FOR SALE BY U. S. GEOLOGICAL SURVEY, DENVER, COLORADO 80225, OR WASHINGTON, D. C. 20242
A FOLDER DESCRIBING TOPOGRAPHIC MAPS AND SYMBOLS IS AVAILABLE ON REQUEST



COIT RANCH, CALIF.
NW/4 TRANQUILITY 15' QUADRANGLE
N 3637.5—W 12022.5/7.5

1956
PHOTOREVISED 1971
AMS 1957 III NW—SERIES V895

USGS
HISTORICAL FILE
TOPOGRAPHIC DIVISION