

2454 I NW 1968 PP

UNITED STATES DEPARTMENT OF THE INTERIOR GEOLOGICAL SURVEY

EL PASO PEAKS QUADRANGLE CALIFORNIA 7.5 MINUTE SERIES (TOPOGRAPHIC) NW/4 RANDBURG 15 QUADRANGLE

2454 I NW 1968 PP

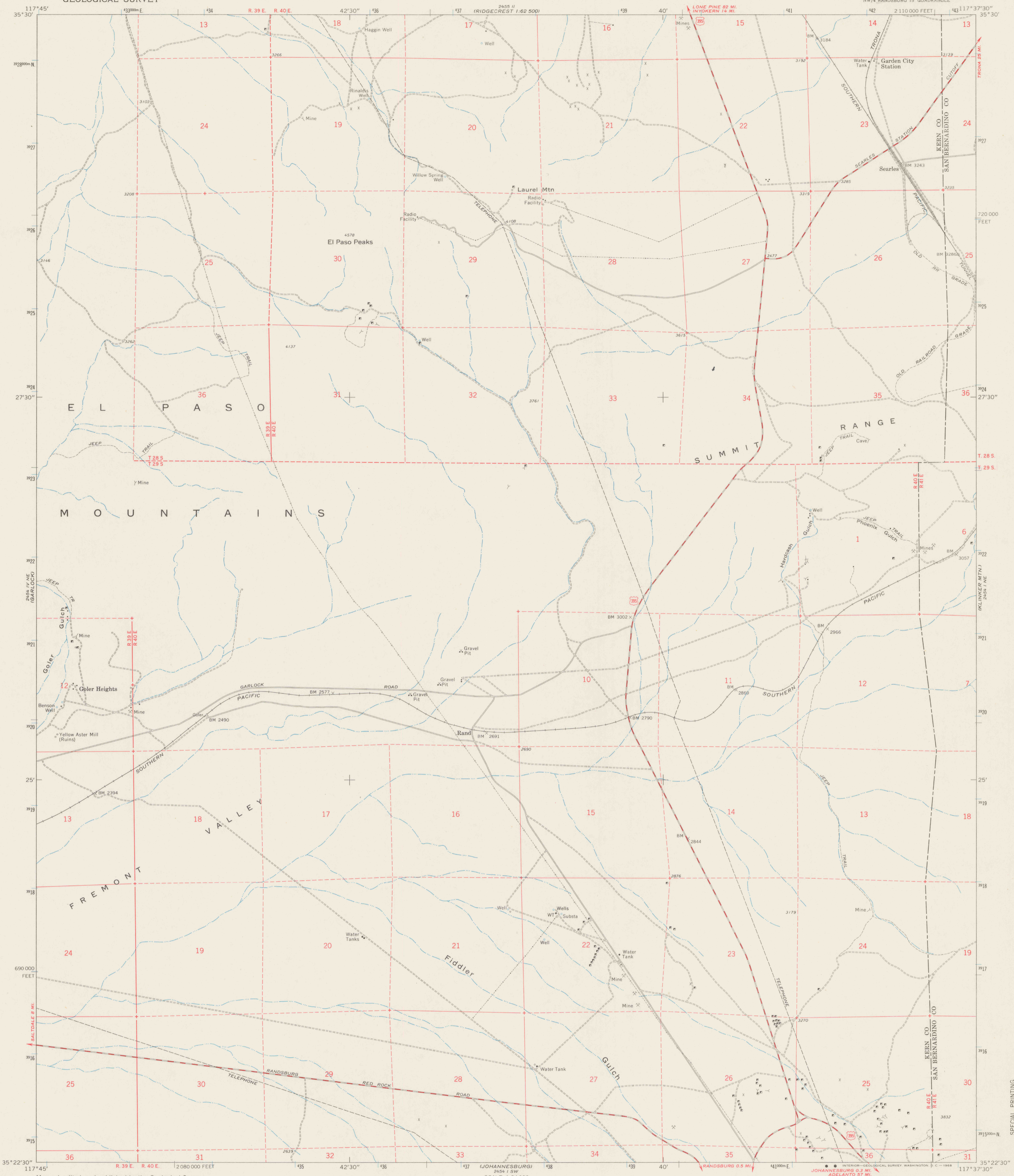

Mapped, edited, and published by the Geological Survey Control by USGS and USC&GS. Topography by photogrammetric methods from aerial photographs taken 1965. Field checked 1967. Polyconic projection. 1927 North American datum 10,000-foot grid based on California coordinate system, zone 5 1000-meter Universal Transverse Mercator grid ticks, zone 11, shown in blue. Where omitted, land lines have not been established or are not shown because of insufficient data.

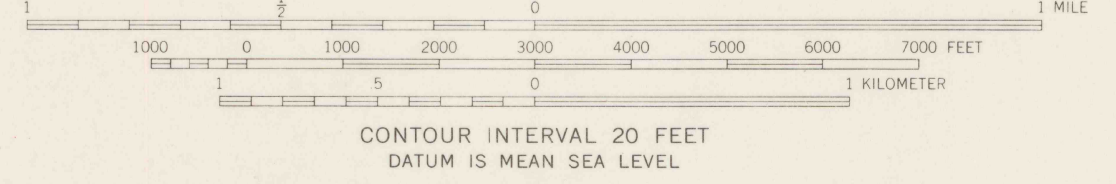
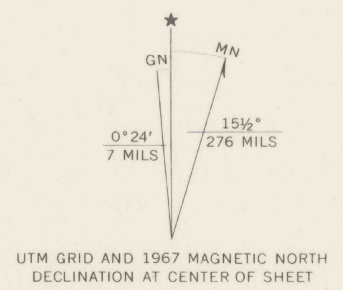

ROAD CLASSIFICATION: Medium-duty, Light-duty, Unimproved dirt, U.S. Route.

REFERENCE: REF 3700s, EL PASO PEAKS, CALIF. NW/4 RANDBURG 15 QUADRANGLE N3522.5-W11737.5/7.5 1967 AMS 2454 I NW-SERIES V895

THIS MAP COMPLIES WITH NATIONAL MAP ACCURACY STANDARDS FOR SALE BY U.S. GEOLOGICAL SURVEY, DENVER, COLORADO 80225, OR WASHINGTON, D.C. 20242 A FOLDER DESCRIBING TOPOGRAPHIC MAPS AND SYMBOLS IS AVAILABLE ON REQUEST

DO NOT CIRCULATE

SPECIAL PRINTING Contours and woodland symbols omitted

RED MOUNTAIN