

U.S.G.S.  
FILE COPY  
Inspection and Editing.

UNITED STATES  
DEPARTMENT OF THE INTERIOR  
GEOLOGICAL SURVEY

STATE OF CALIFORNIA  
COUNTY OF LOS ANGELES  
C.E. ARNOLD COUNTY ENGINEER AND SURVEYOR  
R.13 W. 2358 (ELIZABETH LAKE 1:25000)

ESPERANZA SCHOOL QUADRANGLE  
CALIFORNIA-LOS ANGELES COUNTY  
6-MINUTE SERIES (TOPOGRAPHIC)

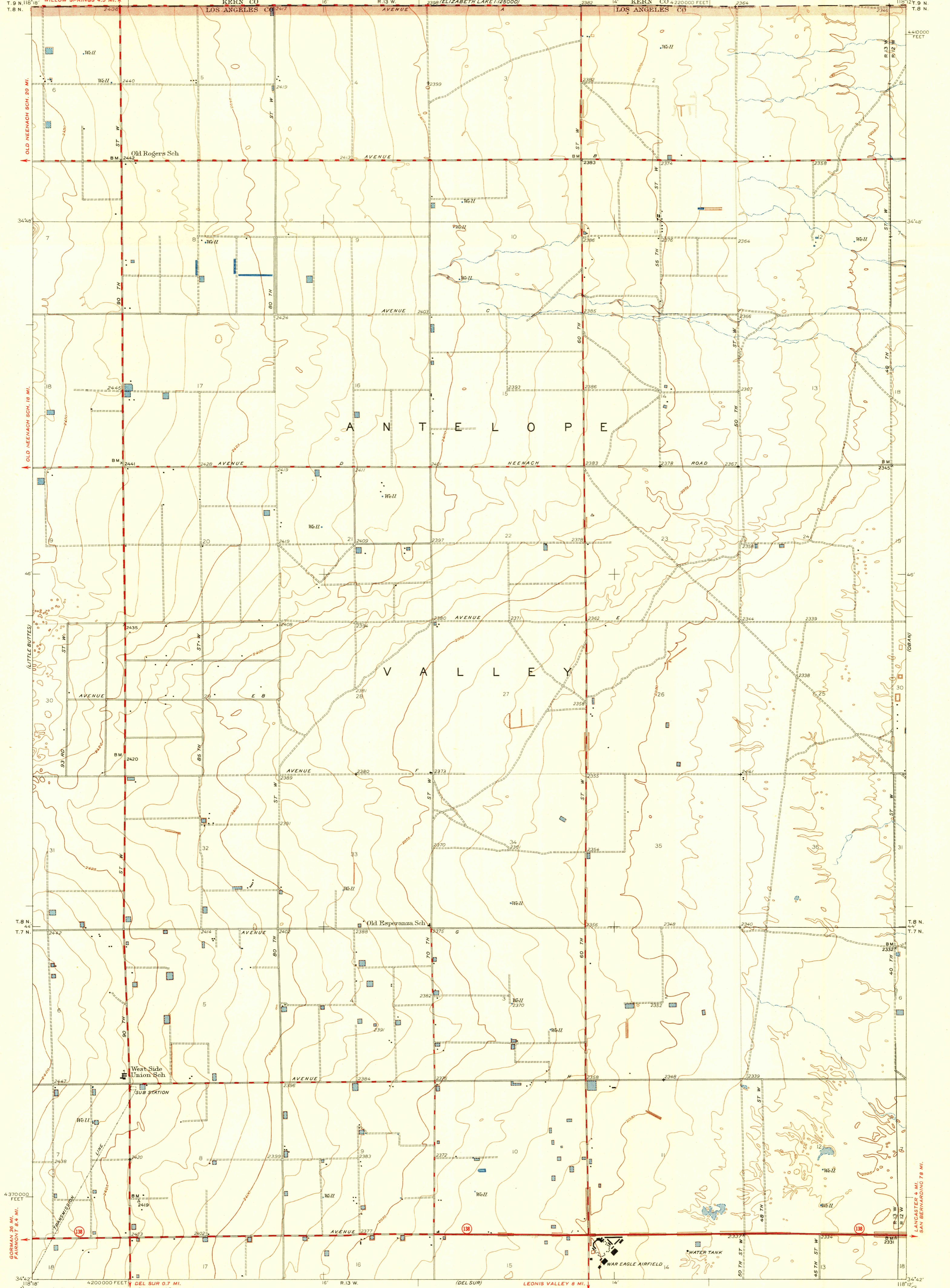

Mapped, edited and published by the Geological Survey  
Control by USGS  
Topography by plane-table methods 1931  
Polyconic projection: North American datum  
10000-foot grid based on California coordinate system, zone 7  
Culture revised in 1950 by  
Los Angeles County (T.H. Mancure)

APPROXIMATE MEAN  
DECLINATION 1950

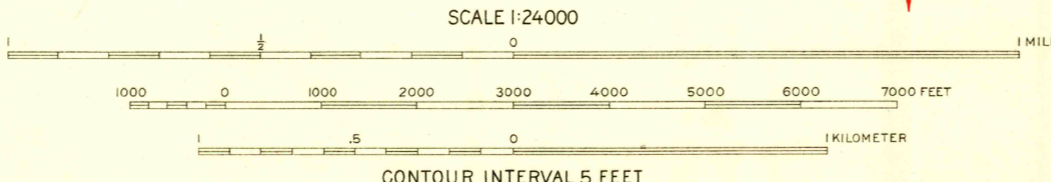

ROAD CLASSIFICATION  
HEAVY-DUTY ALL WEATHER ROADS DRY WEATHER ROADS  
IMPROVED DIRT  
MEDIUM-DUTY ALL WEATHER ROADS UNIMPROVED DIRT  
LOOSE-SURFACE GRADED OR NARROW HARD-SURFACE  
U.S. ROUTE STATE ROUTE

THIS MAP COMPLIES WITH NATIONAL MAP ACCURACY STANDARDS  
FOR SALE BY U.S. GEOLOGICAL SURVEY, FEDERAL CENTER, DENVER, COLORADO OR WASHINGTON 25, D.C.  
A FOLDER DESCRIBING TOPOGRAPHIC MAPS AND SYMBOLS IS AVAILABLE ON REQUEST

USGS  
Historical File  
Topographic Division

ESPERANZA SCHOOL, CALIF  
EDITION OF 1951  
N3442-W1182/7.2x6

U.S.G.S.  
FILE COPY  
Inspection and Editing.

HISTORICAL  
AUG 9 1961 3040