

Mapped, edited, and published by the Geological Survey
Control by USGS and USC&GS
Topography by photogrammetric methods from aerial
photographs taken 1967. Field checked 1968
Supersedes map surveyed 1913, revised 1953
Polyconic projection. 1927 North American datum
10,000-foot grid based on California coordinate system, zone 3
1000-meter Universal Transverse Mercator grid ticks,
zone 10, shown in blue
Fine red dashed lines indicate selected fence lines
Areas covered by dashed light-blue pattern are subject
to controlled inundation

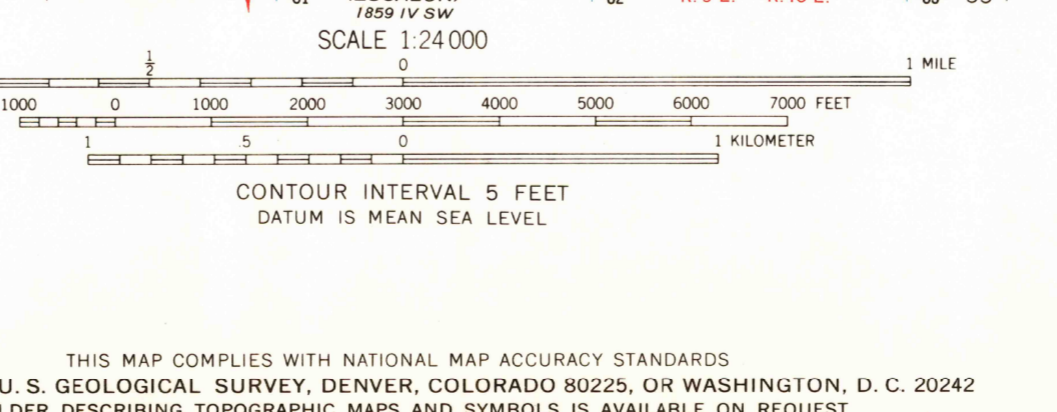
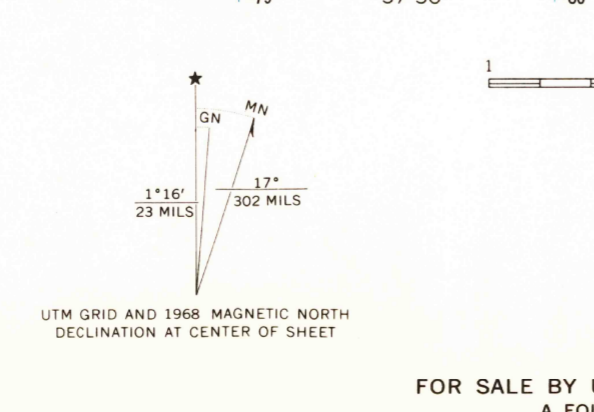

ROAD CLASSIFICATION

Secondary highway, all weather, hard surface	Light-duty road, all weather, improved surface
Unimproved road, fair or dry weather	State Route

USGS HISTORICAL FILE TOPOGRAPHIC DIVISION

FARMINGTON, CALIF.
N3752.5-W12052.5/7.5

1968

AMS 1859 IV NW-SERIES V895

4040

AUG 6 1977

THIS MAP COMPLIES WITH NATIONAL MAP ACCURACY STANDARDS
FOR SALE BY U.S. GEOLOGICAL SURVEY, DENVER, COLORADO 80225, OR WASHINGTON, D. C. 20242
A FOLDER DESCRIBING TOPOGRAPHIC MAPS AND SYMBOLS IS AVAILABLE ON REQUEST