

FILE COPY
Inspection and Editing

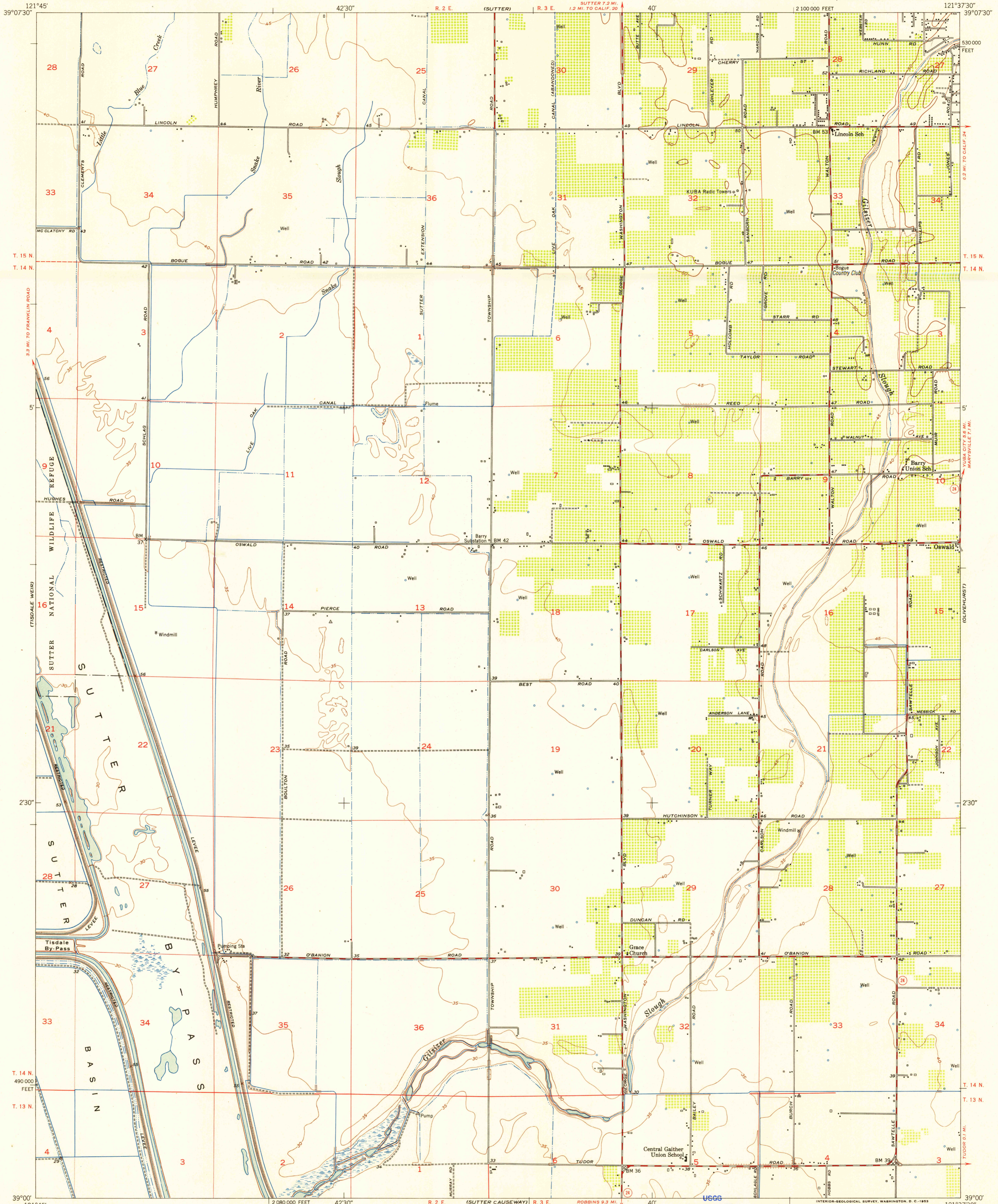

Mapped, edited, and published by the Geological Survey
Control by USGS and USC&GS
Mapped 1909, remapped 1952
Culture and drainage from photo mosaic by USBR
Aerial photographs taken 1949
Topography from plane-table surveys by USGS 1952
Polyconic projection. 1927 North American datum
10,000-foot grid based on California coordinate system, zone 2
Dotted land lines established by private survey

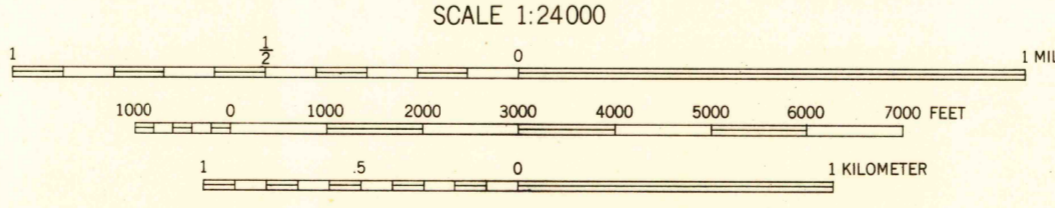
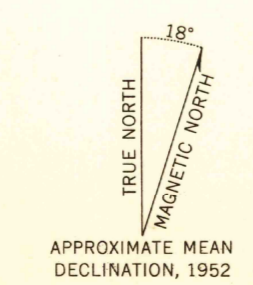

CONTOUR INTERVAL 5 FEET
CONTOURS INCOMPLETE ALONG EMBANKMENTS AND DITCHES
DATUM IS MEAN SEA LEVEL

THIS MAP COMPLIES WITH NATIONAL MAP ACCURACY STANDARDS
FOR SALE BY U. S. GEOLOGICAL SURVEY, FEDERAL CENTER, DENVER, COLORADO OR WASHINGTON 25, D. C.
A FOLDER DESCRIBING TOPOGRAPHIC MAPS AND SYMBOLS IS AVAILABLE ON REQUEST

USGS
Historical File
Topographic Division

ROAD CLASSIFICATION

Heavy-duty	4 LANE 15 LANE	Light-duty
Medium-duty	4 LANE 15 LANE	Unimproved dirt

U. S. Route State Route



FILE COPY
Inspection and Editing

GILSIZER SLOUGH, CALIF.
SW/4 MARYSVILLE 15' QUADRANGLE
N3900-W12137.5/7.5

1952

JUN 4 1953
8880