

DEPARTMENT OF THE INTERIOR
U. S. GEOLOGICAL SURVEY

108-S-111-PART OF
LOS ANGELES COUNTY, CALIFORNIA
BOARD OF SUPERVISORS
R. F. M^c CLELLAN, CHAIRMAN
J. E. ROCKHOLD, COUNTY SURVEYOR

CALIFORNIA
(LOS ANGELES COUNTY)
GLENDDORA QUADRANGLE

Advance sheet
Subject to correction

117° 54'
34° 10'

R 10 W R 9 W 52'

50'

117° 48'
34° 10'

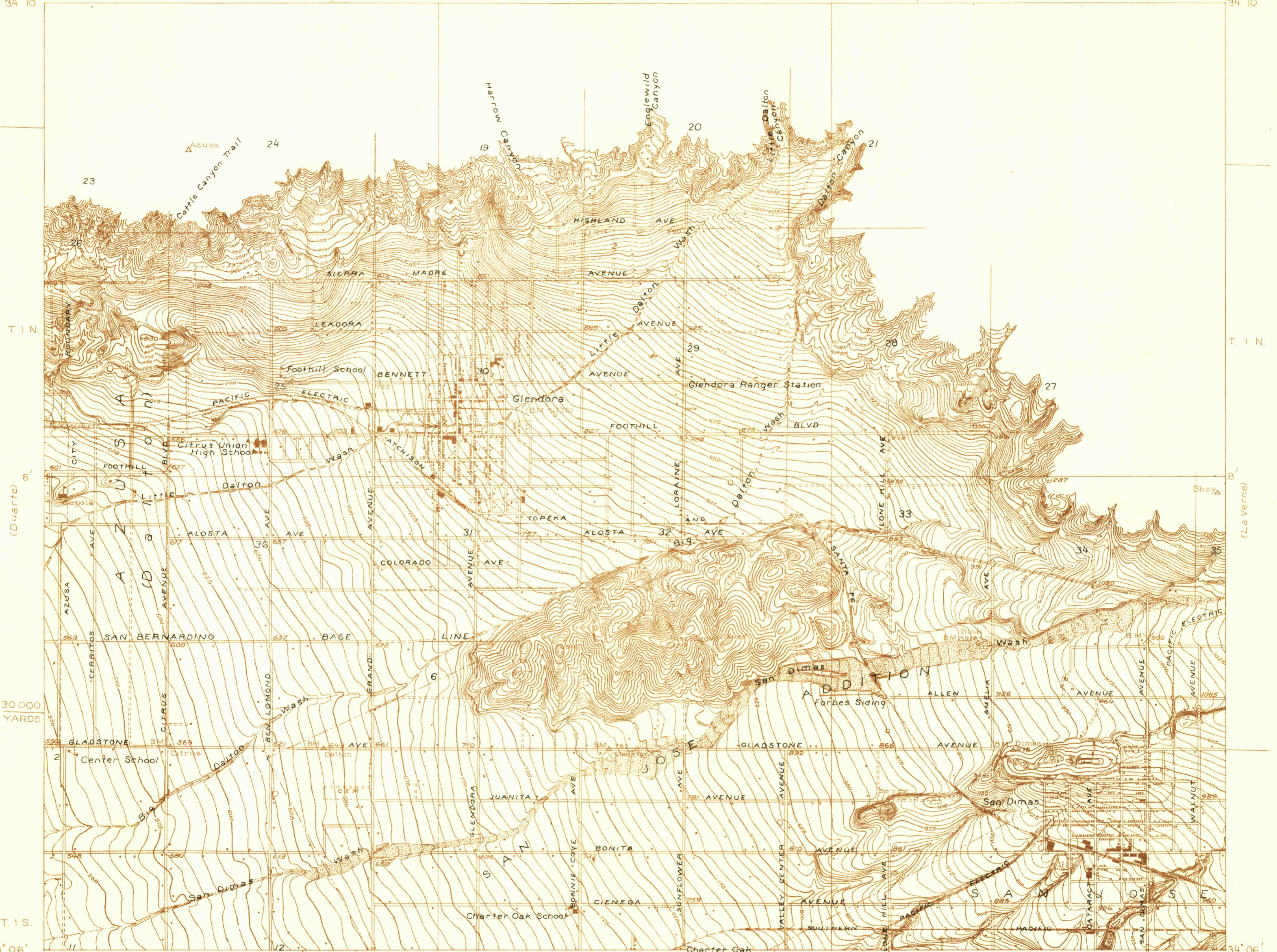

1230 000
YARDS

T. 1 S.

34° 06'

Topography by CWH Nessler
Control by U. S. Geological Survey
Surveyed in 1925

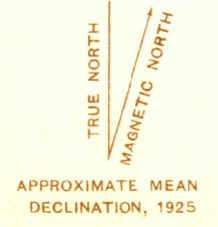

Scale 24,000

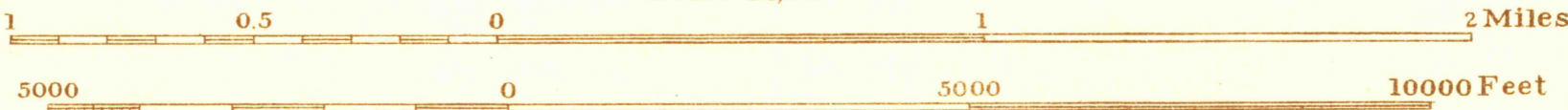

Contour interval 5 feet
Datum is mean sea level

Polyconic projection. North American datum
5000 yard grid based upon U. S. zone system, G

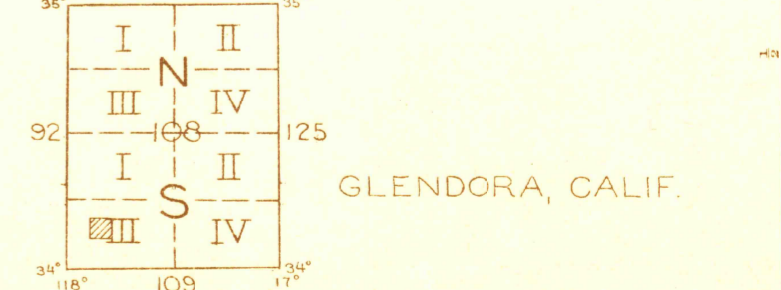

GLENDDORA, CALIF.