

UNITED STATES
DEPARTMENT OF THE INTERIOR
GEOLOGICAL SURVEY

LUCERNE VALLEY QUADRANGLE
CALIFORNIA-SAN BERNARDINO CO.
7.5 MINUTE SERIES (TOPOGRAPHIC)

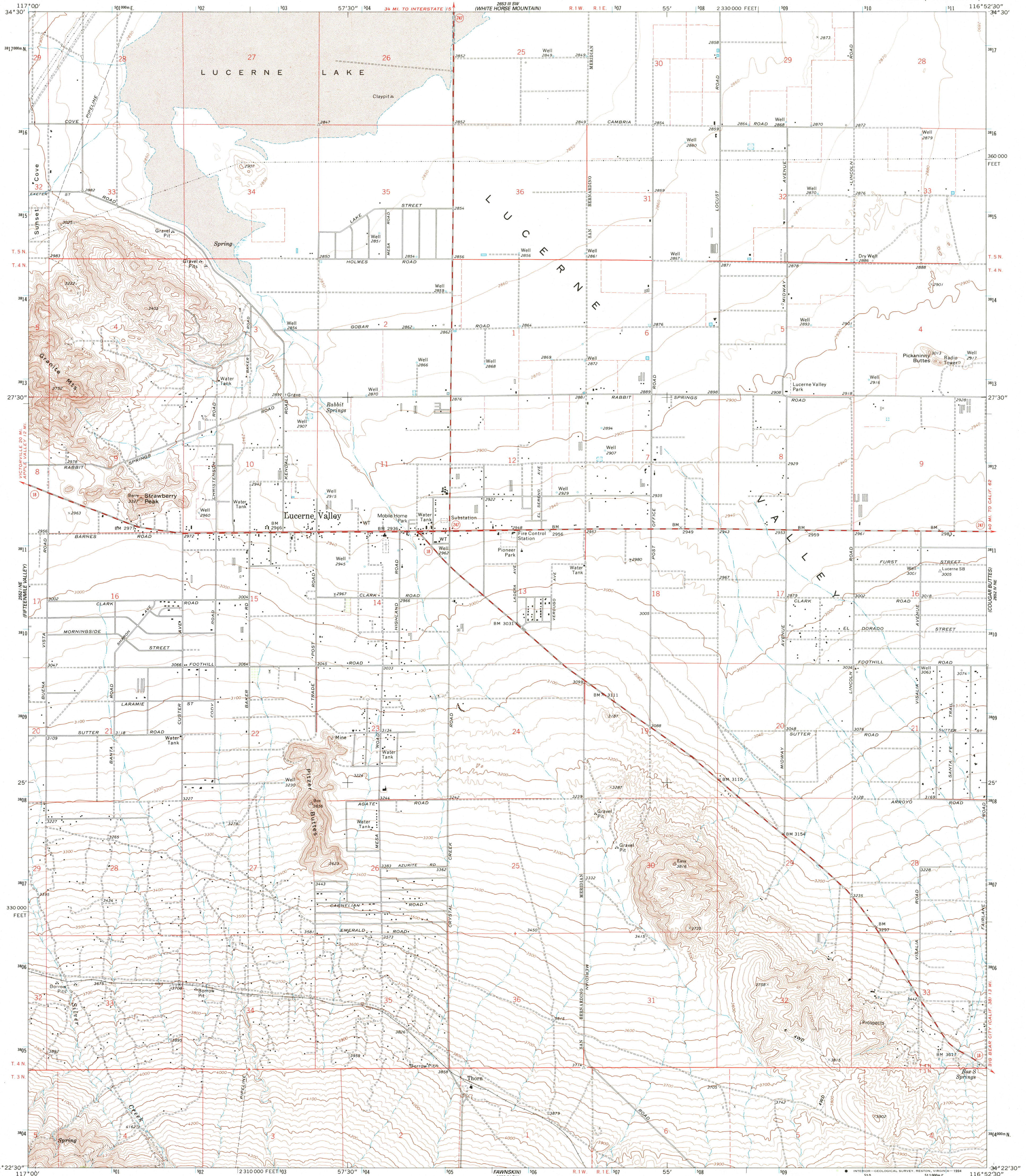

Produced by the United States Geological Survey in cooperation with California Department of Water Resources
Control by USGS and NOS/NOAA
Compiled from aerial photographs taken 1969. Field checked 1971
North American Datum of 1927 (NAD 27). Projection and 1000-foot ticks: California Coordinate System, zone 5 (Lambert Conformal Conic)
Blue 1000-meter Universal Transverse Mercator ticks, zone 11
North American Datum of 1983 (NAD 83) is shown by dashed corner ticks. The values of the shift between NAD 27 and NAD 83 for 7.5-minute intersections are obtainable from National Geodetic Survey NADCON software
Fine red dashed lines indicate selected fence lines
Where omitted, land lines have not been established
Photinspected from 1989 source; no major culture or drainage changes observed. Names revised 1994

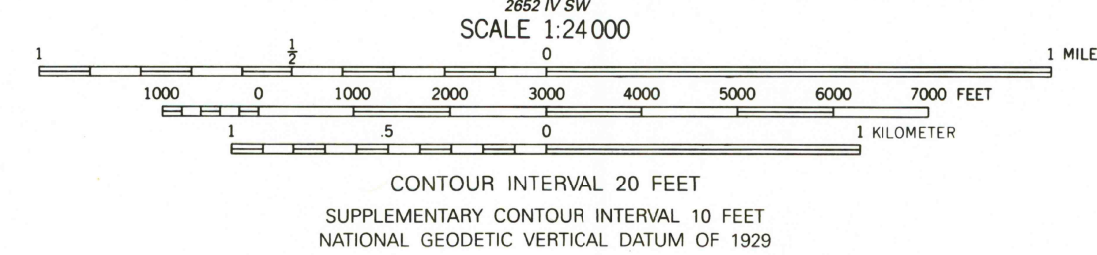
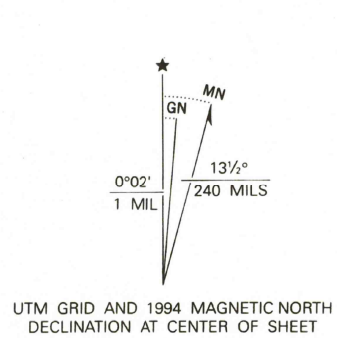

THIS MAP COMPLIES WITH NATIONAL MAP ACCURACY STANDARDS
FOR SALE BY U. S. GEOLOGICAL SURVEY, DENVER, COLORADO 80225, OR RESTON, VIRGINIA 22092
A FOLDER DESCRIBING TOPOGRAPHIC MAPS AND SYMBOLS IS AVAILABLE ON REQUEST

ROAD CLASSIFICATION

Primary highway, hard surface	Light-duty road, hard or improved surface
Secondary highway, hard surface	Unimproved road
Interstate Route	U. S. Route
	State Route

QUADRANGLE LOCATION

USGS NHD HISTORICAL MAP ARCHIVES
OCT 12 1994
REC'D FILE COPY

LUCERNE VALLEY, CA
34116-08-TF-024
1971
MINOR REVISION 1994
DMA 2652 IV NW-SERIES V895