

FAIRVIEW VALLEY  
2852 III SE  
2853 III SE



U.S. DEPARTMENT OF THE INTERIOR  
U.S. GEOLOGICAL SURVEY

LUCERNE VALLEY QUADRANGLE  
CALIFORNIA—SAN BERNARDINO CO.  
7.5 MINUTE SERIES (TOPOGRAPHIC)

2853 III SE  
2852 III SE  
GRAND VIEW MINE

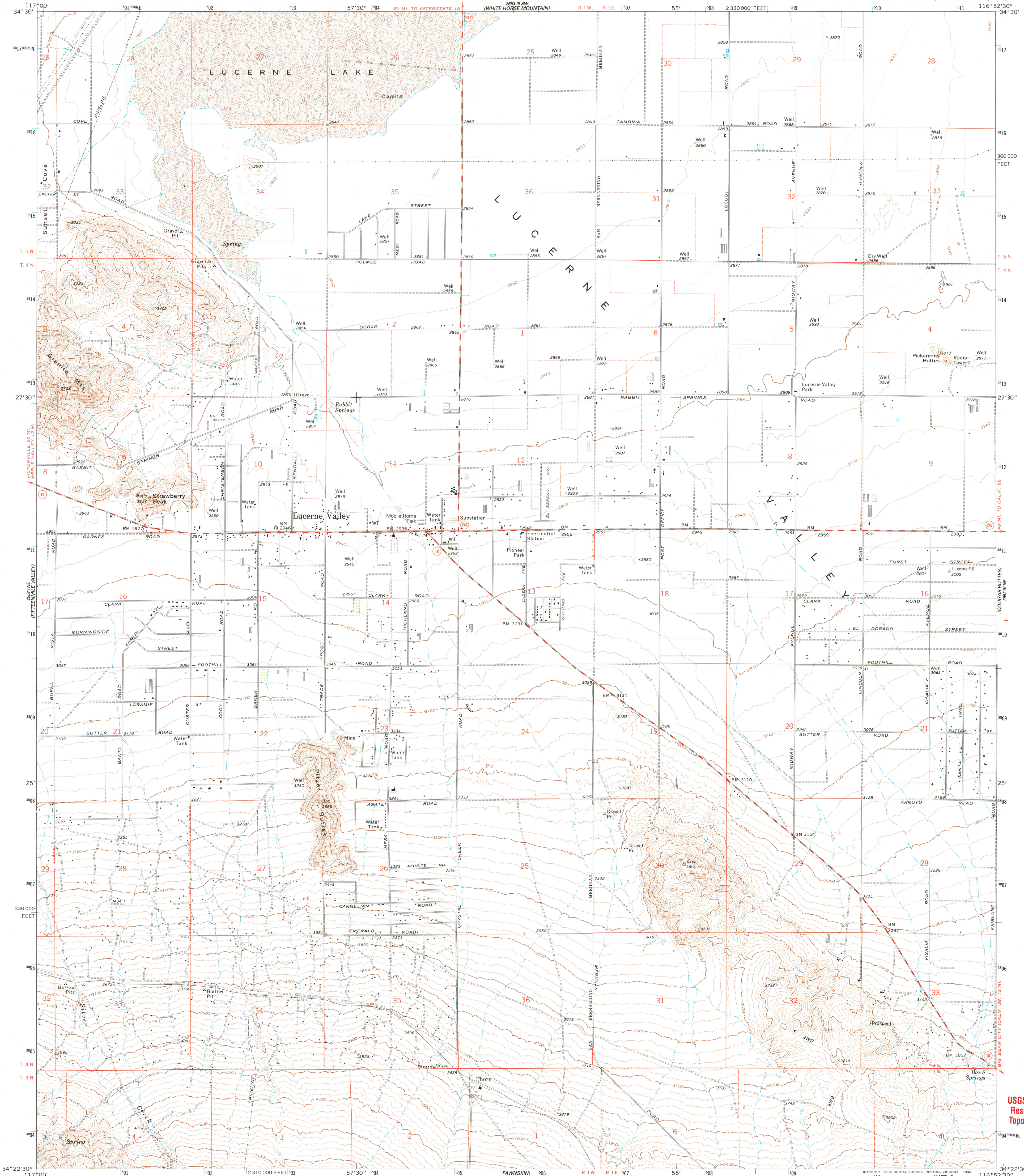

(BUTLER PEAK)  
2852 III SE

Produced by the United States Geological Survey in cooperation with California Department of Water Resources  
Control by USGS and NOS/NOAA  
Compiled from aerial photographs taken 1969. Field checked 1971  
North American Datum of 1927 (NAD 27). Projection and 10000-foot ticks: California Coordinate System, zone 5 (Lambert Conformal Conic)  
Blue 1000-meter Universal Transverse Mercator ticks, zone 11  
North American Datum of 1983 (NAD 83) is shown by dashed corner ticks. The values of the shift between NAD 27 and NAD 83 for 7.5-minute intersections are obtainable from National Geodetic Survey NADCON software  
Fine red dashed lines indicate selected fence lines  
Where omitted, land lines have not been established  
Photoinspected from 1989 source; no major culture or drainage changes observed. Names revised 1994

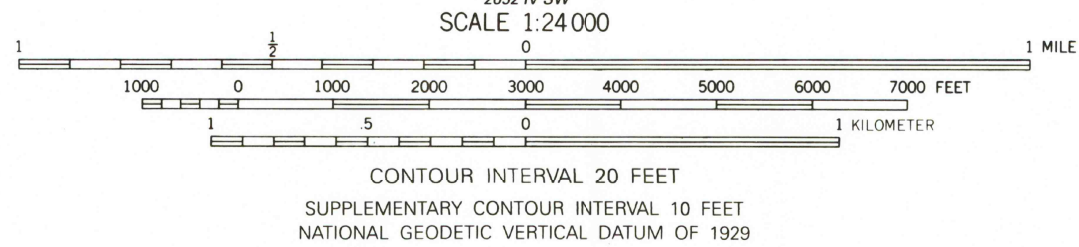
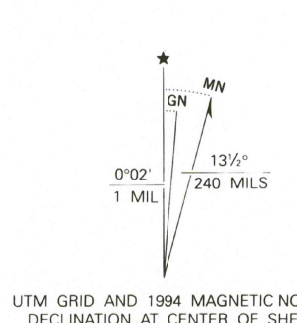

THIS MAP COMPLIES WITH NATIONAL MAP ACCURACY STANDARDS  
FOR SALE BY U. S. GEOLOGICAL SURVEY, DENVER, COLORADO 80225, OR RESTON, VIRGINIA 22092  
A FOLDER DESCRIBING TOPOGRAPHIC MAPS AND SYMBOLS IS AVAILABLE ON REQUEST



ROAD CLASSIFICATION  
Primary highway, hard surface  
Secondary highway, hard surface  
Unimproved road  
Light-duty road, hard or improved surface  
Interstate Route  
U. S. Route  
State Route

SEP 19 2006

LUCERNE VALLEY, CA  
34116-08-TF-024

1971  
MINOR REVISION 1994  
DMA 2652 IV NW-SERIES V895



USGS LIBRARY—RESTON  
3 1818 00509697 7

USGS Library  
Reston, VA.  
Topo Archive