

U. S. G. S.  
**FILE COPY**  
Imposition and Printing

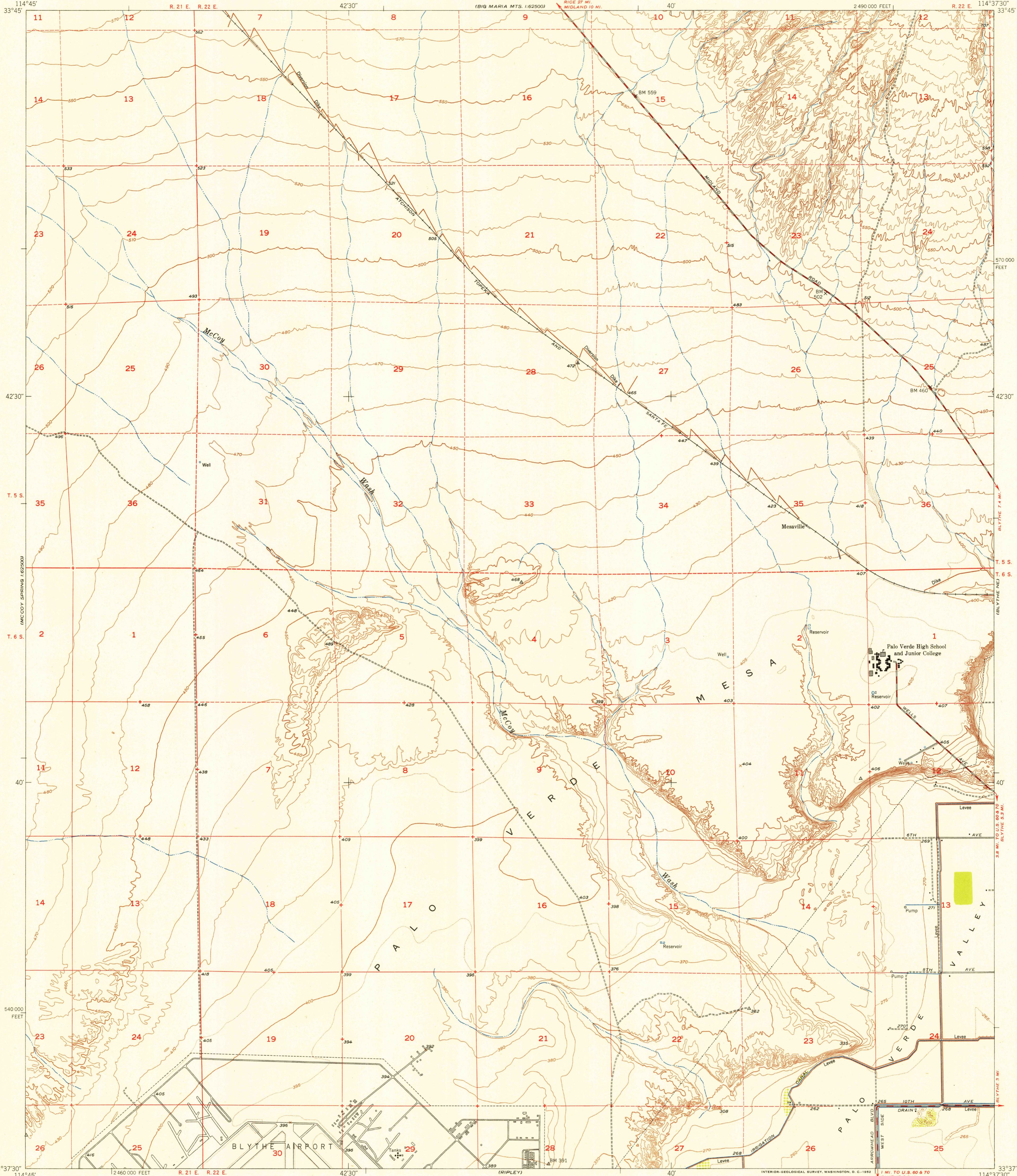

Mapped, edited, and published by the Geological Survey  
Control by USGS, USC&GS, USCE, and City of Los Angeles  
Topography by multiplex and Kelsh plotter methods  
from aerial photographs taken 1948, and from plane-table surveys  
by the City of Los Angeles 1929. Field check 1951  
Polyconic projection. 1927 North American datum  
10,000-foot grid based on California coordinate system, zone 6  
Dashed land lines indicate approximate locations

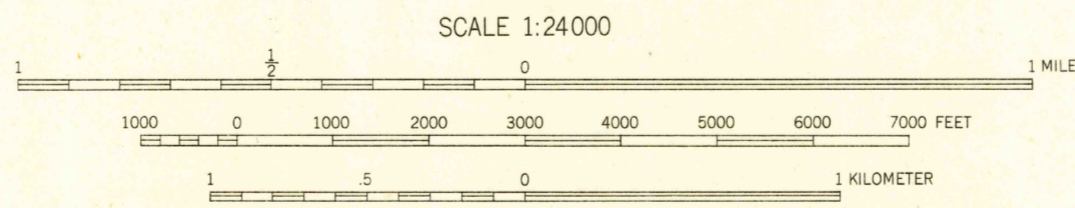
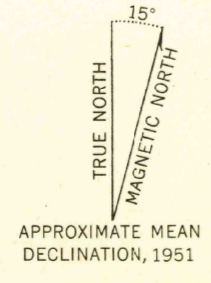

CONTOUR INTERVAL 10 FEET  
DOTTED LINES REPRESENT HALF-INTERVAL CONTOURS  
DATUM IS MEAN SEA LEVEL

THIS MAP COMPLIES WITH NATIONAL MAP ACCURACY STANDARDS  
FOR SALE BY U. S. GEOLOGICAL SURVEY, FEDERAL CENTER, DENVER, COLORADO OR WASHINGTON 25, D. C.  
A FOLDER DESCRIBING TOPOGRAPHIC MAPS AND SYMBOLS IS AVAILABLE ON REQUEST

ROAD CLASSIFICATION

Heavy-duty	4 LANE 16 LANE	Light-duty
Medium-duty	4 LANE 16 LANE	Unimproved dirt
U. S. Route		State Route

U. S. G. S.  
**FILE COPY**  
Imposition and Printing

USGS  
Historical File  
Topographic Division

MCCOY WASH. CALIF.  
NW 1/4 BLYTHE 19' QUADRANGLE  
N3337.5-W11437.5/7.5  
1951

AUG 1 1952 2005