

U.S. G.S. FILE COPY
Inspection and Editing.

92-N-11 and IV
LOS ANGELES COUNTY, CALIFORNIA
BOARD OF SUPERVISORS
HENRY W. WRIGHT, CHAIRMAN
J. E. ROCKHOLD, COUNTY SURVEYOR

Advance sheet
Subject to correction

CALIFORNIA
(LOS ANGELES COUNTY)
OBAN QUADRANGLE

DEPARTMENT OF THE INTERIOR
U. S. GEOLOGICAL SURVEY

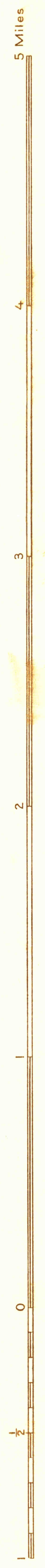
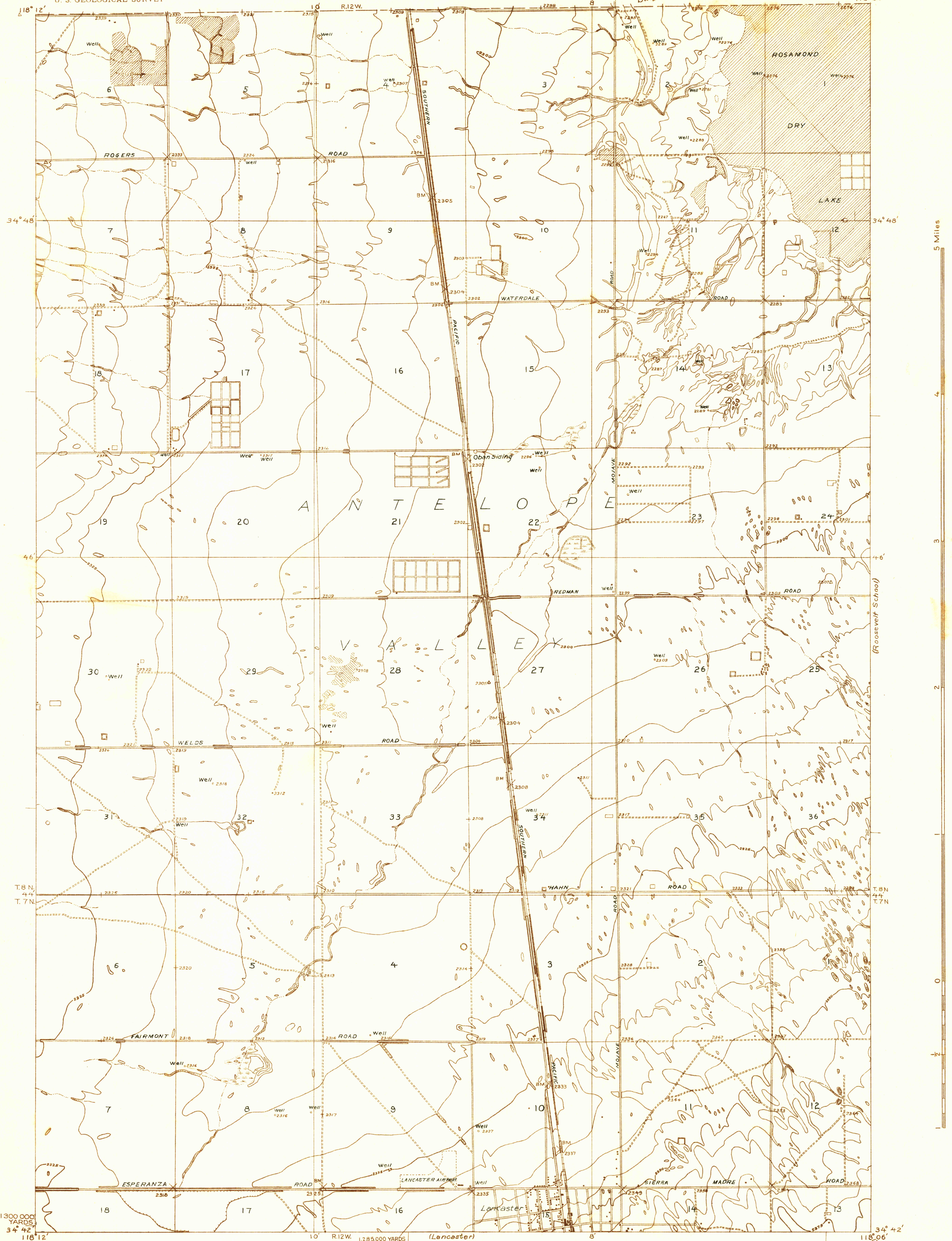

1300 000
YARDS
34° 42'
118° 12'

H. H. Hodgeson, Division Engineer
Topography by FAWuopio
Control by U. S. Geological Survey and
U. S. Coast and Geodetic Survey
Surveyed in 1930

TRUE NORTH
MAGNETIC NORTH
APPROXIMATE MEAN
DECLINATION, 1930

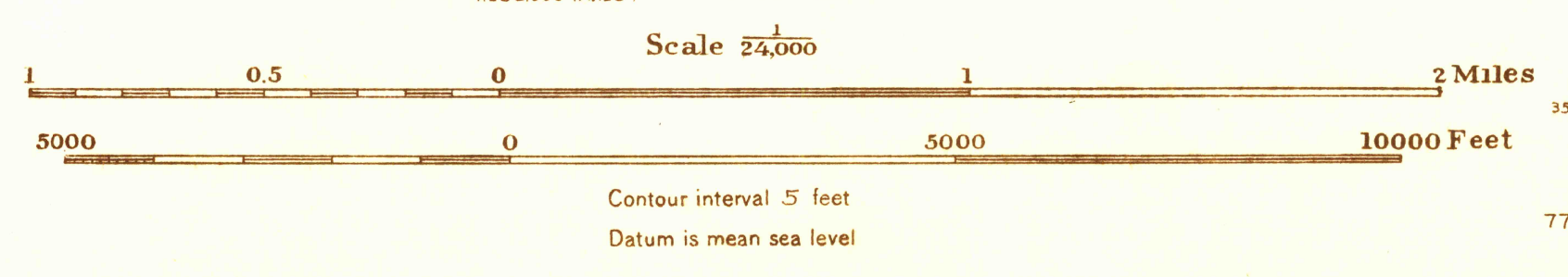

Polyconic projection, North American datum
5000 yard grid based upon U. S. zone system, G

I	II
III	IV
I	II
III	IV

USGS
Historical File
Topographic Division
OBAN, CALIF.