

DEPARTMENT OF THE INTERIOR  
U. S. GEOLOGICAL SURVEY

92-N-14-E/2  
LOS ANGELES COUNTY, CALIFORNIA  
BOARD OF SUPERVISORS  
HENRY W. WRIGHT, CHAIRMAN  
J. E. ROCKHOLD, COUNTY SURVEYOR

CALIFORNIA  
(LOS ANGELES COUNTY)  
PEARLAND QUADRANGLE

Advance sheet  
Subject to correction

(Lancaster)

(West Alpine Butte)



1280000  
32  
YARDS

T. 5 N.

34 36

H. H. Hodgeson, Division Engineer  
Topography by C. W. H. Nessler  
Control by U. S. Geological Survey  
Surveyed in 1930

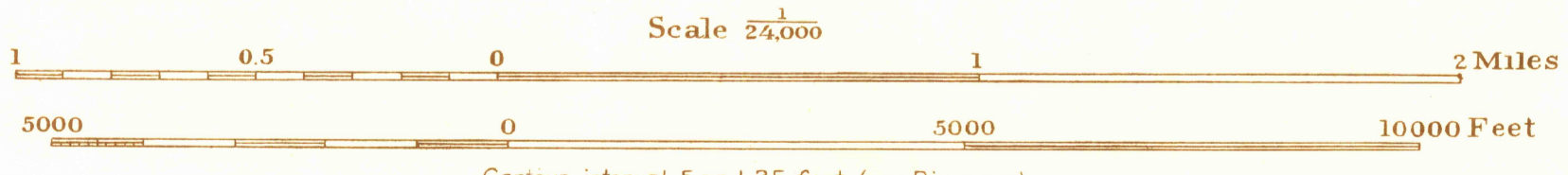

Contour interval 5 and 25 feet, (see Diagram)  
Datum is mean sea level

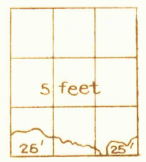

Polyconic projection, North American datum  
5000 yard grid based upon U. S. zone system G

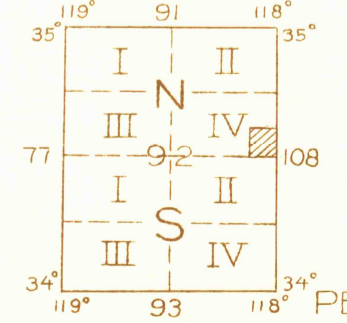

USGS  
Historical File  
Topographic Division

PEARLAND, CALIF.