

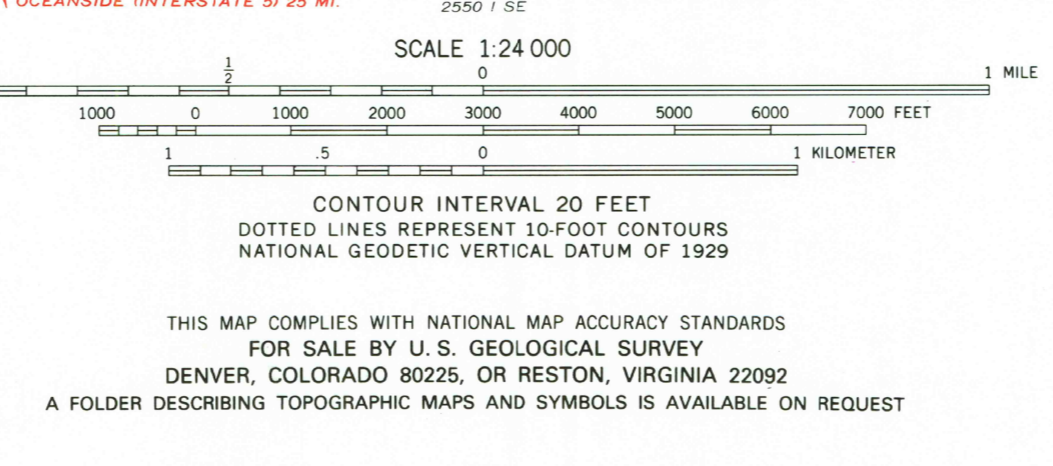

Mapped, edited, and published by the Geological Survey
Control by USGS, NOS/NOAA, and USCE
Topography by photogrammetric methods from aerial photographs
taken 1947 and plane-table surveys 1949. Revised from aerial
photographs taken 1967. Field checked 1968
Polyconic projection. 1927 North American Datum
10,000-foot grid based on California coordinate system,
zone 6
1000-meter Universal Transverse Mercator grid ticks,
zone 11, shown in blue
Fine red dashed lines indicate selected fence lines
To place on the predicted North American Datum 1983
move the projection lines 1 meter south and
81 meters east as shown by dashed corner ticks

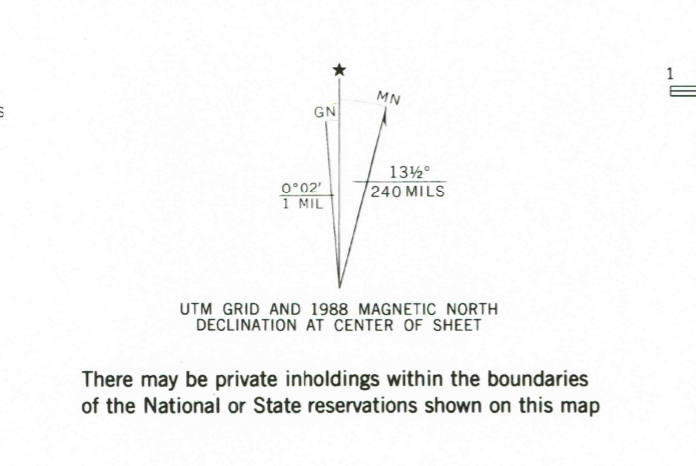

ROAD CLASSIFICATION
Medium-duty — Light-duty
Unimproved dirt — State Route

USGS NMD HISTORICAL MAP
PECHANGA, CALIF.
33117-D1-TF-024
1968
PHOTOREVISED 1988
DMA 2550 1 NE—SERIES V895

DECO 9 1988
REC'D FILE COPY

Revisions shown in purple compiled from aerial photographs
taken 1985 and other source data. Partial field check
by U.S. Forest Service. Map edited 1988

THIS MAP COMPLIES WITH NATIONAL MAP ACCURACY STANDARDS
FOR SALE BY U.S. GEOLOGICAL SURVEY
DENVER, COLORADO 80225, OR RESTON, VIRGINIA 22092
A FOLDER DESCRIBING TOPOGRAPHIC MAPS AND SYMBOLS IS AVAILABLE ON REQUEST