

Produced by the United States Geological Survey  
Control by USGS and NOS/NOAA

Compiled from aerial photographs taken 1987 and 1988 and other sources. Field checked 1990. Map edited 1994

North American Datum of 1927 (NAD 27). Projection: California Coordinate System, zone 4 (Lambert Conformal Conic) 10 000-foot ticks. California Coordinate System, zones 4 and 5 Blue 1000-meter Universal Transverse Mercator ticks, zone 10 North American Datum of 1983 (NAD 83) is shown by dashed corner ticks. The values of the shift between NAD 27 and NAD 83 for 7.5-minute intersections are obtainable from National Geodetic Survey NADCON software

Fine red dashed lines indicate selected fence and field lines where generally visible on aerial photographs. This information is uncheckd

Where omitted, land lines have not been established

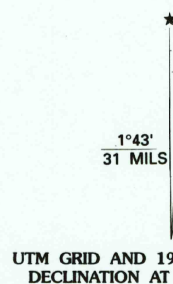

UTM GRID AND 1994 MAGNETIC NORTH DECLINATION AT CENTER OF SHEET

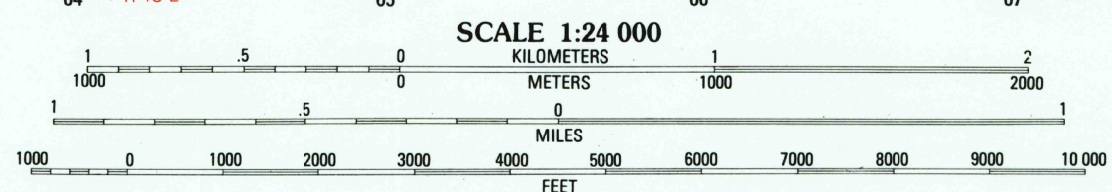

CONTOUR INTERVAL 20 FEET  
SUPPLEMENTARY CONTOUR INTERVAL 10 FEET  
NATIONAL GEODETIC VERTICAL DATUM OF 1929  
TO CONVERT FEET TO METERS MULTIPLY BY 0.3048  
TO CONVERT METERS TO FEET MULTIPLY BY 3.2808

THIS MAP COMPLIES WITH NATIONAL MAP ACCURACY STANDARDS  
FOR SALE BY U.S. GEOLOGICAL SURVEY  
DENVER, COLORADO 80225 OR RESTON, VIRGINIA 22092  
A FOLDER DESCRIBING TOPOGRAPHIC MAPS AND SYMBOLS IS AVAILABLE ON REQUEST

ROAD CLASSIFICATION  
Primary highway, hard surface . . . . .  
Secondary highway, hard surface . . . . .  
Light-duty road, hard or improved surface . . . . .  
Unimproved road . . . . .  
Interstate Route U. S. Route State Route

QUADRANGLE LOCATION

1	2	3
4	5	6
7	8	

ADJOINING 7.5' QUADRANGLE NAMES

PYRAMID HILLS, CALIF.  
35120-G1-TF-024  
1994  
DMA 1955 1 SE-SERIES V895