

U.S.G.S.  
FILE COPY  
Inspection and Editing  
TULARE 58 MI.  
FAMOSO 7.4 MI.

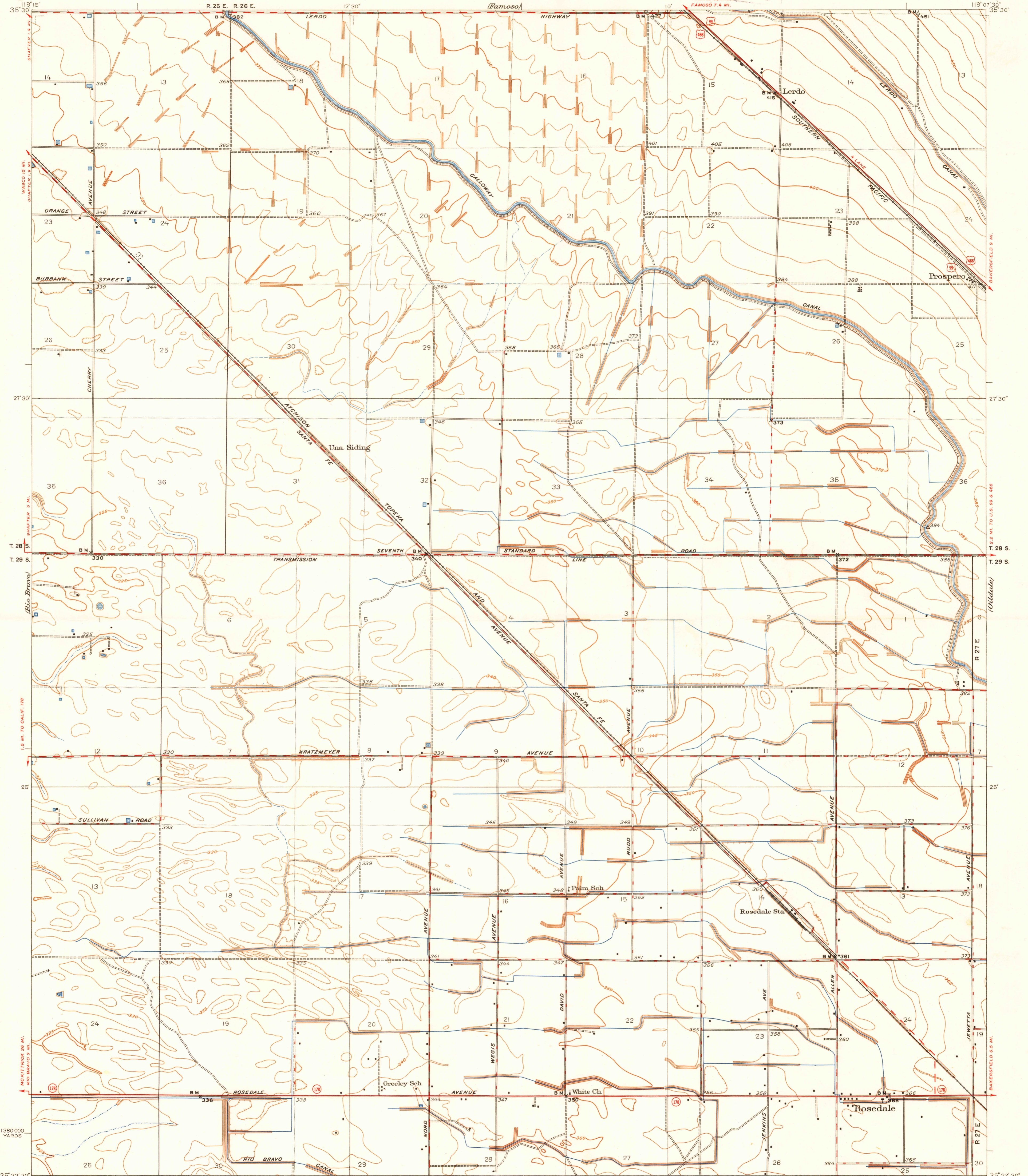

Topography by S.N. Stoner, F.A. Wuopio,  
and O.L. Wix  
Surveyed in 1929-1930

- ROAD CLASSIFICATION**
- HARD-SURFACE ALL WEATHER ROADS
  - DRY WEATHER ROADS
  - Heavy-duty **4 LANE LANE** Improved dirt
  - Medium-duty **4 LANE LANE** Unimproved dirt
  - Loose-surface, graded, or narrow hard-surface
  - U. S. Route
  - State Route

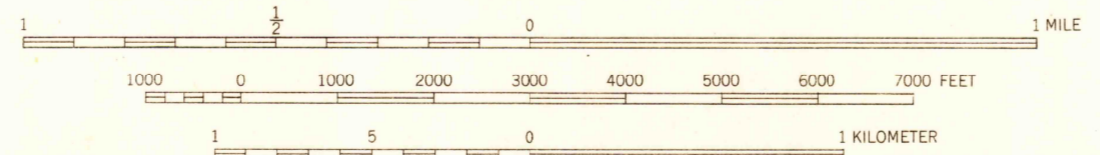
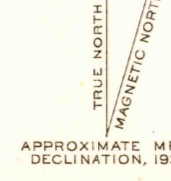

CONTOUR INTERVAL 5 FEET  
DATUM IS MEAN SEA LEVEL

FOR SALE BY U. S. GEOLOGICAL SURVEY, FEDERAL CENTER, DENVER, COLORADO, OR WASHINGTON 25, D. C.  
A FOLDER DESCRIBING TOPOGRAPHIC MAPS AND SYMBOLS IS AVAILABLE ON REQUEST

U.S.G.S.  
FILE COPY  
Inspection and Editing  
Topographic Division

Polyconic projection, 1927 North American datum  
5000 yard grid based upon U. S. zone system, G  
To join Wasco and Famoso maps  
use dotted projection corners

ROSEDALE, CALIF  
Edition of 1950.  
First published in 1933  
at scale of 1:31680  
N3522.5-W11907.5/7.5

AUG 28 1950

2110